

Application Fee: \$835.00

Application Date: April 25, 2017

Date Fee Paid: April 25, 2017

Receipt No.: \_\_\_\_\_

Received by: \_\_\_\_\_

Initials

Page 1 of 2

**TOWN OF PARADISE VALLEY  
BUILDING DEPARTMENT  
SUBDIVISION SIGN APPLICATION**

Applicant: Camelhead North HOA by Gary Edens, chairman

Applicant's Mailing Address: 6239 N 47th St, PV AZ 85253

Phone number for contact: 480.290.8654

Location of proposed sign (Cross Streets): E. Arroyo Verde Rd + N. Tatum Blvd.

Subdivision Name: Neighborhood known as Camelhead North

Size of Sign: 1'-2" x 17'-6"

Construction materials: FLO letters on existing wall. 1/2" aluminum letters  
paint Matthews DuraAnodic Bronze. Stud mounted to existing wall  
with 1/2" stand off.

Color of sign: Matthews DuraAnodic Bronze

Proposed lighting (watts): 2 20 watt low voltage lights will

shine on sign

Gary Edens

**PLEASE SIGN**

SIGN LOCATION:  
4816 E ARROYO VERDE DR

**Please provide 1 set of submittals along with this application:**

1. Description of how the proposed sign(s) will be mounted;
2. Site plan showing street names, any proposed lighting, and location of sign(s) to be installed; and;
3. Elevation of sign(s) with dimensions and total square foot.
4. Vicinity map showing street names.

Once fee(s) are paid, and all submittals are approved by the Planning Department, the item will be put on the next available Town Council Agenda for final approval.

See page 2

Application Fee: \$835.00

Application Date: April 25, 2017

Date Fee Paid: April 25, 2017

Receipt No.: \_\_\_\_\_

Received by: \_\_\_\_\_

Initials

Page 2 of 2

**TOWN OF PARADISE VALLEY  
BUILDING DEPARTMENT  
SUBDIVISION SIGN APPLICATION**

Applicant: Camelhead North HOA by Gary Edens, chairman

Applicant's Mailing Address: 6239 N. 47th St. P.O. AZ 85253

Phone number for contact: 486.296.8654

Location of proposed sign (Cross Streets): N. 46th St + E. Lincoln Dr.

Subdivision Name: Neighborhood known as Camelhead North

Size of Sign: 6'-9" x 1'-10"

Construction materials: 22 gauge naturally rusted steel panel

Color of sign: Natural rust. White letters

Proposed lighting (watts): 2 20 watt low voltage lights  
will shine on sign.

Gary Edens

**PLEASE SIGN**

SIGN LOCATION:  
4600 E PEBBLE RIDGE RD

**Please provide 1 set of submittals along with this application:**

1. Description of how the proposed sign(s) will be mounted;
2. Site plan showing street names, any proposed lighting, and location of sign(s) to be installed; and;
3. Elevation of sign(s) with dimensions and total square foot.
4. Vicinity map showing street names.

Once fee(s) are paid, and all submittals are approved by the Planning Department, the item will be put on the next available Town Council Agenda for final approval.

Mr. Paul E. Michaud, AICP  
Senior Planner  
Town of Paradise Valley  
6401 E Lincoln Drive  
Phoenix, AZ 85253

May 2, 2017

Dear Mr. Michaud:

This is to confirm that I have met with Gary Edens of the Camelhead North HOA and have seen the plans (see attached) for a Camelhead North sign that would be erected on my property at E. Lincoln Drive and N. 46th St.

I give my permission for the sign to be erected on my property.

Sincerely,

A handwritten signature in black ink, appearing to read 'Bob Kite', written over a faint circular stamp or watermark.

Bob Kite  
4600 E. Pebble Ridge Rd.  
Paradise Valley, AZ 85253  
Owner

Paul E. Michaud, AICP  
Senior Planner  
Town of Paradise Valley  
6401 E Lincoln Drive  
Phoenix, AZ 85253

May 2, 2017

Dear Mr. Michaud:

This is to confirm that I have met with Gary Edens of the Camelhead North HOA and have seen the plans (see attached) for a Camelhead North sign that would be erected on the wall on my property at Tatum and E. Arroyo Verde Drive.

I give my permission for the sign to be erected on my property.

Sincerely,

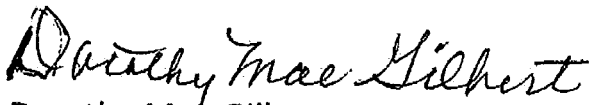

Dorothy Mae Gilbert  
4816 E. Arroyo Verde Drive  
Paradise Valley, AZ 85253  
Owner

May 12, 2017

**RE: Narrative for Community Identification Signs**

On behalf of the Camelhead North HOA, we propose to fabricate and install: one (1) flat cut out letterset reading "Camelhead North" affixed to an existing masonry wall set back from the Northwest corner of Tatum and Arroyo Verde Dr. and one (1) new three-foot gabion wall (with identical flat cut out letters) set back from the southwest corner of Lincoln and 46<sup>th</sup> street.

This project was undertaken in furtherance of the mission of the HOA, to promote the community and serve its residents. Camelhead North is a neighborhood of seventy-one (71) homes, comprised of five (5) original developments named: Villa de Cabrillo, Camelhead Estates, Camelhead Estates Unit 2, Pebble Ridge and Villa Maderos Del Cuenta. About fifteen years ago, the residents joined together to form the homeowners' association. The association is completely voluntary, with 65 of the 71 homes typically contributing modest dues to maintain the two entrances at 46th St/Lincoln and Tatum/Arroyo Verde Dr. In January 2017, a vote was held to assess the interest of the members in community identification signage. The vote was overwhelmingly in favor of signs.

The signs were designed to be consistent with the architectural elements of the community, the typeface of the Camelhead Estates sign (adjacent and South of this community) and the Town's gabion wall entry signs on Lincoln drive and Tatum Blvd. We believe the addition of these two signs will enhance the community and provide for a necessary identification/landmark function for residents and guests. Wayfinding in the area is complicated by the fact that, unlike nearby communities, there is currently no community identification signage in place. Location of the community is particularly problematic after dark. For this reason, we propose surface lighting the copy with small groundlights. The illumination sought is no brighter than the lighting now in use at Camelhead Estates. Dimmers could also be used to adjust the lighting, if needed, after installation.

We look forward to your guidance and assistance on this project. Thank you.



Nicole Bergstrom



**Manufacture and Install (1) set of FCO Letters on Existing Wall**

1/2" aluminum letters paint Matthews Duranodic Bronze  
Stud mount to existing wall with 1/2" stand-off.

- Duranodic Bronze
- White

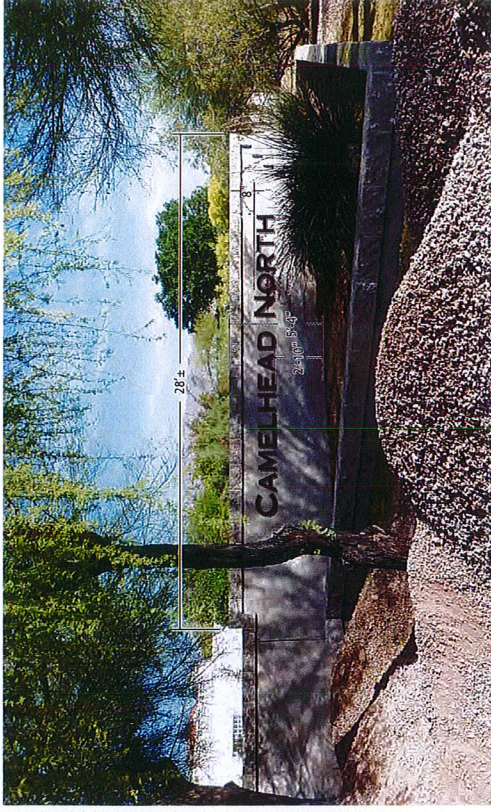

Reference photo | Elevation | Scale: nts  
Center left to right  
8" down to top of "N" from top cap

CAMELHEAD NORTH

1'-2"

17'-6"

1/2" - 1/2"

Wall FCOs | Elevation | Scale: 3/4" = 1'-0"

Side View | Scale: 3/4" = 1'-0"

Fabrication information shown here is for informational purposes only. Smithcraft and its employees do not warrant, and may not be used for fabrication by any other company without authorization from an officer of F & N.

3643 South 7th Street  
Phoenix, AZ 85040.1130  
602.268.1349 Office  
602.268.1369 Facsimile



SPEC. NO.  
DF12569  
JOB NO.  
0X-000000

REP.: D. Felker  
BY: K. Alvarado  
DATE: 3/10/16  
REV.: 3/24/16, 4/24/17

**Camelhead North**  
Entry (Neighborhood) Signage  
Install Address: Paradise Valley, AZ

SIGN TYPE  
ENTRY  
SIGNAGE

SHEET  
1.0

# Map



Manufacture and Install (1) 5'F entry sign per design

Gabion Wall

22 Gauge naturally rusted steel panel  
8" White letters

Natural Rust

White

Sample gabion wall-  
rock type 1bd



Reference photo | Elevation | Scale: nts

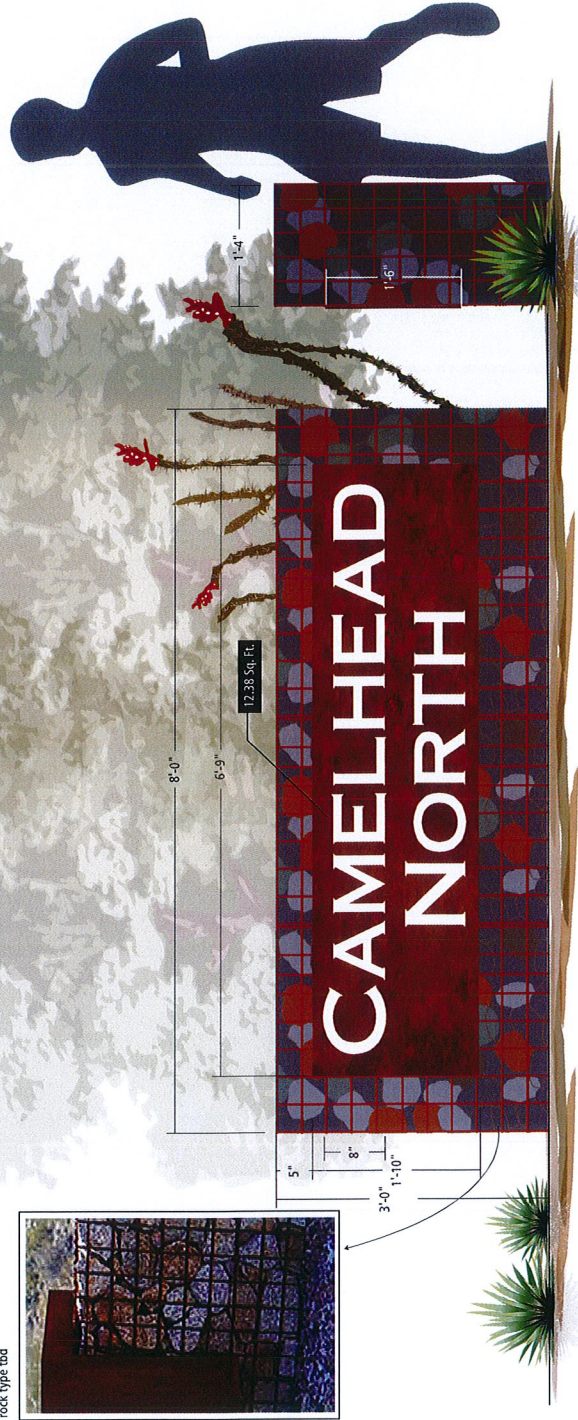

Side View | Scale: 3/4" = 1'-0"

Gabion wall entry sign | Elevation | Scale: 3/4" = 1'-0"

Fabrication information shown here is  
the exclusive property of F & N.  
It is not to be used for fabrication by any  
other company without authorization  
from an officer of F & N.

REP.: D. Felker  
BY: K. Alvarado  
DATE: 3/10/16  
REV: 3/24/16, 4/24/17

SPEC. NO.  
DF12569  
JOB NO.  
OX-000000

**Camelhead North  
Entry (Neighborhood) Signage**  
Install Address: Paradise Valley, AZ

SIGN TYPE  
ENTRY  
SIGNAGE

SHEET  
2.0

**Smithcraft**  
CUSTOM SIGNS & GRAPHICS

3643 South 7th Street  
Phoenix, AZ 85040.1130  
602.268.1349 Office  
602.268.1369 Facsimile





# LINCOLN DRIVE

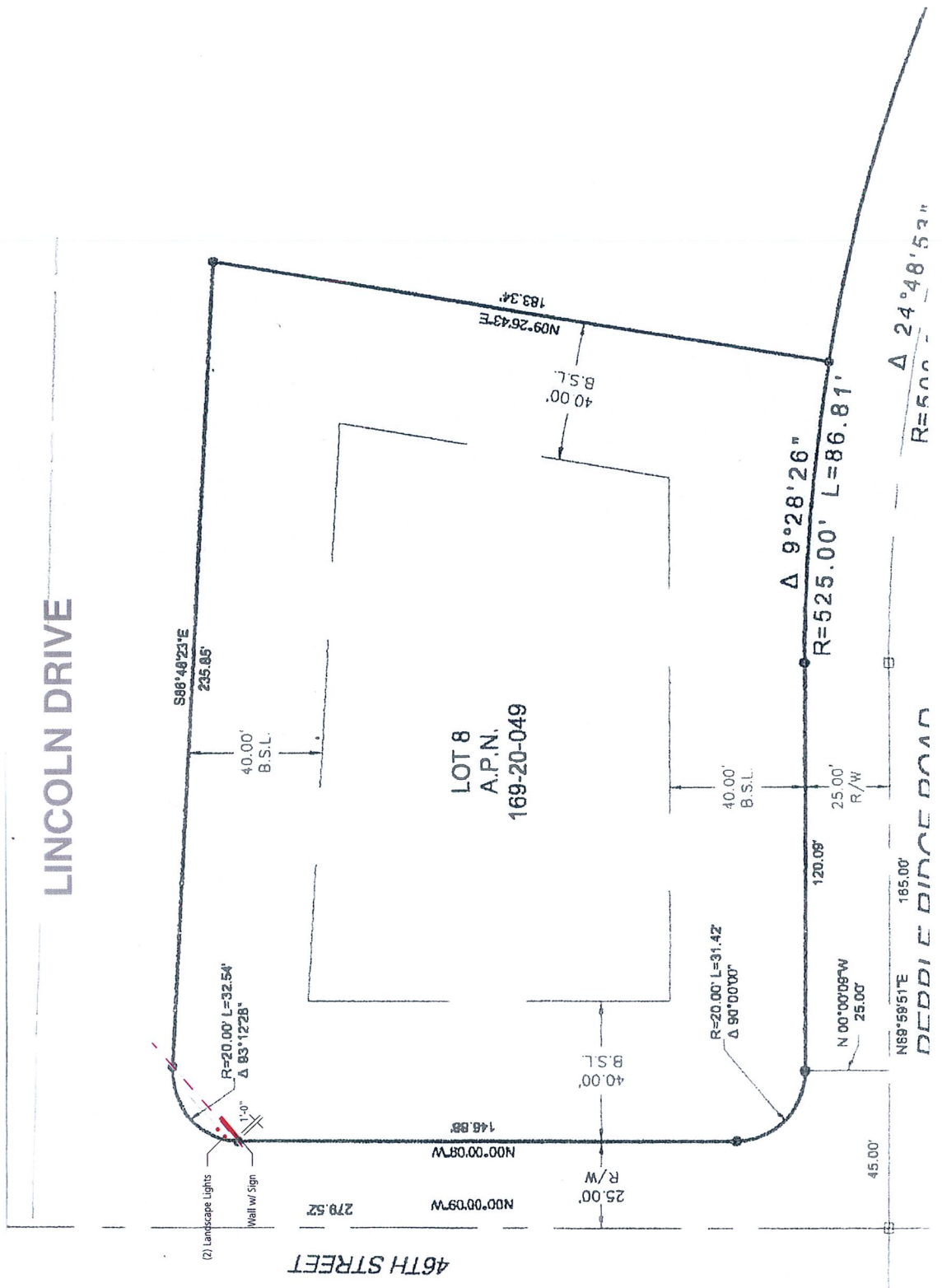

SHEET  
**2.1**

SIGN TYPE  
ENTRY  
SIGNAGE

Camelhead North  
Entry (Neighborhood) Signage  
Install Address: Paradise Valley, AZ

SPEC. NO.  
DF12569  
JOB NO.  
OX-000000

REP: D. Falter  
BY: K. Alvarado  
DATE: 3/10/16  
REV: 3/24/16, 4/24/17

Fabrication information shown here is  
for informational purposes only and may  
not be used for fabrication by any  
other company without authorization  
from an officer of S.N.

3643 South 7th Street  
Phoenix, AZ 85040.1130  
602.268.1349 Office  
602.268.1369 Facsimile



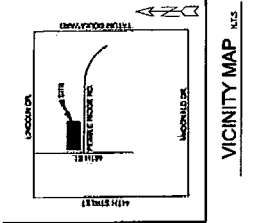

**SURVEYORS NOTES**  
 1. MONUMENTS FOUND DURING THIS FIELD SURVEY WERE ACCEPTED UNLESS OTHERWISE NOTED HEREIN.  
 2. THIS SURVEY WAS CONDUCTED WITHOUT THE BENEFIT OF A TITLE REPORT.  
 3. THE LOCATIONS OF UNCONVEYED UTILITIES AS SHOWN HEREON ARE BASED ON BLUE STAKE.  
 4. DATES OF FIELD WORK: 2007  
 5. ALL BUILDINGS, SURFACE AND SUBSURFACE IMPROVEMENTS ON AND ADJACENT TO THIS SUBJECT PARCEL, ARE NOT NECESSARILY SHOWN, OR CONSIDERED AS A PART OF THIS SURVEY. NO STATEMENT IS MADE AS TO THE EXISTENCE OR NON-EXISTENCE OF UTILITIES AND/OR CONVEYED OR UNCONVEYED UTILITIES WHICH MAY AFFECT THE USE OR DEVELOPMENT OF THIS TRACT.  
 6. THE COMPLETE EXTENT OF DRAINAGE AREAS WHICH PLACE SURFACE WATER RUNOFF ONTO THIS SITE ARE NOT SHOWN. DOWNSTREAM DRAINAGE AREAS WHICH COULD BE AFFECTED BY STORM WATER RUNOFF FROM THIS SITE WERE NOT INVESTIGATED OR SHOWN. OWNERS/DESIGNERS SHOULD CONSIDER THE EFFECTS OF STORM WATER RUNOFF ONTO THIS SITE AND ADJACENT SITES.  
 7. SINCE THE DATE OF THIS SURVEY, CONDITIONS BEYOND THE KNOWLEDGE OR CONTROL OF MILLER & SONS SURVEYING, LLC MAY HAVE ALTERED THE VALIDITY AND CIRCUMSTANCES SHOWN OR NOTED HEREON.



**LAND SURVEYORS CERTIFICATION**  
 I, THE UNDERSIGNED, PAUL H. MILLER, A LICENSED LAND SURVEYOR UNDER THE PROFESSIONAL LAND SURVEYING ACT OF MARCH 2012, HAVE MADE UNDER MY DIRECTION DURING THE MONTH OF MARCH 2012, THAT THE SURVEY IS TRUE AND COMPLETE AS SHOWN, THAT THE MONUMENTS SHOWN ACTUALLY EXIST, THAT THE MEASUREMENTS WERE MADE CORRECTLY, AND THAT SAID MONUMENTS ARE SUFFICIENT TO ENABLE THE SURVEY TO BE RE-TRACED.

**OWNER**  
 ROBERT H. KITE  
 PROPERTY ADDRESS  
 4800 E PEBBLE RIDGE ROAD  
 PARADISE VALLEY, AZ 85251  
 MAILING ADDRESS  
 4800 E PEBBLE RIDGE ROAD  
 PARADISE VALLEY, AZ 85251

**SYMBOL LEGEND**  
 [Symbol] BOUNDARY BY INSTRUMENT  
 [Symbol] BOUNDARY BY TITLE  
 [Symbol] EAST-TYPED BOUNDARY BY INSTRUMENT  
 [Symbol] BOUNDARY FOUND ON SITE

**LEGEND**  
 RW: ROAD OF RIGHT  
 RL: REGISTERED LAND BOUNDARY  
 R.L.: BUILDING RETRACTION LINE

**LINETYPE LEGEND**  
 --- MEAN CENTERLINE  
 --- MONUMENT LINE  
 --- BUILDING RETRACTION LINE

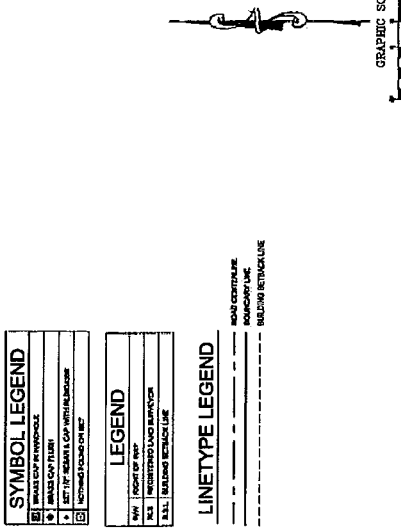

**OWNER**  
 ROBERT H. KITE  
 PROPERTY ADDRESS  
 4800 E PEBBLE RIDGE ROAD  
 PARADISE VALLEY, AZ 85251  
 MAILING ADDRESS  
 4800 E PEBBLE RIDGE ROAD  
 PARADISE VALLEY, AZ 85251

**BASIS OF BEARING**  
 THIS INSTRUMENT IS BASED UPON THE  
 BEARING AND DISTANCE OF THE  
 48TH STREET

**AREA**  
 4.80 ACRES  
 MORE OR LESS

**LEGAL DESCRIPTION**  
 LOTS 8 AND 9, PARCEL 1889-200-049, IN THE  
 OFFICE OF THE COUNTY RECORDER OF MARICOPA COUNTY, ARIZONA.

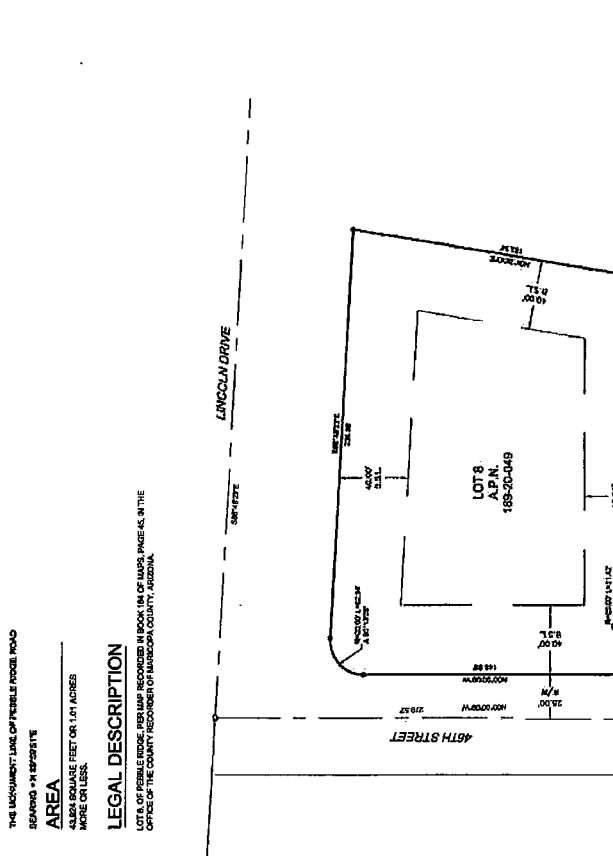

**OWNER**  
 ROBERT H. KITE  
 PROPERTY ADDRESS  
 4800 E PEBBLE RIDGE ROAD  
 PARADISE VALLEY, AZ 85251  
 MAILING ADDRESS  
 4800 E PEBBLE RIDGE ROAD  
 PARADISE VALLEY, AZ 85251

**BASIS OF BEARING**  
 THIS INSTRUMENT IS BASED UPON THE  
 BEARING AND DISTANCE OF THE  
 48TH STREET

**AREA**  
 4.80 ACRES  
 MORE OR LESS

**LEGAL DESCRIPTION**  
 LOTS 8 AND 9, PARCEL 1889-200-049, IN THE  
 OFFICE OF THE COUNTY RECORDER OF MARICOPA COUNTY, ARIZONA.





**CAMELBACK CANYON  
ESTATES**





landscape • entertainment • architectural • hospitality • illumination

# DL-15 DIRECTIONAL LIGHTS



25301 COMMERCENTRE DRIVE • LAKE FOREST, CA 92630 • 949.830.1350 • 888.882.1350 • FAX 949.830.3390



# DIRECTIONAL LIGHTS DL-15 SERIES



TYPE

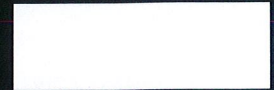

## SPECIFICATIONS

**CONSTRUCTION:** Cast aluminum, cast brass or composite flood; matching cast aluminum, brass or composite adjustable swivel

**REFLECTOR:** Diamond embossed specular aluminum

**LENS:** High impact clear acrylic

**LAMP SUPPLIED DL-15-H:** 35 watt Halogen D.C. - 10,000 hours average rating (75w max.)

**LAMP SUPPLIED DL-15-SC:** 18 watt S8 #1141 S.C. - 1200 hours average rating (25w max.)

**LAMP OPTIONS DL-15-SC:** We recommend 10,000 hours average rating Xenon (-X) or Halogen (-H) or 3w 50,000 hours average rating OMNI-3 LED (-LED3)

**SOCKET:** Double contact bayonet base (Ba15d) or Single contact bayonet base (Ba15s).

Both with brass nickel plated lamp socket screw shell and 200°C silicone lead wires

**WIRING:** Black 3 foot 18/2 zip cord from base of fixture (12v only)

For 25 foot 16/2 fixture lead wire add -25F to catalog number.

**CONNECTION:** FA-05 Quick Connector (not supplied) from fixture to main cable (12/2, 10/2 or 8/2 only) 12v only

**MOUNTING:** FA-03 black 9" ABS stake threaded 1/2" NPS

**FINISH:** Aluminum-Black texture polyester powder coat. Optional finishes available. Brass-Unfinished brass. Optional finishes available.



**DL-15-SC-BRT**  
mounted on  
FA-25-BRT

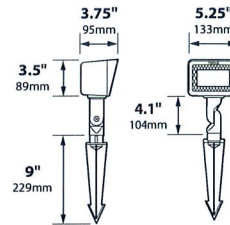

## ORDERING INFORMATION

CATALOG NO.	DESCRIPTION	LAMP	EST. SHIP WEIGHT
DL-15-H-BLT	Aluminum floodlight	35w T4 D.C. Halogen	2.0 lbs.
DL-15-H-BRS	Brass floodlight	35w T4 D.C. Halogen	3.0 lbs.
CDL-15-H-BLT	Composite floodlight	35w T4 D.C. Halogen	2.0 lbs.
DL-15-SC-BLT	Aluminum floodlight	18w S8 #1141	2.0 lbs.
DL-15-SC-BRS	Brass floodlight	18w S8 #1141	3.0 lbs.
CDL-15-SC-BLT	Composite floodlight	18w S8 #1141	2.0 lbs.

## MOUNTING ACCESSORIES

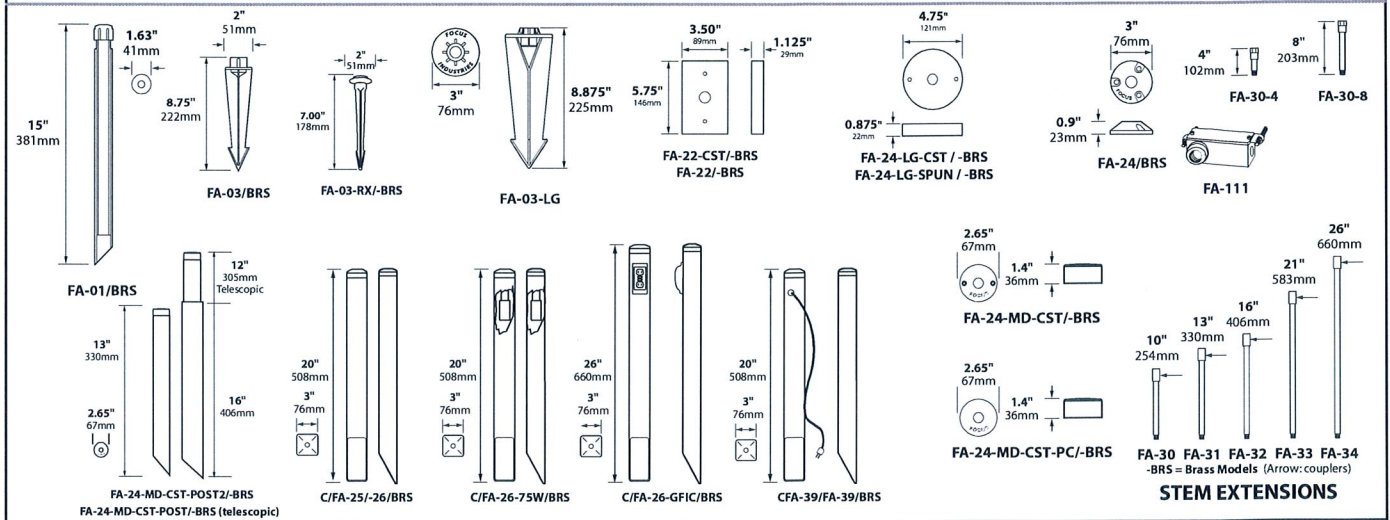

## BEAM/GLARE CONTROL

FA-07-15	Square 1/4" Hex Cell Louver
FA-10-15BLUE	Blue Tempered Glass Lens
FA-10-15GREEN	Green Tempered Glass Lens

## JOB INFORMATION

Type: \_\_\_\_\_ Date: \_\_\_\_\_

Job Name: \_\_\_\_\_

Cat. No.: \_\_\_\_\_

Lamp(s): \_\_\_\_\_

Specifier: \_\_\_\_\_

Contractor: \_\_\_\_\_

Notes: \_\_\_\_\_

FOCUS INDUSTRIES INC.  
25301 COMMERCENTRE DRIVE  
LAKE FOREST, CA 92630

www.focusindustries.com  
sales@focusindustries.com  
(949) 830-1350 • FAX (949) 830-3390

Black Texture (Standard)	Antique Verde	Bronze Texture	Camel	White Texture	Hunter Texture	Rust	Weathered Iron	Weathered Brown	Stucco	Rubbed Verde	Chrome Powder	Acid Rust	Acid Verde	Black Acid Treatment
-BLT	-ATV	-BRT	-CAM	-WTX	-HTX	-RST	-WIR	-WBR	-STU	-RBV	-CPR	-BAR/CAR	-BAV/CAV	-BAT





# DIRECTIONAL LIGHTS DL-15 SERIES



TYPE

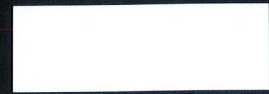

## PHOTOMETRICS

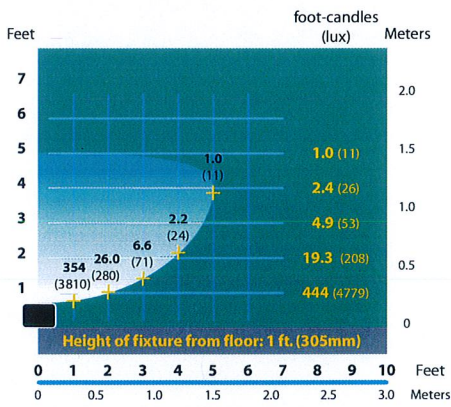

**DL-15-H**  
Half Spread Photometrics

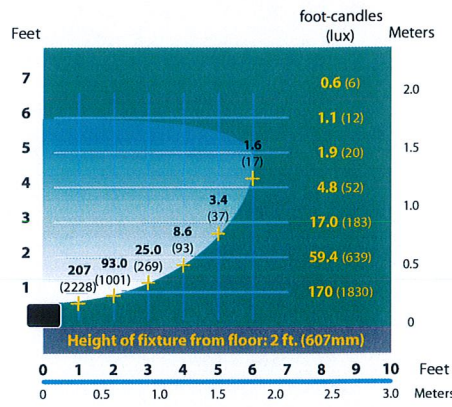

**DL-15-H**  
Half Spread Photometrics

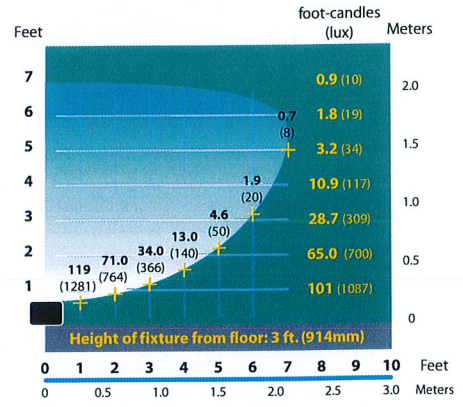

**DL-15-H**  
Half Spread Photometrics

Black Texture (Standard)	Antique Verde	Bronze Texture	Camel	White Texture	Hunter Texture	Rust	Weathered Iron	Weathered Brown	Stucco	Rubbed Verde	Chrome Powder	Acid Rust	Acid Verde	Black Acid Treatment
-BLT	-ATV	-BRT	-CAM	-WTX	-HTX	-RST	-WIR	-WBR	-STU	-RBV	-CPR	-BAR/CAR	-BAV/CAV	-BAT



landscape • entertainment • architectural • hospitality • illumination

# DL-15-LEDP DIRECTIONAL LIGHTS

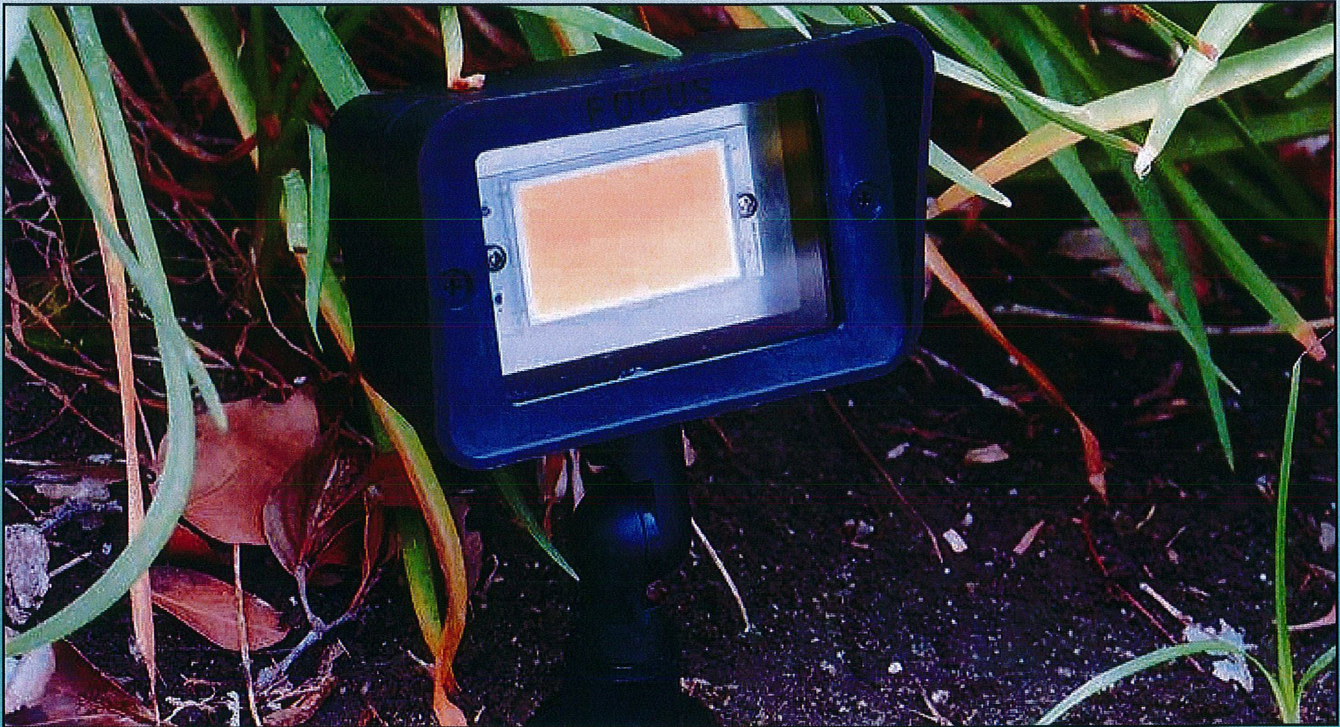

25301 COMMERCENTRE DRIVE • LAKE FOREST, CA 92630 • 949.830.1350 • 888.882.1350 • FAX 949.830.3390



# DIRECTIONAL LIGHTS DL-15-LEDP4 SERIES

TYPE

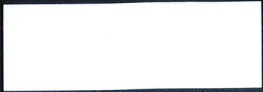

## SPECIFICATIONS

**CONSTRUCTION:** Cast aluminum, cast brass or composite flood; matching cast aluminum, brass or composite adjustable swivel

**LENS:** High impact clear acrylic

**LIGHT SOURCE:** 4w integrated LED flat panel, warm white 3000K

**LIFETIME RATING:** 50,000 hours

**SOCKET:** None

**12V INTERNAL DRIVER:** 5w 350mA output, 12v AC input. Voltage range of 9 to 18 volts with optimum operating range of 10 to 15 volts for consistent performance and brightness. For use with magnetic transformers only.

**WIRING 12v:** Black 3 foot 18/2 zip cord from base of fixture (12v only)  
For 25 foot 16/2 fixture lead wire add -25F to catalog number.

**MOUNTING 12v:** FA-03 black 9" ABS stake, tapped 1/2" NPS

**FINISH:** Aluminum - Black texture polyester powder coat. Optional finishes available.  
Brass - Unfinished brass. Optional finishes available.

Composite - Black, Bronze or Rubbed Verde

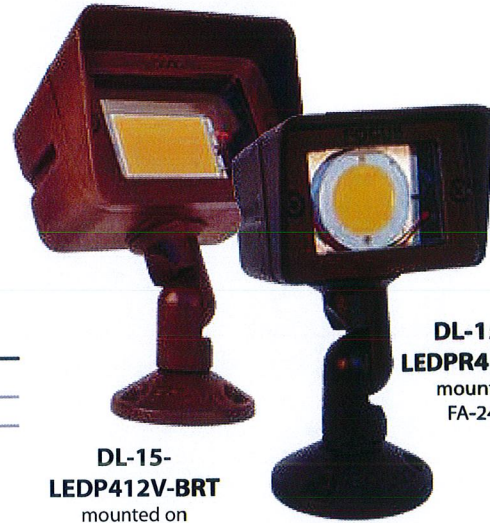

**DL-15-LEDP412V-BRT**  
mounted on  
FA-24-BRT

**DL-15SM-LEDPR412V-BLT**  
mounted on  
FA-24-BLT

## ORDERING INFORMATION

CATALOG NO.	DESCRIPTION	LAMP	EST. SHIP WEIGHT
DL-15-LEDP412V-BLT	12v Aluminum floodlight	4w LED Panel	2.0 lbs.
DL-15-LEDP412V-BRS	12v Brass floodlight	4w LED Panel	3.0 lbs.
CDL-15-LEDP412V-BLT	12v Composite floodlight	4w LED Panel	2.0 lbs.
DL-15SM-LEDPR412V-BLT	12v Aluminum floodlight	4w LED Panel	2.0 lbs.
DL-15SM-LEDPR412V-BRS	12v Brass floodlight	4w LED Panel	3.0 lbs.

IP65

CE

ETL Intertek

## MOUNTING ACCESSORIES

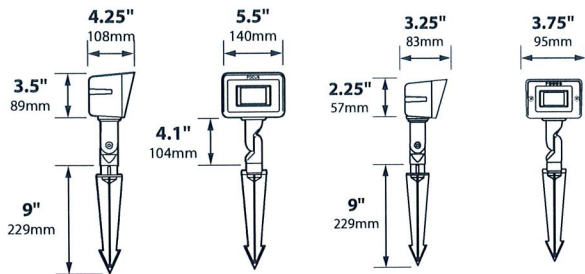
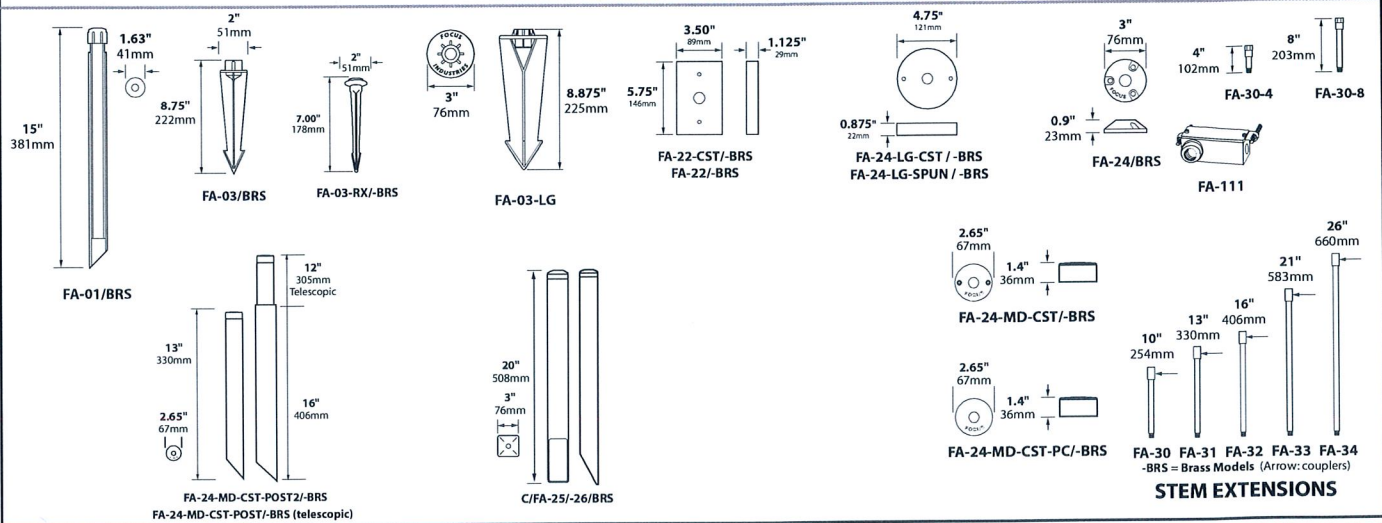

**DL-15-LEDP**

**DL-15-SM-LEDP**

## JOB INFORMATION

Type: \_\_\_\_\_ Date: \_\_\_\_\_

Job Name: \_\_\_\_\_

Cat. No: \_\_\_\_\_

Lamp(s): \_\_\_\_\_

Specifier: \_\_\_\_\_

Contractor: \_\_\_\_\_

Notes: \_\_\_\_\_

FOCUS INDUSTRIES INC.  
25301 COMMERCENTRE DRIVE  
LAKE FOREST, CA 92630

www.focusindustries.com  
sales@focusindustries.com  
(949) 830-1350 • FAX (949) 830-3390

Black Texture (Standard)	Antique Verde	Bronze Texture	Camel	White Texture	Hunter Texture	Rust	Weathered Iron	Weathered Brown	Stucco	Rubbed Verde	Chrome Powder	Acid Rust	Acid Verde	Black Acid Treatment
-BLT	-ATV	-BRT	-CAM	-WTX	-HTX	-RST	-WIR	-WBR	-STU	-RBV	-CPR	-BAR/CAR	-BAV/CAV	-BAT

**LIGHT DISTRIBUTION**

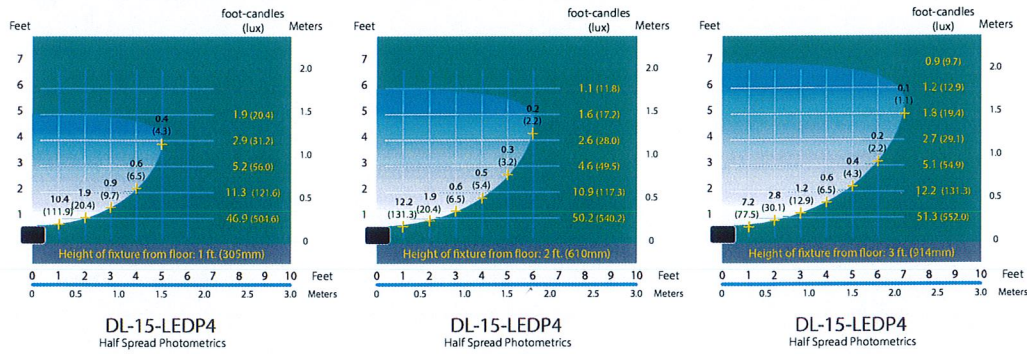

**BEAM/GLARE CONTROL**

- FA-07-15/-SM Square 1/4" Hex Cell Louver
- FA-10-15/-SMBLUE Blue Tempered Glass Lens
- FA-10-15/-SMGREEN Green Tempered Glass Lens