

Paul Michaud

From: Jim Shano
Sent: Tuesday, June 21, 2016 7:55 AM
To: Paul Michaud; Peter Wingert
Subject: RE: Monument sign for Valley Presbyterian Church

I am good.

James P. Shano, P.E., C.P.M.
Public Works Director / Town Engineer
Assistant to the Town Manager for Strategic Planning
Town of Paradise Valley
6401 East Lincoln Drive
Paradise Valley, Arizona 85253-4328
Phone: 480-348-3573
jshano@paradisevalleyaz.gov

From: Paul Michaud
Sent: Monday, June 20, 2016 3:58 PM
To: Jim Shano <JShano@paradisevalleyaz.gov>; Peter Wingert <pwingert@paradisevalleyaz.gov>
Subject: RE: Monument sign for Valley Presbyterian Church

Jim/Peter:

I would appreciate an e-mail back that you are both agreeable to the corner vision documentation submitted by the applicant for me to include in my next packet.

Paul

From: Jim Shano
Sent: Thursday, June 16, 2016 1:34 PM
To: Peter Wingert; Paul Michaud
Subject: FW: Monument sign for Valley Presbyterian Church

Hello Pete,

See email below and attachments.

Hello Paul,

I think we should talk about this at the next development team meetings.

Thanks Jim S.

James P. Shano, P.E., C.P.M.
Public Works Director / Town Engineer
Assistant to the Town Manager for Strategic Planning
Town of Paradise Valley
6401 East Lincoln Drive
Paradise Valley, Arizona 85253-4328
Phone: 480-348-3573

Paul Michaud

From: Peter Wingert
Sent: Monday, June 20, 2016 5:05 PM
To: Paul Michaud
Subject: RE: Monument sign for Valley Presbyterian Church

Paul,

The monument sign is fine.

Best regards,

Peter Wingert
Chief of Police
Paradise Valley Police Department
6433 E. Lincoln Dr.
Paradise Valley, AZ 85253
pwingert@paradisevalleyaz.gov
(480)948-7418

From: Paul Michaud
Sent: Monday, June 20, 2016 3:58 PM
To: Jim Shano; Peter Wingert
Subject: RE: Monument sign for Valley Presbyterian Church

Jim/Peter:

I would appreciate an e-mail back that you are both agreeable to the corner vision documentation submitted by the applicant for me to include in my next packet.

Paul

From: Jim Shano
Sent: Thursday, June 16, 2016 1:34 PM
To: Peter Wingert; Paul Michaud
Subject: FW: Monument sign for Valley Presbyterian Church

Hello Pete,

See email below and attachments.

Hello Paul,

I think we should talk about this at the next development team meetings.

Thanks Jim S.

James P. Shano, P.E., C.P.M.
Public Works Director / Town Engineer

Assistant to the Town Manager for Strategic Planning
Town of Paradise Valley
6401 East Lincoln Drive
Paradise Valley, Arizona 85253-4328
Phone: 480-348-3573
jshano@paradisevalleyaz.gov

From: Stuart Rayburn [<mailto:stu@rccdesigngroup.com>]
Sent: Monday, June 13, 2016 1:40 PM
To: Jim Shano <JShano@paradisevalleyaz.gov>; Paul Michaud <pmichaud@paradisevalleyaz.gov>
Cc: brandonf@vpc.church
Subject: Monument sign for Valley Presbyterian Church

Mr. Shano,
Attached is a memo and 2 exhibits regarding the site distance provided for the Valley Presbyterian church as it relates to the proposed monument sign. Please let me know if you have any questions or need further information. Thanks for your assistance with this matter.

Stuart W. Rayburn, PE
Principal
RCC Design Group, LLC
480-598-0270
480-993-6425 (c)

Stuart W. Rayburn, PE
Principal
RCC Design Group, LLC
480-598-0270
480-993-6425 (c)



"...WHATEVER IT TAKES!"

MEMORANDUM

To: James Shano, P.E., Town Engineering/Town of Paradise Valley

From: Stuart W. Rayburn, P.E., Principal
RCC Design Group, LLC

Date: 06/13/16

RE: Valley Presbyterian Monument sign site visibility

Mr. Shano,

I have been contracted by Valley Presbyterian to evaluate the site visibility related to the proposed monument sign on E. McDonald Drive. The issue is not the sight visibility from the private driveway to vehicles on E. McDonald Drive, but rather from the driveway to the sidewalk that extends east of the driveway. The concern is for the safety of bicyclists who might be traveling on the sidewalk headed west bound. Attached are two exhibits that demonstrate the sight distance provided from the perspective of someone on the sidewalk looking toward the driveway and a driver in a vehicle in the driveway looking toward the sidewalk.

Exhibit A shows that someone on the sidewalk has a line of site of 70' to a vehicle located in the driveway. It is reasonable to assume that a cyclist on the sidewalk would not be traveling more than 15' MPH on a meandering sidewalk. The 70' sight distance meets the minimum recommended site distance from AASHTO for uncontrolled intersections at 15 MPH. Exhibit B shows that a driver in a vehicle in the driveway has a line of site of 82' to a cyclist on the sidewalk, also exceeding the recommended minimum from AASHTO.

I am recommending that a stop sign be placed on the site just south of the sidewalk to direct vehicles to stop at this location before pulling all the way up to McDonald Drive to exit the site. It should also be noted that at present the sidewalk does not continue beyond the driveway to the west.

Based on the design plans for that monument sign and the existing conditions at the site, I believe the site distance of 70' or greater provided is sufficient to provide a safe environment after the installation of the proposed monument sign. Please contact me if you have additional questions or need further information.



Expires 12/31/16

E. McDONALD DR.

NORTH

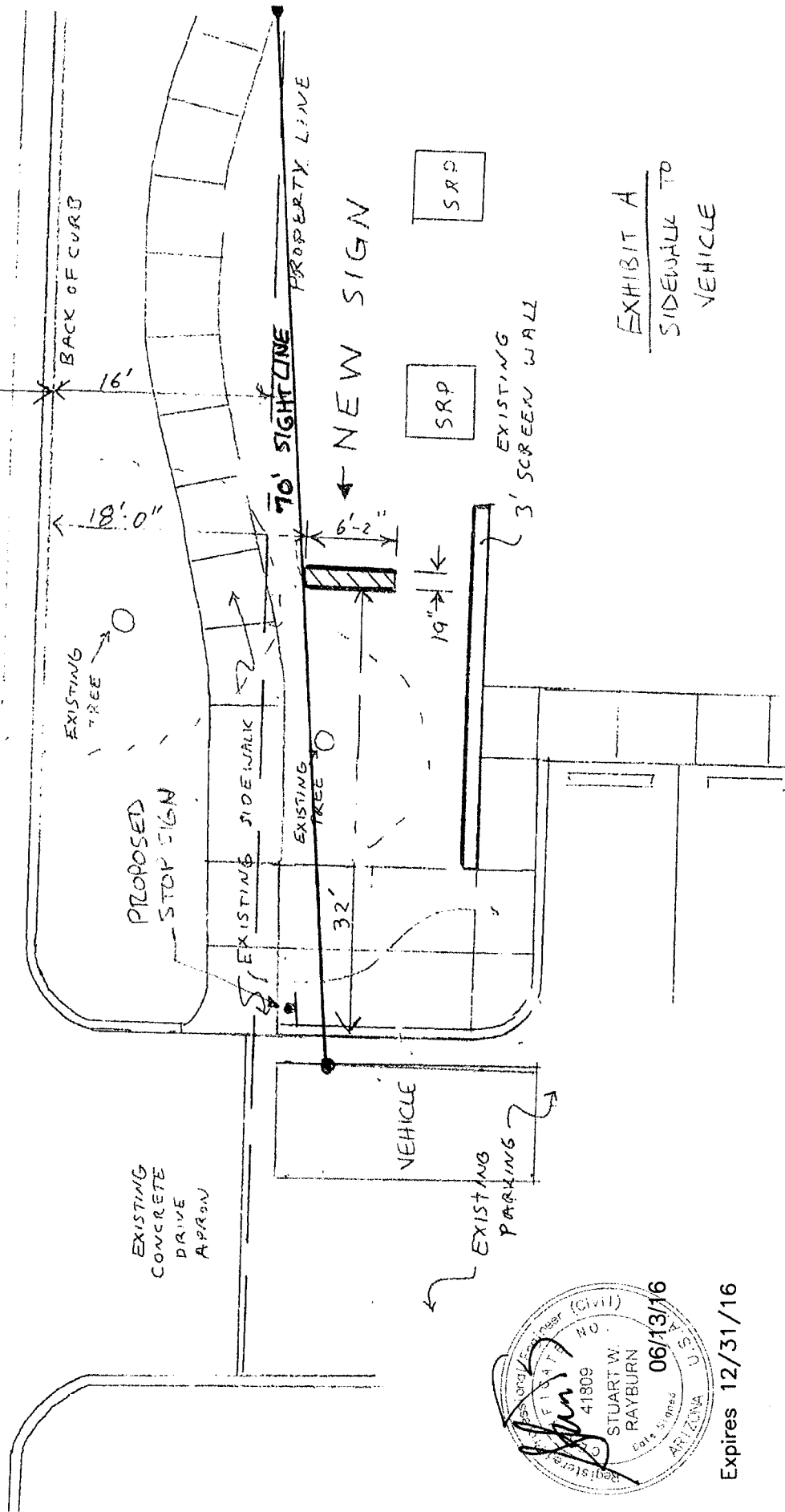

EXHIBIT A
SIDEWALK TO
VEHICLE

VALLEY PRESBYTERIAN CHURCH

6947 E. McDONALD DR.

1" = 10'

5-18-16

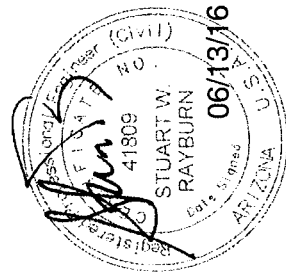

Expires 12/31/16

E. McDONALD DR.

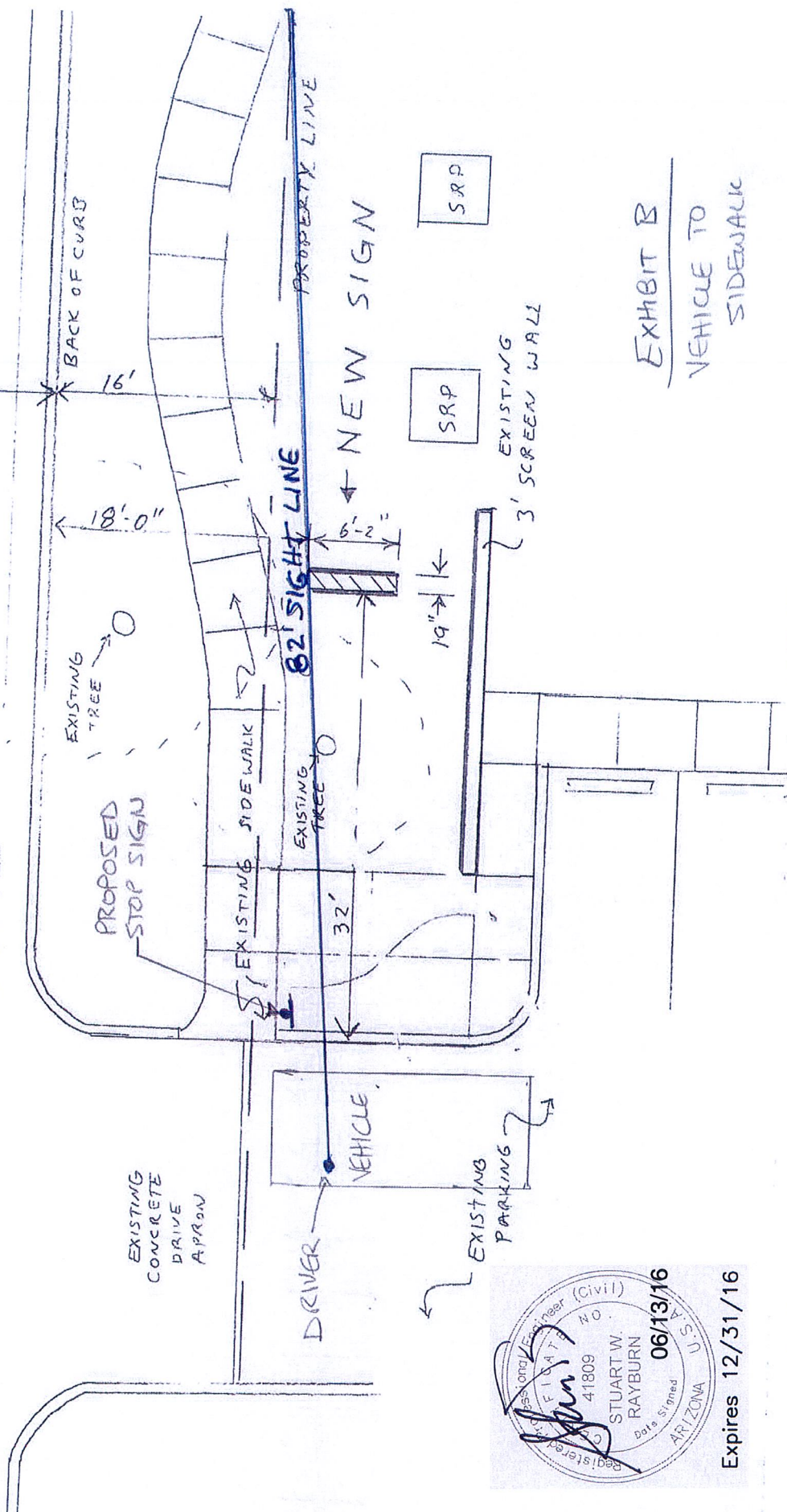

EXHIBIT B
VEHICLE TO
SIDEWALK

VALLEY PRESBYTERIAN CHURCH
6947 E. McDONALD DR.
5-18-16

1"=10'





Map

