

# TOWN OF PARADISE VALLEY

## Pavement Management: Preserving The Town's Roadways



# Purpose of Presentation

- Award a Pavement Preservation Maintenance Unit Pricing Contract
- Approval of Annual Pavement Preservation Project
- Maintenance District 2, 4, 14 & Mockingbird Lane
- Tatum Boulevard Resurfacing Project
- Program Schedule
- Project Cost Summary
- Questions



## Pavement Preservation Maintenance Unit Pricing Contract

- Obtain unit pricing for the Town's annual pavement preservation projects and associated concrete work
- Includes unit pricing for rubberized asphalt on Tatum Boulevard and Lincoln Drive
- Recommending a 3 year contract with the option to extend for up to two (2) additional terms of one (1) year each
- Benefits of a multi-year, annual maintenance contract:
  - Pricing – Unit costs are 16% lower than previously used unit pricing contract
  - Gives Staff the ability to retain one contractor to apply surface treatments and complete concrete flatwork projects
  - Ensures a mutual understanding regarding quality requirements, materials and expected time frames
  - Reduce Staff time in procuring street related projects on an individual basis



## Pavement Preservation Maintenance Unit Pricing Contract

- January 5<sup>th</sup>, 2018: Staff advertised an Invitation for Bid (IFB) for a pavement preservation maintenance unit pricing contract (various surface seals, asphalt mill & inlay, and concrete flat work)
- January 24<sup>th</sup>, 2018: Six sealed bids were received
- The bid tally costs represent the average quantities needed in three (3) maintenance districts as well as pricing for rubberized asphalt on Lincoln Drive and Tatum Boulevard



# Pavement Preservation Maintenance Unit Pricing Contract

The results from the six bids received are below:

Company	Bid Price
MR Tanner	\$1,368,000.00
Sunland Asphalt	\$1,555,627.00
Cactus Asphalt	\$1,581,122.25
Regional	\$1,596,588.67
Nesbitt	\$1,670,725.00
Pave Co	\$1,773,136.00

- M.R. Tanner is lowest responsive bidder for the Pavement Maintenance Unit Pricing Contract
- M.R. Tanner provides excellent customer service.
- Staff recommends Council to award the Pavement Preservation Maintenance Unit Pricing Contract to M.R. Tanner



# **FY 17/18 Pavement Preservation Project**

## **Maintenance Districts 2, 4, 14, Mockingbird Lane and Tatum Blvd.**



# Maintenance District #2

- ❑ **Maintenance District #2:** 7.8 linear miles of streets with an average Pavement Condition Index (PCI) rating of 57
- ❑ **Recommendation:** The streets in this district require a full mill and 1½ asphalt overlay
- ❑ **Boundaries:** Lincoln Drive south to Stanford Drive & Tatum Blvd west to 38<sup>th</sup> St.

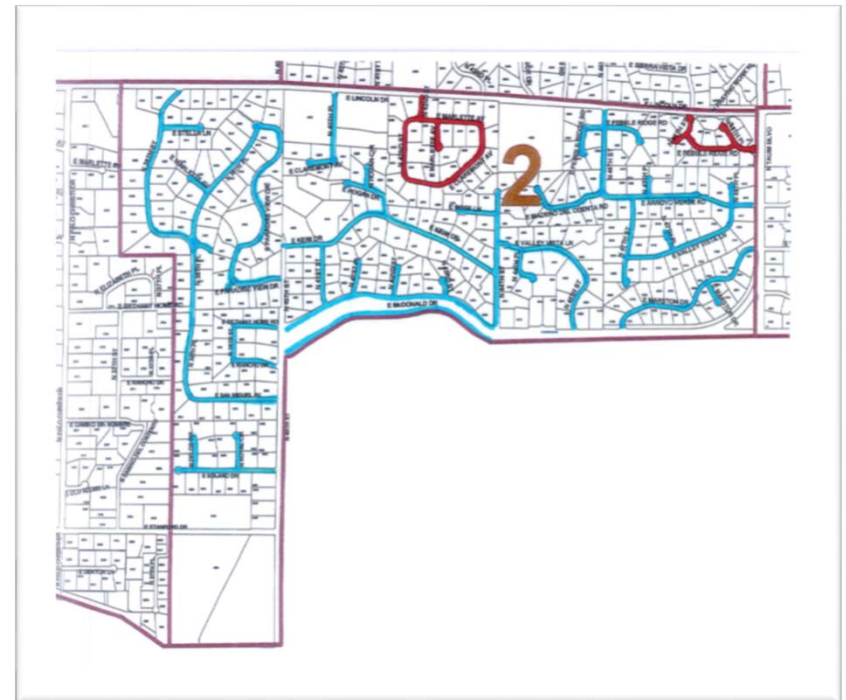

- Streets Receiving a Mill & Overlay
- Private Roads the Town Does Not Maintain



# Maintenance District #4

- ❑ **Maintenance Districts #4:** 0.7 linear mile of streets |
- ❑ **Recommendation:** The south eastern portion of this maintenance district require a full mill and 1 ½ asphalt overlay
- ❑ **Boundaries:** 73<sup>rd</sup> Place (east of Scottsdale Rd) east to Scottsdale city limits & Sage Drive south to Cholla Lane

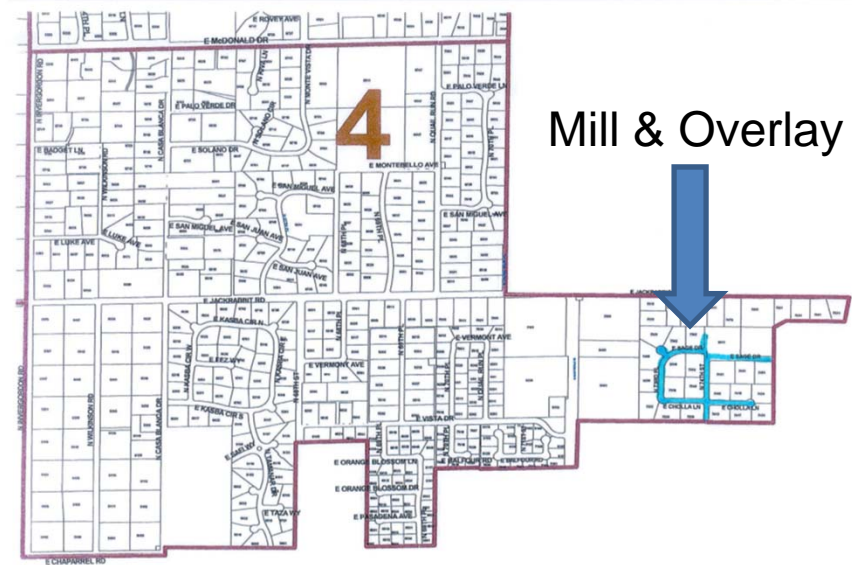



# Maintenance District #14

- ❑ **Maintenance District #14:** 7.4 linear miles of streets with an average PCI rating of 87
- ❑ **Recommendation:** The streets in this district require crack seal and high density mineral bond (PMM) surface treatment
- ❑ **Boundaries:** Doubletree Ranch Road south to Northern Avenue & 62<sup>nd</sup> Place east to Scottsdale Road

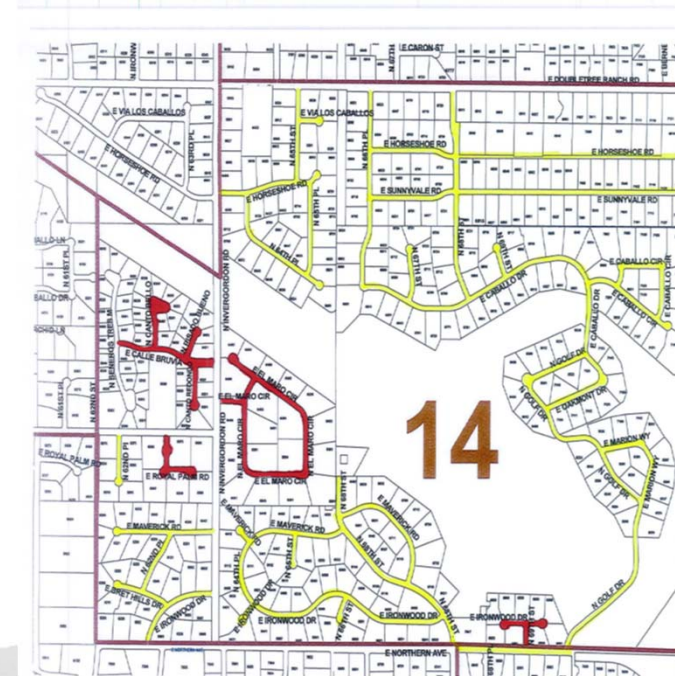

-  Streets Receiving Crack Seal & Surface Seal
-  Private Roads the Town Does Not Maintain



# Mockingbird Lane

- ❑ **Mockingbird Lane:** 1 mile of Mockingbird Lane has a PCI rating of 61
- ❑ **Recommendation:** This segment of Mockingbird Lane requires a crack seal and application of high density mineral bond PMM surface treatment
- ❑ **Boundaries:** Invergordon Road west to 56<sup>th</sup> Street

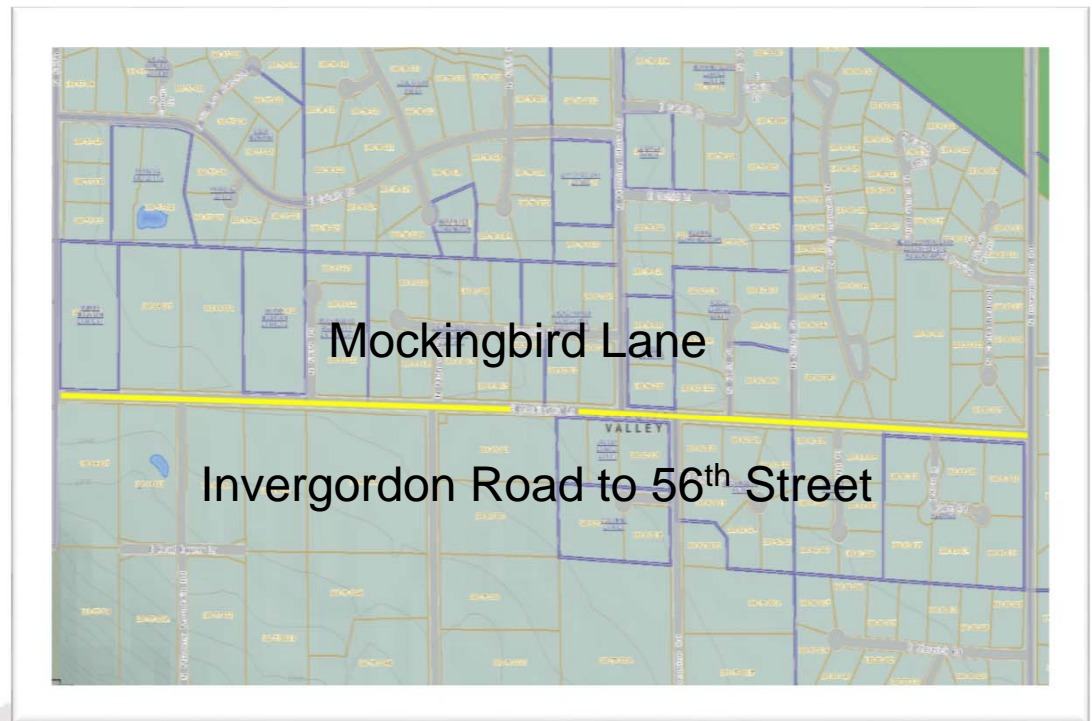

# Tatum Boulevard

- Staff recommends a full mill and 1 ½ rubberized asphalt overlay**
  - Ramm Engineering performed a pavement analysis study in July 2017 to evaluate the condition of Tatum Blvd.
  - 21 core samples were taken at various locations
  - Asphalt thickness ranges from 5 ½ to 7 ¾ inches thick
  - Recommending a 1 ½ inch full mill and rubberized asphalt overlay
  
- American Disability's Act (ADA) curb ramp modifications**
  - U.S. Department of Justice & U.S. Department of Transportation require ADA ramps updated to the new specifications
  - Staff will update 61 ADA ramps on Tatum Blvd prior to the asphalt mill & overlay project



# Coordination With Community Development & Utility Companies

- ❑ Communicated with Community Development on the Visually Significant Corridor Project
- ❑ In anticipation of the project, staff held quarterly meetings with utility companies to discuss there future projects that would affect the mill & overlay project

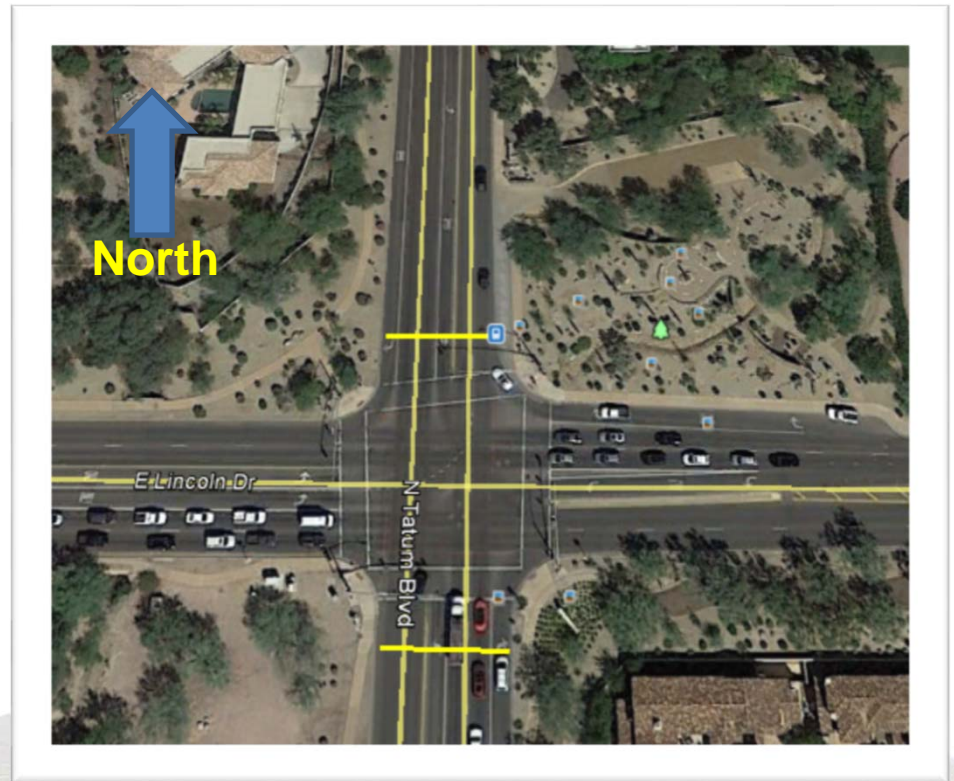

# FY17/18 Asphalt Overlay & Surface Seal Schedule

- Crack seal in Maintenance District 14 & Mockingbird Lane:**
  - Begin April 2018
  - Estimated completion May 2018
- Application of surface seal for Maintenance District 14 & Mockingbird:**
  - Begin April 2018
  - Estimated completion May 2018
- Maintenance District 2:**
  - Begin mill and asphalt overlay on April 2018
  - Estimated completion June 2018
- South eastern portion of Maintenance District 4:**
  - Begin mill and asphalt overlay in mid-June 2018
  - Estimated completion June 2018.



# FY17/18 Tatum Boulevard Resurfacing Project

- ADA curb ramp updates:**
  - Start in April 2018
  - Estimated completion by the end of April 2018
- Pre-lower manholes and hand valves:**
  - Start in April 2018
  - Estimated completion by the end May 2018
- Mill, rubberized asphalt overlay, and temporary striping:**
  - Start in May 2018
  - Estimated completion by the end of May 2018
- Manhole, hand valve adjustments and permanent striping:**
  - Start in the end of May 2018
  - Estimated completion by the end of June 2018



# FY17/18 Costs Summary

- Cost for Mill & Asphalt Overlay: \$1,343,887.90
- Cost for Crack Seal & PMM: \$351,574.68
- Cost for Tatum Blvd Mill & Rubberized Overlay: \$1,621,100.90
- Total Combined Project Cost = \$3,316,564.00
- FY17/18 Pavement Management Budget = \$3,317,000.00



# Questions?

