

Scottsdale Plaza Intermediate Special Use Permit Amendment (SUP-22-02)

	<b>Date</b>	<b>Comment</b>	<b>Type</b>
1	5/3/2023	Charlie Hall called to get an update on what Planning Commission recommended	Phone
2	5/2/2023	No public comments on the amendment	Planning Commission Public Hearing
3	4/17/2023	Response to Mr & Mrs. Brady (residents) from the applicant's engineer o	Email
4	4/5/2023	Marel Brady provided information on architetcure and had questions on the proposed parking	Email
5	2/21/2023	Tim O'Connor, Town resident, concerns over existing lights on main lodge near Scottsdale Rd/Hummingbird Ln (applicant contacted and provided him information on the project)	Email
6	2/8/2023	Kay Bowman, Town resident, excited about renovations	Email
7	2/7/2023	Bryan & Marel Brady, Town residents, spoke after the Planning Commission work session about better visuals to understand the architecture and design theme, avoiding mismatch of architecture in blending the existing with the new buildings (applicant contacted and provided additional visuals)	Meeting
8	2/7/2023	Julien Di Ciano, Scottsdale resident, fully support renovation	Email
9	2/6/2023	Applicant's Citizen Review Session (neighborhood meeting, refer to Community Outreach report) - 13 residents attended, questions focused on background on Highgate, circulation, driveways, and parking (focus on 3 new restaurants), construction timing, phasing, and impact to Indian Bend Rd, type of restaurants and if leased out, amenities/neighborhood programs, and building heights	Other
10	10/3/2022	Applicant reception (Refer to Neighborhood Reception Meeting report) - 4 residents attended the event, questions focused on the scope, amenities offered, driveway locations, underground parking, and completion date	Other
11	9/28/2022	Nicole Russel from Crown Castle public record request of plan submittal	Email

## Paul Michaud

---

**Subject:** Scottsdale Plaza Resort Parking Information between Consultant and PV Resident  
**Attachments:** Plaza Resort Presentation for Bryan Brady.pdf

---

**From:** Paul Michaud <[pmichaud@paradisevalleyaz.gov](mailto:pmichaud@paradisevalleyaz.gov)>  
**Sent:** Monday, April 17, 2023 9:55 AM  
**Subject:** NEW CORRESPONDENCE: Planning Commission Meeting April 18, 2023

Dear Chair and Commissioners (bcc),

Below is correspondence from the applicant to a resident on the Scottsdale Plaza item for your information. The applicant will be providing the Planning Commission a presentation on parking and architecture at the Planning Commission meeting tomorrow.

Regards,

Paul E. Michaud, AICP  
Planning Manager  
Community Development – Planning Division  
6401 E Lincoln Drive  
480-348-3574 (phone)  
[pmichaud@paradisevalleyaz.gov](mailto:pmichaud@paradisevalleyaz.gov)  
Office Hours: Mon-Fri 7:00 a.m. – 4:00 p.m., closed noon-1:00 p.m. and holidays

**Disclaimer:**

All messages contained in this system are the property of the Town of Paradise Valley and are considered a public record subject to disclosure under the Arizona Public Records Law (A.R.S. 39-121). Town employees, public officials, and those who generate e-mail to and from this e-mail domain should have no expectation of privacy related to the use of this technology.

---

**From:** Paul E. Basha, PE, PTOE <[pbasha@summitlandmgmt.com](mailto:pbasha@summitlandmgmt.com)>  
**Sent:** Friday, April 14, 2023 5:22 PM  
**To:** [REDACTED]  
**Cc:** Martin Greenwood <[REDACTED]>; Dina Winder <[REDACTED]>; Jordan R. Rose <[jrose@roselawgroup.com](mailto:jrose@roselawgroup.com)>; Jennifer Hall <[JHall@roselawgroup.com](mailto:JHall@roselawgroup.com)>; Kayla Bertoldo <[kbertoldo@roselawgroup.com](mailto:kbertoldo@roselawgroup.com)>; Paul Michaud <[pmichaud@paradisevalleyaz.gov](mailto:pmichaud@paradisevalleyaz.gov)>; Shar Johnson <[sjohnson@paradisevalleyaz.gov](mailto:sjohnson@paradisevalleyaz.gov)>  
**Subject:** Plaza Resort Parking Study Presentation for Planning Commission Study Session of 18 April

**External email: use caution with links & attachments**

Marel and Bryan,

Thank you for the opportunity to meet with Bryan this morning.

Attached is our presentation (in pdf format) for the Planning Commission for Tuesday, 19 April.

Slide 3 shows that the majority of the existing buildings will remain. As was explained today, these buildings will be repainted with other similar appearance renovations. Also indicated in slide 3 is the buildings that will be demolished and replaced, and the surface parking area that will be removed.

Slide 4 lists the additions to the property, and slide 5 is the proposed site plan.

Slides 6 through 9 are the critical slides pertaining to the existing parking. 62% of the existing parking spaces are unused. The number of occupied parking spaces were counted 25 and 26 February 2022 – a peak-season fully-occupied weekend – every 30 minutes from noon on Friday through noon on Saturday. The maximum number of parked vehicles was 279, which occurred on Saturday morning at 9:30 AM. The maximum number of parked vehicles overnight was 227, which occurred at 3:00 AM Saturday morning.

Slide 10 determines the occupied parking spaces per conference room area on Saturday at 9:30 AM. All parked vehicles were counted – including employees, hotel guests, conference room users, delivery vehicles, service-people vehicles, and other vehicles on property for every purpose. However, only the conference room area was used to calculate the parking rate. If we had used the total area of all buildings on property, the area would have been much larger, which would have resulted in a much lower parking demand per building area. Thereby, the conference room parking rate is very conservatively high. The calculated parking demand is 1 parking-space-per-110 square feet of conference room area.

Slide 11 determines the occupied parking spaces per occupied hotel guest room on Saturday at 3:00 AM. All parked vehicles were counted – including employees, hotel guests, delivery vehicles, service-people vehicles, and other vehicles on property for every purpose. However, only the occupied hotel guest rooms were used to calculate the parking rate. Thereby, the hotel guest room parking rate is conservatively high. The calculated parking demand is 0.60 parking-space-per-occupied-hotel-guest-room.

Slide 12 provides the conservative assumptions for the parking need by building purpose. On the days of the parking count, 100% of the conference room users were also hotel guests. Therefore, their parked vehicles were on-property for their hotel guest room use, meaning that zero additional parked vehicles were needed. For the renovated Plaza Resort, we assumed 20% of the conference room users were not hotel guests, and therefore needed parking spaces. This is conservative and very unusual. The Plaza Resort clientele are people who stay in the hotel and use the conference rooms – for conferences, weddings, and other corporate and celebratory events.

Slide 12 also indicates that 100% of the spa and fitness building area will be used by people who are not otherwise at the resort. (People who are not staying in the hotel guest rooms or using the conference rooms.) This is also conservative, as the Plaza Resort owners believe that approximately 50% of the spa and fitness users will be hotel guests, and therefore will not need an additional parking space.

Slide 12 also indicates that 60% of the restaurant diners will be hotel guests, with 40% of the diners not staying in the hotel. The Plaza Resort is intended to provide people who are staying on the property all their needs on property. Certainly some people will want to visit other sites while they are here, but they do not need to leave the property. This is one of the reasons that three different and separate restaurants are planned. Each will have its own individual specialties and atmosphere. People who will be staying on property for several days will be able to have different dining experiences on different days without leaving the property. The Plaza Resort does want local people to also dine at the new restaurants, and therefore 40% of the diners are assumed to need parking spaces because they are not staying at the hotel. (Though it is recognized that many local people use ride-share for their restaurant meals, and therefore do not need parking spaces.) The Plaza Resort also hopes that guests at other Phoenix area hotels will also dine at the new restaurants – though these other restaurant guests will likely use ride-share or taxis and will not need parking spaces. Therefore assuming that 40% of the restaurant diners will need parking spaces is also very conservative.

Slides 13 and 14 determine the total number of parking spaces needed (without considering shared parking). The base determination is the number of parking spaces needed for hotel guests. The parking rate used is the existing parking rate of 0.60 parking-spaces-per-hotel room. The total number of hotel guests rooms with the renovated resort is 468, so 281 parking spaces are needed. Next is the number of parking spaces needed for the rare occasions when some people will be using the conference rooms without staying at the hotel. Therefore 59 parking spaces are added. Similarly, 121 additional parking spaces are needed for the restaurants to serve the diners that are not staying at the hotel. Finally, all spa and fitness room users are assumed to not be staying at the hotel, so an additional 27 parking spaces are needed. Important to recognize that the Plaza Resort intention is that the spa and fitness area will be closed at 6:00 PM, and therefore no spa and fitness users will occupy parking spaces during the prime restaurant dinner times. The total number of parking spaces, without considering shared parking, is 588 spaces.

Slides 15, 16, 17, and 18 are the results of three of the five shared parking models that were considered. Shared parking recognizes that the same parking space can be used by different vehicles at different times of the day. For example, a parking space might be needed for a spa and fitness user in the morning, and used by a restaurant diner in the evening. Similarly, a parking space might be used by a hotel guest overnight, and used by a restaurant diner for lunch or dinner who is not staying at the hotel. Each of the five different shared parking models has different assumptions, so all five were calculated and the maximum result was recommended. The shared parking model with the maximum required parking was the City of Waltham, Massachusetts (which is an affluent Boston suburb near the Massachusetts Institute of Technology and Cambridge). The City of Waltham shared parking model calculates that 571 parking spaces are needed. I believe it inappropriately non-conservative to utilize only one shared parking model for determining the necessary parking space number. For example, the Ritz-Carlton parking analysis and report only utilized the City of Scottsdale shared parking model. If we had only used the Scottsdale shared parking model, we would have recommended that the Plaza Resort needed 524 parking spaces. In my professional opinion, that would be non-conservative and would have been a dis-service to the Plaza Resort.

Slides 19 and 20 provide the calculated parking space need using the Paradise Valley guidelines and the parking requirements of five other nearby cities. (Please recognize that Paradise Valley does not have parking requirements for commercial properties, only guidelines.) These guidelines and requirements would result in an extremely large number of parking spaces. As stated in Slide 21, the two nearby resort hotels of Montelucia and Ritz-Carlton, as approved by the Paradise Valley Town Council, provide a small percentage of the Paradise Valley guidelines, as does our recommendation for the Plaza Resort.

Slides 22, 23, 24, and 25 indicate the number of additional parking spaces provided by the Plaza Resort for valet parking. Importantly, the underground parking area is designed to be used by normal drivers – following the design requirements for typical parking areas, providing wide two-way travel aisles and allowing all vehicles to enter and leave without moving other vehicles. However, the Plaza Resort intends to utilize the underground parking as valet-only. Valet service increases the number of available parking spaces. Similarly, some of the surface parking areas could also be utilized for valet-only parking which also increases the number of available parking spaces. Therefore, the Plaza Resort property can accommodate 656 parking spaces with valet parking.

Some additional comments.

The parking rates utilized for the hotel guest rooms and the conference rooms were determined from the parking demand on the existing property use by the existing owner-operator. This is the best possible determination technique for required parking. Other techniques use assumptions from other properties or agencies.

The Plaza Resort will use their conference rooms approximately 60% to 75% of the conference room business day (say 8:00 AM to 10:00 PM) for the entire year. And again, the conference room users are the hotel guests. Rarely is the conference room area used by non-hotel guests. A maximum of three days each year, the conference room might be used for lecture-style, no tables, no food-and-beverage-service events. These rare events are scheduled far in advance

and off-site parking might be necessary to accommodate such events. The Plaza Resort does not prefer this use of their property, and only accommodates certain specific clients for this use.

The Plaza Resort has entered into remote off-site parking agreements with the Millennium McCormick Scottsdale Hotel and the Scottsdale Railroad Park. These agreements were at the request of the Town of Paradise Valley, not the desire of the Plaza Resort. Importantly, the agreements are reciprocal, meaning both off-site properties can also use the Plaza Resort parking areas for their purpose, when necessary. The Plaza Resort knows that 571 parking spaces are excessive, so they are comfortable offering these other two entities the opportunity to use the Plaza Resort parking areas.

The existing parking areas are extremely excessive. Only 38% of the existing parking spaces are used by parked vehicles. To reinforce this fact, today the Plaza Resort was 100% occupied, though the vast majority of the parking spaces were unused. Furthermore, the Parking Report includes 26 aerial photographs dating back to 1996 showing the Plaza Resort parking areas mostly empty. The aerial photographs with the most parked vehicles are from the era prior to ride-share, and even the aerial photographs from those years show the Plaza Resort parking areas mostly empty.

I hope that I have answered all your questions. However, please inform me if I have not answered your questions. I also will be happy to answer other questions that may arise or you may have.

Finally, I would be happy to meet with you again at your convenience. I am available both Saturday and Sunday afternoon. I am also available Monday after 10:00 AM until as late as convenient for you. I am also available as early as you would like on Tuesday through 1:00 PM. After that time, I will be preparing for the presentation to the Paradise Valley Planning Commission Tuesday evening starting at 6:00 PM. I can generally make myself available subsequent to the 18 April Planning Commission Study Session and prior to the 2 May Planning Commission Meeting and Vote. Please call or e-mail me at your convenience to schedule such a meeting.

Thank you for your interest and your consideration of my comments and our Parking Analysis and Report.

Paul

**Paul E. Basha, PE, PTOE**

Traffic Engineering Manager



7144 E Stetson Drive, Suite 300, Scottsdale, AZ 85251

Office: 480.505.3931 [REDACTED]

<https://summitlandmgmt.com/>



[roselawgroup.com](http://roselawgroup.com)    [Roselawgroupreporter.com](http://Roselawgroupreporter.com)

[@roselawgroup](https://twitter.com/roselawgroup)    [@roselawgroupmeta](https://twitter.com/roselawgroupmeta)

RLG is Service :: Winner "Best places to work in Arizona"

The author of this email is not an attorney. This communication does not constitute legal advice and should not be construed as such. The information contained in this message is privileged and confidential. It is intended only to be read by the individual or entity named above or their designee. If the reader of this message is not the intended recipient, you are on notice that any distribution of this message, in any form is strictly prohibited. If you have received this message in error, please immediately notify the sender by telephone at 480.505.3931 or fax 480.505.3925 and delete or destroy any copy of this message. Thank you.



Think green, please don't print unnecessarily

# PLAZA RESORT RENOVATION

NORTHWEST CORNER  
SCOTTSDALE ROAD AND  
INDIAN BEND ROAD

EXISTING  
AERIAL  
PHOTOGRAPH

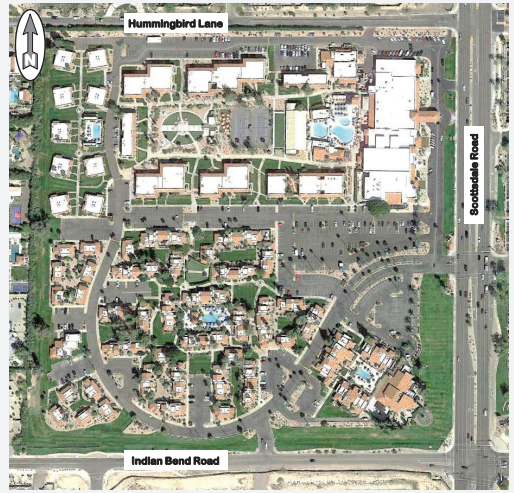

## PROPOSED ADDITIONS

- 64 ROOMS
- 2,600 SQUARE FEET OF CONFERENCE ROOM
- NEW LOBBY
- NEW SPA AND FITNESS ROOM
- 3 NEW RESTAURANTS

- RENOVATION
- DEMOLITION (39,402 SF)
- PARKING DEMOLITION



PROPOSED  
SITE PLAN

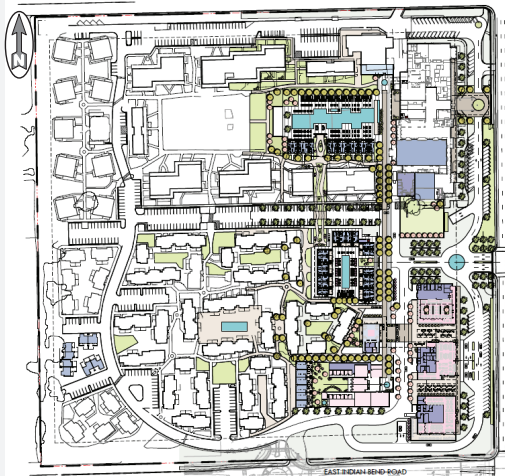

PLAZA RESORT  
392 OCCUPIED HOTEL ROOMS OUT OF 404 TOTAL  
PARKING OCCUPANCY  
25 AND 26 FEBRUARY 2022

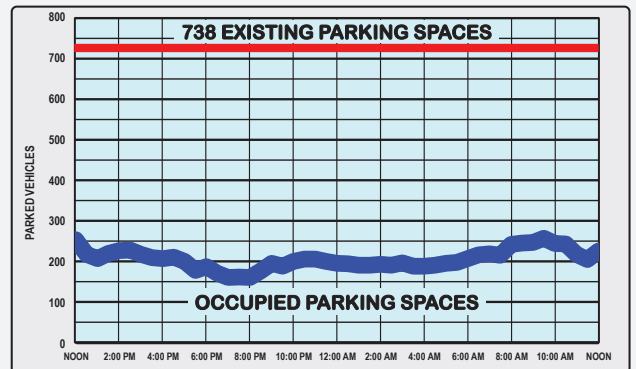

PLAZA RESORT  
392 OCCUPIED HOTEL ROOMS OUT OF 404 TOTAL  
PARKING OCCUPANCY  
25 AND 26 FEBRUARY 2022

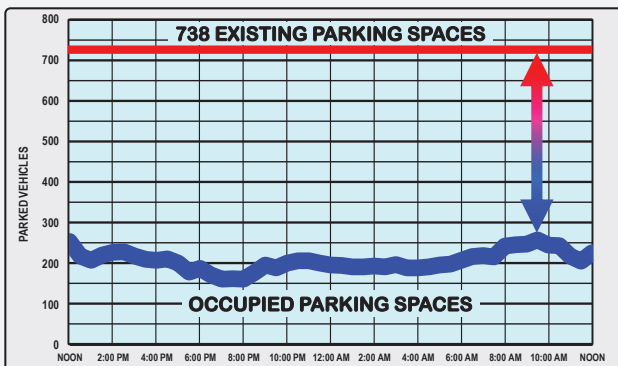

PLAZA RESORT  
392 OCCUPIED HOTEL ROOMS OUT OF 404 TOTAL  
PARKING OCCUPANCY  
25 AND 26 FEBRUARY 2022

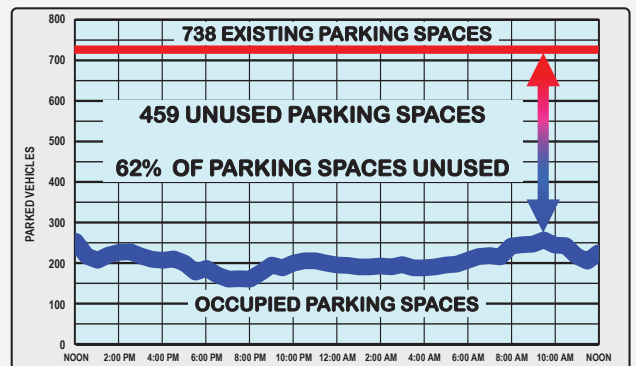

**PLAZA RESORT  
392 OCCUPIED HOTEL ROOMS OUT OF 404 TOTAL  
PARKING OCCUPANCY  
25 AND 26 FEBRUARY 2022**

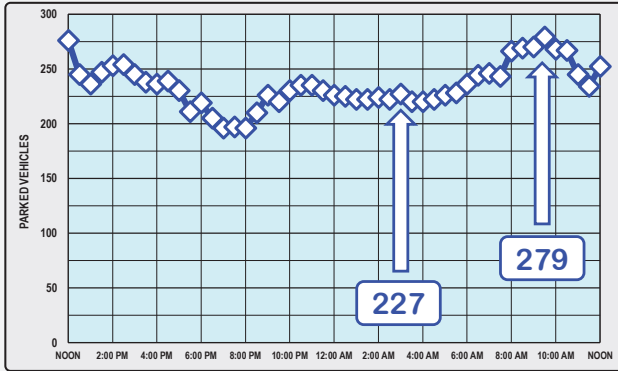

**PLAZA RESORT  
PARKING OCCUPANCY  
25 AND 26 FEBRUARY 2022**

**MAXIMUM PARKING:** 279 of 738 Spaces  
(All Parked Vehicles)

**CONFERENCE ROOM AREA:** 29,736 Square feet

**1 Parking Space per 110 square feet  
(includes employees)**

**PLAZA RESORT  
PARKING OCCUPANCY  
25 AND 26 FEBRUARY 2022**

**MAXIMUM OVERNIGHT PARKING:** 227 of 738 Spaces  
(All Parked Vehicles)

**OCCUPIED HOTEL GUEST ROOMS:** 392 of 404 Rooms

**0.60 Parking Space per Room  
(includes employees)**

**RENOVATED PLAZA RESORT**

**80 % of Conference Room Users are Hotel Guests  
20 % of Conference Room Users need Parking Spaces**

**0 % of Spa and Fitness Users are Hotel Guests  
100 % of Spa and Fitness Users need Parking Spaces**

**60 % of Restaurant Diners are Hotel Guests  
40 % of Restaurant Diners need Parking Spaces**

**RENOVATED PLAZA RESORT**

**INITIAL PARKING REQUIREMENT  
(without considering Shared Parking)**

- Total Hotel Guest Rooms:** 281 Parking Spaces
- Total Conference Rooms:** 59 More Parking Spaces
- New Restaurants:** 121 More Parking Spaces
- New Spa and Fitness:** 27 More Parking Spaces

**TOTAL INITIAL PARKING:** 588 Parking Spaces

**RENOVATED PLAZA RESORT**

**INITIAL PARKING REQUIREMENT  
(without considering Shared Parking)**

**CONSERVATIVE**

- Total Hotel Guest Rooms:** 281 Parking Spaces
- Total Conference Rooms:** 59 More Parking Spaces
- New Restaurants:** 121 More Parking Spaces
- New Spa and Fitness:** 27 More Parking Spaces

**TOTAL INITIAL PARKING:** 588 Parking Spaces

**PLAZA RESORT: PARADISE VALLEY, ARIZONA  
MAXIMUM SHARED PARKING ANALYSIS: CITY OF WALTHAM MODEL**

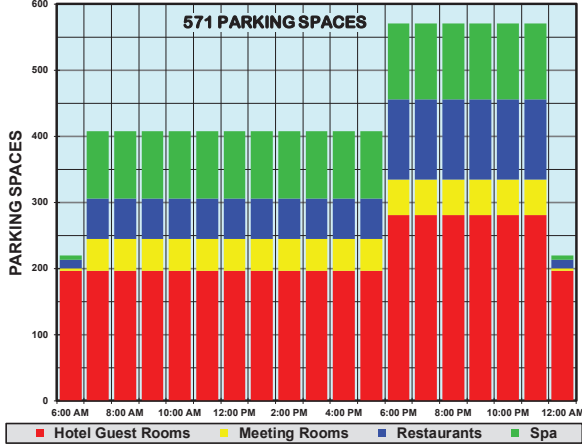

**PLAZA RESORT: PARADISE VALLEY, ARIZONA  
SHARED PARKING DEMAND - CITY OF TEMPE MODEL**

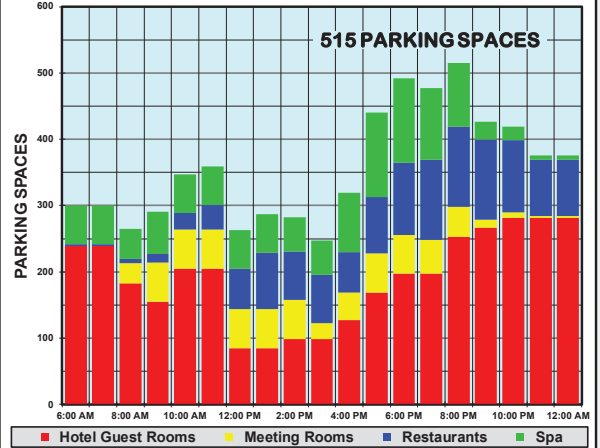



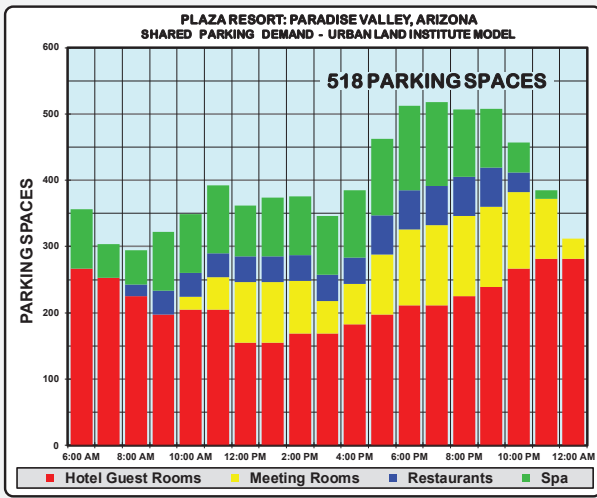

**RENOVATED PLAZA RESORT**  
**SHARED PARKING MODELS**

**Initial Parking Requirement: 588 Parking Spaces**

**SHARED PARKING MODELS AND RESULTS**

**City of Waltham: 571 Parking Spaces**

**Victoria Transport Institute: 552 Parking Spaces**

**City of Scottsdale: 524 Parking Spaces**

**Urban Land Institute: 518 Parking Spaces**

**City of Tempe: 515 Parking Spaces**

**PARADISE VALLEY PARKING GUIDELINES**  
**COMPARED TO OTHER VALLEY CITIES REQUIREMENTS**

JURISDICTION	1 Space per Indicated Square Feet					
	Hotel Guest Room	Meeting Rooms	Restaurants	Spa and Fitness	Office	Retail
Paradise Valley	1.2	30	50	300	300	300
Scottsdale	1.0	50	120	250	250	300
Phoenix	1.0	100	50	150	286	300
Tempe	1.0	125	75	125	300	300
Chandler	1.0	100	100	200	250	250
Gilbert	1.1	250	100	150	250	250
Plaza Resort	0.6 *	110 *	120	300	not applicable	not applicable

**PLAZA RESORT BASE REQUIRED PARKING**  
**PARADISE VALLEY PARKING GUIDELINES**  
**COMPARED TO OTHER VALLEY CITIES REQUIREMENTS**

JURISDICTION	PARKING SPACES				TOTAL
	Hotel Guest Room	Meeting Rooms	Restaurants	Spa and Fitness	
Paradise Valley	562	1,078	722	127	2,489
Scottsdale	468	647	301	153	1,569
Phoenix	468	324	722	254	1,768
Tempe	468	259	482	305	1,514
Chandler	468	324	361	191	1,344
Gilbert	515	130	361	254	1,260

**PLAZA RESORT**  
**PARKING SPACE COMPARISON**  
**NEARBY HOTELS**

HOTEL	PARKING SPACES		
	GUIDELINES	PROVIDED	PORTION
MONTELUCCIA	1,712	638	37%
RITZ-CARLTON	1,461	390	27%
PLAZA RESORT	2,489	571	23%

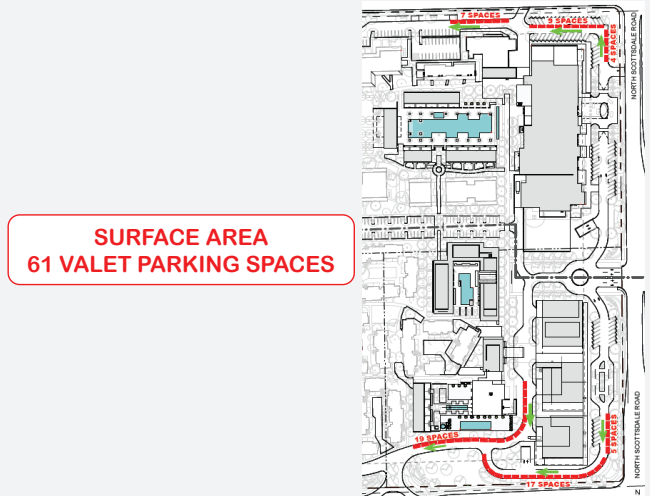

**UNDERGROUND AREA**  
**24 VALET PARKING SPACES**

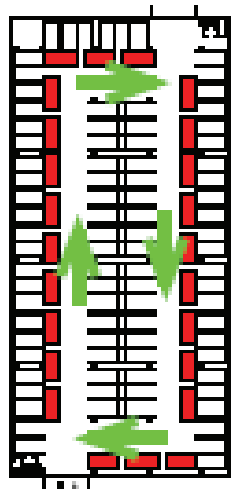

**PARKING COUNT SUMMARY**

<b>GROUND LEVEL STALLS</b>	
ZONE A	115
ZONE A.1	7
ZONE B	78
ZONE C	163
ZONE D	32
ZONE E	30
ZONE F	28
ZONE G	30
<b>GROUND LEVEL SUB-TOTAL</b>	<b>483</b>
<b>BASEMENT GARAGE STALLS</b>	
ZONE H	88
<b>BASEMENT LEVEL SUBTOTAL</b>	<b>88</b>
<b>TOTAL PARKING REQUIRED</b> BASED ON PARKING ANALYSIS	<b>571</b>
<b>TOTAL PARKING PROVIDED</b>	<b>571</b>

<b>PARKING COUNT SUMMARY</b>	
GROUND LEVEL STALLS	
ZONE A	115
ZONE A.1	7
ZONE B	78
ZONE C	163
ZONE D	32
ZONE E	30
ZONE F	28
ZONE G	30
<u>GROUND LEVEL SUB-TOTAL</u>	<u>483</u>
BASEMENT GARAGE STALLS	
ZONE H	88
<u>BASEMENT LEVEL SUBTOTAL</u>	<u>88</u>
TOTAL PARKING REQUIRED BASED ON PARKING ANALYSIS	
	571
TOTAL PARKING PROVIDED	
	571

<b>PARKING COUNT SUMMARY - VALET ADD. SPACES</b>	
GROUND LEVEL ADDITIONAL VALET SPACES	
	81
BASEMENT GARAGE ADDITIONAL VALET SPACES	
	24
<u>TOTAL ADDITIONAL VALET SPACES</u>	
	<u>85</u>
<u>TOTAL PARKING CAPACITY WITH VALET SPACES</u>	
	<u>656</u>

**Paul Michaud**

---

**From:** marel brady <[REDACTED]>  
**Sent:** Wednesday, April 5, 2023 8:21 AM  
**To:** Lisa Collins; Paul Mood  
**Cc:** Bryan Brady  
**Subject:** Plaza remodel - streetscape

**External email: use caution with links & attachments**

**Good morning Mr Dickman, Ms Collins, Mr Mood,**

**Just want to forward a copy of our message, on streetscape, sent to the Planning Commission on March 6.**

**Best regards**

**Marel Brady**

Good afternoon Chair Rose,

Hope this message finds you well, and enjoying our warmer temperatures, now!

We applaud you, and all Planning Commissioners for your commitment to preserving the character of our Town.

In particular, we note the recommendation to extend the review period for the Scottsdale Plaza Resort... this seems like a very sensible approach.

As you take more time to consider every aspect, I wonder if you would find the undernoted photographs useful. These photographs are examples of successful hotel renovations. In each case, an holistic approach has been used i.e. rooflines and the entire streetscape have been renovated. Regardless of whether the style has any personal appeal, the result is a homogenous vista, rather than a "band aid" approach in just a few sections.





We, also, applaud you for your careful consideration of the parking facilities which are associated with the renovation of this iconic resort, in our Town.

Of course, we all want to work in collaboration with the resort to produce the best possible end product. Tourism is a huge industry, in our Town. We applaud the new owners of the Plaza for their commitment to invest in rebranding the resort. Clearly, everyone involved is looking to maximize the potential for new business, while retaining the character and charm of the resort... and of our Town.

With renewed appreciation for the work of the Planning Commission.

Best regards

Marel Brady  
Board Member  
Eagle Society

Bryan Brady  
Board Member  
Eagle Society

## Paul Michaud

---

**Subject:** FW: Plaza remodel - parking

---

**From:** Lisa Collins <[LCollins@paradisevalleyaz.gov](mailto:LCollins@paradisevalleyaz.gov)>

**Sent:** Wednesday, April 5, 2023 8:30 AM

**To:** marel brady [REDACTED]; Planning Commissioner Tim Dickman <[tdickman@paradisevalleyaz.gov](mailto:tdickman@paradisevalleyaz.gov)>; Paul Mood <[pmood@paradisevalleyaz.gov](mailto:pmood@paradisevalleyaz.gov)>

**Subject:** Re: Plaza remodel - parking

Good Morning Ms Brady,

Thanks for forwarding this email too!

Lisa Collins  
Community Development Director  
Town of Paradise Valley

---

**From:** marel brady [REDACTED]

**Sent:** Wednesday, April 5, 2023 8:12:57 AM

**To:** Lisa Collins <[LCollins@paradisevalleyaz.gov](mailto:LCollins@paradisevalleyaz.gov)>; Planning Commissioner Tim Dickman <[tdickman@paradisevalleyaz.gov](mailto:tdickman@paradisevalleyaz.gov)>; Paul Mood <[pmood@paradisevalleyaz.gov](mailto:pmood@paradisevalleyaz.gov)>

**Subject:** Plaza remodel - parking

**External email: use caution with links & attachments**

**Good morning Mr Dickman, Ms Collins, Mr Mood,**

**Just want to forward, to you both, a copy of our message sent to the Planning Commission on March 23.**

**In the meantime, further concerns have arisen regarding parking arrangements.**

**Best regards**

**Marel Brady**

Good morning Chair Rose,

Thank you for your devotion to the Town of Paradise Valley... the wonderful oasis in the desert, which all of us are delighted to call home!

Our concern about the remodel of the Plaza resort is growing. In particular, it is hard to understand the proposed parking facilities.

From the slide utilized, at the most recent Planning Commission meeting, the statistics on parking utilization were presented as follows:-

<b>Total existing</b>	<b>737</b>
<b>Total proposed</b>	<b>571 (standard configuration)</b>
<b>Total proposed</b>	<b>656 (full valet mode)</b>
<b>Parking demand</b>	<b>588 (w/o shared parking)</b>
<b>Parking demand</b>	<b>571 (with shared parking)</b>
<b>Parking applying guideline rates</b>	<b>2,489</b>

As a resident, with no knowledge of parking requirements for a resort, these statistics seem to make no sense.

At the most basic level, the number of parking facilities will be reduced by 166 spaces. At the same time, the number of guest facilities will be increased by 60 rooms. To the uninitiated, surely that means the number of parking facilities needs to be increased by 60 spaces... not reduced by 166 spaces?

Furthermore, three new restaurants will be constructed... doesn't that mean an even bigger need for many more, rather than 166 less parking spaces?

Additionally, one has to assume that the existing conference facilities which, apparently, have hosted as few as 3 events per year, will need to be working towards increased utilization... potentially occupied for 365 days per year. Again, doesn't this point the way to a significant need for more, rather than less parking spaces?

There is mention of shared parking... what does that mean? Does it mean, for example, that staff will be working shifts and utilizing the same space? But, surely, that situation exists, already?

There is mention of valet parking. Where will these vehicles be sited? The obvious place is across the road in retail and business space which is likely to be unused, during the evening. However, these spaces will be occupied during the day. Is the resort planning to enter into a contract with the owners of these parking facilities? Furthermore, doesn't it seem like an accident waiting to happen that valet staff might be driving cars across the road... and then running, across a busy arterial road with a speed limit of 45 mph, back to the resort.

Finally, isn't the "parking applying guideline rates" of 2,489 hard to comprehend? What does this mean?

On the positive side, of course, we are thrilled that the new owners of the Plaza intend to make a significant investment to update the resort. However, residents are concerned about the parking proposals... among other aspects.

We trust that, with collaboration, residents can look forward to an updated resort which does not undermine the safety, density, disturbance level, and charm of our Town.

Again, thank you to all Planning Commissioners for the many hours expended, already, on considering this application. Your dedication is much appreciated.

Best regards

Bryan Brady  
Board Member  
Eagle Society

Best regards

Marel Brady  
Board Member  
Eagle Society



**From:** [Jennifer Hall](#)  
**To:** [REDACTED]  
**Cc:** [Paul Michaud](#); [Kayla Bertoldo](#)  
**Subject:** RE: SPR Project  
**Date:** Tuesday, February 21, 2023 2:18:31 PM  
**Attachments:** [image001.png](#)

---

**External  
email: use  
caution  
with links  
&  
attachmen  
ts**

Wonderful. Thanks for your address and I'll stay in touch with you until this is resolved. Thx.

## Jennifer Hall

Senior Project Manager  
Rose Law Group pc  
[7144 E Stetson Drive, Suite 300, Scottsdale, AZ 85251](#)  
Direct: [480.505.3938](#) Fax: [480.505.3925](#) Mobile: [REDACTED]

The author of this email is not an attorney. This communication does not constitute legal advice and should not be construed as such. The information contained in this message is privileged and confidential. It is intended only to be read by the individual or entity named above or their designee. If the reader of this message is not the intended recipient, you are on notice that any distribution of this message, in any form is strictly prohibited. If you have received this message in error, please immediately notify the sender by telephone at 480.505.3936 or fax 480.505.3925 and delete or destroy any copy of this message. Thank you.

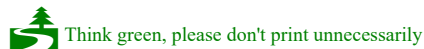

---

**From:** Tim O'Connor [REDACTED]  
**Sent:** Tuesday, February 21, 2023 2:13 PM  
**To:** Jennifer Hall <[JHall@roselawgroup.com](mailto:JHall@roselawgroup.com)>  
**Cc:** Paul Michaud <[pmichaud@paradisevalleyaz.gov](mailto:pmichaud@paradisevalleyaz.gov)>; Kayla Bertoldo <[kbertoldo@roselawgroup.com](mailto:kbertoldo@roselawgroup.com)>  
**Subject:** Re: SPR Project

Hi Jennifer,

Thank you for the information. My address is [REDACTED], Paradise Valley AZ 85253. I am on the northwest corner of Hummingbird and Scottsdale.

Good luck with the remodel. This will be a great update to our neighborhood and community.

Tim O'Connor

Sent from my iPhone

On Feb 21, 2023, at 1:57 PM, Jennifer Hall <[JHall@roselawgroup.com](mailto:JHall@roselawgroup.com)> wrote:

Hello Mr. O'Connor,

Thank you for your email. Can you please send me your property address so we can properly resolve your concern with the lighting?

Also, the northern portion of the property will not be changing much other than some cosmetic improvements - fresh paint and interior room renovations. We are adding some new rooms, new spa building with pool and three new high end restaurants on the southern end of the resort property (near Indian Bend and Scottsdale Rd).

You can find the project materials including the proposed renderings discussed at the 2/7 Planning Commission hearing by utilizing the link below.

<https://paradisivalleyaz.legistar.com/View.ashx?M=A&ID=1068876&GUID=5273511C-8077-488A-820D-F5DE7F11E4D6>

Thanks!

Senior Project Manager

Rose Law Group pc  
7144 E Stetson Drive, Suite 300, Scottsdale, AZ 85251  
Direct: 480.505.3938

Fax: 480.505.3925

Mobile:



The author of this email is not an attorney. This communication does not constitute legal advice and should not be construed as such. The information contained in this message is privileged and confidential. It is intended only to be read by the individual or entity named above or their designee. If the reader of this message is not the intended recipient, you are on notice that any distribution of this message, in any form is strictly prohibited. If you have received this message in error, please immediately notify the sender by telephone at 480.505.3936 or fax 480.505.3925 and delete or destroy any copy of this message. Thank you.

P Think green, please don't print unnecessarily

Senior Project Manager

7144 E Stetson Drive, Suite 300, Scottsdale, AZ 85251

Direct: [480.505.3938](tel:480.505.3938) Fax: [480.505.3925](tel:480.505.3925) Mobile: [REDACTED]

[roselawgroup.com](http://roselawgroup.com) [roselawgroupreporter.com](http://roselawgroupreporter.com)

[@roselawgroup](mailto:@roselawgroup) [@roselawgroupmeta](mailto:@roselawgroupmeta)

RLG is Service :: Winner "Best places to work in Arizona"

The author of this email is not an attorney. This communication does not constitute legal advice and should not be construed as such. The information contained in this message is privileged and confidential. It is intended only to be read by the individual or entity named above or their designee. If the reader of this message is not the intended recipient, you are on notice that any distribution of this message, in any form is strictly prohibited. If you have received this message in error, please immediately notify the sender by telephone at 480.505.3936 or fax 480.505.3925 and delete or destroy any copy of this message. Thank you.



Think green, please don't print unnecessarily

-----Original Message-----

From: Tim O'Connor [REDACTED]

[REDACTED] February 20, 2023 8:10 PM

To: Jennifer Hall <[JHall@roselawgroup.com](mailto:JHall@roselawgroup.com)>

Subject: SPR Project

Good evening,

I am currently building a house directly across Hummingbird to the north in Cheney Place. I am curious as to what this project looks like. Can you please provide some details?

Also, I hope they will address their lights on the north side of their building that shine directly into my house. I asked them a year and a half ago to please address them with some sort of deflector or shield so it only shines on their property. We are moving into

our house in about 60 days and their bright lights are an annoyance to put it mildly.

Thank you for your time and I look forward to hearing from you.

Tim O'Connor

Sent from my iPhone

**From:** [Jennifer Hall](#)  
**To:** [REDACTED]; [Paul Michaud](#)  
**Cc:** [Jennifer Hall](#); [Kayla Bertoldo](#)  
**Subject:** RE: SPR Renovations  
**Date:** Wednesday, February 8, 2023 12:51:05 PM  
**Attachments:** [image077855.png](#)  
[image740601.png](#)  
[image612827.png](#)

---

**External  
email: use  
caution  
with links  
&  
attachments**

Hello Kay,

Thanks for your email - I'm happy to provide you with an update on the project.

As mentioned in the notification letter you received. Highgate recently purchased Scottsdale Plaza Resort and they are proposing much needed improvements and renovations to the existing buildings to breathe new life into this mature resort property. Included in the improvements: 64 additional hotel rooms, three new signature restaurants, new Spa with café, new Lobby pavilion, a redesigned resort pool, freshly painted exterior finishes for all existing buildings, and undergrounding of select parking.

Highgate is a leader in the hospitality investment and management industry. You can read more about them here - <https://www.highgate.com/>

Our team is currently processing an amendment to the Special Use Permit to allow the improvements which will go through a series of public hearings before final decision by Town Council.

Planning Commission Work session: 2/7/23  
Planning Commission Work session: 2/21/23  
Planning Commission Recommendation: 3/7/23  
Town Council Work session: TBD (March/April)  
Town Council Work session: TBD (April/May)  
Town Council Final Decision: TBD (May/June)

You had an incorrect email address for Town Staff so I copied Paul Michaud, Planning Manager, on this email so he may provide additional information.

Thanks again for your interest and support in the project. Please feel free to ask me any questions or request specific information. I'll keep you posted on our progress, thanks!

Jennifer Hall

Senior Project Manager  
Rose Law Group pc  
7144 E Stetson Drive, Suite 300, Scottsdale, AZ 85251  
Direct: 480.505.3938

Fax: 480.505.3925

Mobile:



[roselawgroup.com](http://roselawgroup.com)

[roselawgroupreporter.com](http://roselawgroupreporter.com)

[@roselawgroup](#)

[@roselawgroupmeta](#)

RLG is Service :: Winner "Best places to work in Arizona"

The author of this email is not an attorney. This communication does not constitute legal advice and should not be construed as such. The information contained in this message is privileged and confidential. It is intended only to be read by the individual or entity named above or their designee. If the reader of this message is not the intended recipient, you are on notice that any distribution of this message, in any form is strictly prohibited. If you have received this message in error, please immediately notify the sender by telephone at 480.505.3936 or fax 480.505.3925 and delete or destroy any copy of this message. Thank you.

Think green, please don't print unnecessarily

**Jennifer Hall**  
Senior Project Manager



7144 E Stetson Drive, Suite 300, Scottsdale, AZ 85251

Direct: 480.505.3938 Fax: 480.505.3925 Mobile: [REDACTED]



[roselawgroup.com](http://roselawgroup.com) [roselawgroupreporter.com](http://roselawgroupreporter.com)

[@roselawgroup](https://twitter.com/roselawgroup) [@roselawgroupmeta](https://twitter.com/roselawgroupmeta)

RLG is Service :: Winner "Best places to work in Arizona"

The author of this email is not an attorney. This communication does not constitute legal advice and should not be construed as such. The information contained in this message is privileged and confidential. It is intended only to be read by the individual or entity named above or their designee. If the reader of this message is not the intended recipient, you are on notice that any distribution of this message, in any form is strictly prohibited. If you have received this message in error, please immediately notify the sender by telephone at 480.505.3936 or fax 480.505.3925 and delete or destroy any copy of this message. Thank you.

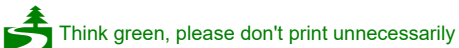

-----Original Message-----

From: KAY E BOWMAN [REDACTED]

Sent: Wednesday, February 8, 2023 9:34 AM

To: pmichaud@paradiseeyaz.gov; Jennifer Hall <JHall@roselawgroup.com>

Subject: SPR Renovations

Good morning

We are excited about the upcoming renovations. Is it possible to get an update? We were not able to attend recent meeting on Feb 6. Having recently built and taken occupancy of our home in neighboring Azure, it's fantastic news learning of all improvements to the area.

Kay Bowman

**From:** Julien Di Ciano <[julien@fountainhill.ca](mailto:julien@fountainhill.ca)>

**Sent:** Tuesday, February 7, 2023 12:44 PM

**To:** Jennifer Hall <[JHall@roselawgroup.com](mailto:JHall@roselawgroup.com)>; [pmichaud@paradisevalleyaz.gov](mailto:pmichaud@paradisevalleyaz.gov)

**Subject:** SPR notification letter

Good afternoon Jennifer and Paul. I am the homeowner at 6838 N Rocking Road. I have received the letter regarding The Scottsdale Plaza Resort.

I am fully supportive of this rejuvenation effort by the hotel.

I look forward to seeing it completed.

Kind Regards,

Julien Di Ciano  
6838 N. Rocking Road



# Community Outreach Report

---



THE SCOTTSDALE  
**PLAZA**  
RESORT

7200 N Scottsdale Road  
Scottsdale, AZ 85253

Prepared By:

**ROSE LAW GROUP<sup>pc</sup>**  
**RICH • CARTER • FISHER**

Jennifer Hall, Sr Project Manager  
7144 E. Stetson Drive, #300  
Scottsdale, AZ 85251  
480-505-3938  
[jhall@roselawgroup.com](mailto:jhall@roselawgroup.com)

December 2022  
February 7, 2023

## **Project Proposal**

The Applicant, 7200 SCOTTSDALE RD OWNER LP, is proposing to amend the Special Use Permit to renovate and renew The Scottsdale Plaza Resort, a 36-acre property located at 7200 N Scottsdale Road, Scottsdale AZ 85253 (Maricopa County Assessor Parcel Numbers: 174-49-001B, 174-49-001A, 174-49-002A). The amendment will allow for 64 additional hotel rooms, three new signature restaurants, new Spa and Café, new Lobby Pavilion, a redesigned resort pool, freshly painted exterior elevations for all existing buildings, and undergrounding of select parking.

## **Community Outreach Plan**

The Applicant team is proposing to host 2 public meetings: the first meeting for immediate residential neighbors - "Neighbor Reception" meeting and the other Community Meeting with all property owners within 1500 ft of the Resort property.

## **Notification Area Map**

Attached please find the Neighbor Reception map outlining the 59 adjacent residential neighbors who were invited to the Neighbor Reception held on October 3, 2022. Also attached is the required 1500-foot buffer map for all property owners within 1500 ft of the Resort to be invited to the Community Meeting scheduled for February 6, 2023.

## **Contacted Parties**

The contact mailing lists consisting of the adjacent residential neighbors as well as property owners within 1500 feet of the proposed site are both attached. Property ownership for both mailing lists was determined based on records obtained from the Maricopa County Assessor's website.

## **Contact Dates and Methods**

59 Invitations were mailed via First Class U.S. Mail postmarked September 22, 2022 to the neighbors mentioned above, and included notification of the Applicant's plan to renovate the Scottsdale Plaza Resort. The neighbors were invited to join the Applicant's Team for an in-person Open House meeting on 10/03/22 to learn about the renovation plans. A copy of the invitation is attached.

Notification letters for the upcoming Community Meeting on February 6, 2023 were mailed via First Class U.S. Mail on 1/24/23 to the 419 property owners within 1500 ft buffer.

## **Community Meetings**

### **Neighbor Reception Summary**

A Neighbor Reception was held on October 3, 2022 from 5:00PM – 6:00PM at The Scottsdale Plaza Resort Camelback Vista. The neighbors were invited to the Reception to meet the new ownership team and learn about the proposed and much needed improvements planned for the Resort property. There were 3 attendees at the meeting as documented on the Neighbor Reception sign in sheet. The meeting began with an introduction from the Applicant team and slideshow presentation explaining the request and details of the project. Following the presentation, the Applicant team encouraged the attendees to ask any questions and voice any comments they had regarding the project. The attendees had questions about construction timing but were overall very excited for the future

improvements and renovations to the property.

### **Community Open House Meeting Summary**

The Applicant team held the required Community Meeting with property owners within 1500 ft of the Resort on February 6, 2023 in the Camelback Vista building (old Remingtons) on the property.

Applicant Team in Attendance:

- Dina Winder – Highgate, Sr VP of Asset Management
- Martin Greenwood – Highgate, VP of Operations
- Jordan Rose - Rose Law Group
- Peter Furlow - Rose Law Group
- Jennifer Hall - Rose Law Group, Sr Project Manager
- Kayla Bertoldo – Rose Law Group, Project Coordinator
- Paul Basha – Summit Land Mgt, Traffic Engineer

The meeting began at 6:00PM and there were 13 members of the public signed in. Also in attendance was Planning Commissioner Chairman Jim Rose as well as Paul Michaud, PV Planning Manager.

Jordan Rose introduced the Applicant team and provided an overview of the entitlement process and status of the formal application to amend the Resort's SUP. Dina Winder presented the proposed improvements and renovations to the group in a detailed powerpoint presentation. After the presentation, Dina opened the meeting up for general questions. Questions from the audience included the following:

Who is Highgate?

What about parking?

Are you changing access to the property?

What improvements to Indian Bend Rd?

Will there be access on Indian Bend Rd?

What is the new branding/name?

Are you removing conference meeting parking?

What is happening to the existing bar/restaurant?

What size are the new restaurants?

Who runs the new restaurants?

Will you have to close down Indian Bend during construction?

What is the construction timeline?

Will you close down the resort during construction?

How tall are new buildings?

Will there be neighbor discounts for new spa?

What is happening to tennis courts?

Will there a new signal at Hummingbird?

All questions were answered. Paul Basha, traffic engineer, took questions from the audience and provided responses at approximately 6:40PM. After questions, attendees were invited to tour a newly renovated suite on the property. Only 4 members of the public viewed the renovated suite and all were extremely complimentary of the new trendy, hip

look. The overall feeling of the meeting was positive and neighboring residents are excited about the updates and improvements. They were quite pleased to hear that the new buildings will be no more than 2 stories and there will be no impacts to Indian Bend Rd. The meeting ended at approximately 7:10PM. Please see sign in sheet attached with this Report along with a support email received from a neighboring property owner.

**Ongoing Communication with Neighbors and Interested Parties**

The Applicant Team has sent follow up emails to neighbors who have reached out for more information and will continue to work to ensure all comments are received and documented. The proposed improvements and renovations are much needed to re-energize one of PV's oldest resorts and bring new life to the property and the Applicant team is extremely excited to share this application with the general public.

# NOTICING MATERIALS

# THE ARIZONA REPUBLIC

PO Box 194, Phoenix, Arizona 85001-0194

Phone 1-602-444-7315

Fax 1-877-943-0443

This is not an invoice

PNI-Scottsdale North Z8

## AFFIDAVIT OF PUBLICATION

**TOWN OF PARADISE VAL  
6401 E LINCOLN DR  
PARADISE VALLEY, AZ 85253-4328**

**This is not an invoice**

Order # 0005658244 # of Affidavits 1

P.O #

Issues Dated:

04/15/23

**STATE OF WISCONSIN }  
COUNTY OF BROWN } SS.**

I, being first duly sworn, upon oath deposes and says: That I am the legal clerk of the Arizona Republic, a newspaper of general circulation in the counties of Maricopa, Coconino, Pima and Pinal, in the State of Arizona, published weekly at Phoenix, Arizona, and that the copy hereto attached is a true copy of the advertisement published in the said paper in the issue(s) dated indicated.



Sworn to before me this

15 TH day of  
APRIL 2023

  
\_\_\_\_\_  
Notary Public

My Commission expires: 9/19/25

### NOTICE OF PUBLIC HEARING TOWN OF PARADISE VALLEY

Notice is hereby given that the Town of Paradise Valley Planning Commission will hold a public hearing at 6:00 p.m. on Tuesday, May 2, 2023, at Town Hall, 6401 East Lincoln Drive, Paradise Valley, Arizona, 85253 for:

**PUBLIC HEARING:** Discussion and possible action of an Intermediate Special Use Permit amendment (SUP-23-02) of the 36.5-net acre Scottsdale Plaza Resort located at 7200 N Scottsdale Road (Maricopa County Assessor Numbers 174-49-001A, 174-49-001B, and 174-49-002A) submitted by Rose Law Group, P.C., on behalf of 7200 Scottsdale Rd Owner LP, a Delaware limited partnership (being the hospitality investment & management company called Highgate).

The proposal includes similar uses (guest units, meeting spaces, spa, pool/sport court, lobby/administrative offices, and food/beverage) to the existing resort, with the redevelopment focused on the east portion of the site located near Scottsdale Road. The request generally includes 64 additional guest units (an increase from 404 to 468 units with no for-sale product), three new signature restaurants, new spa with café including second-level pool area, new lobby pavilion, redesigned resort pool, freshly painted exterior/interior renovation for all existing buildings, enhanced landscaping and lighting, signage, underground parking, and improvements to site infrastructure.

If you have questions about this application, please call Planning Manager Paul Michaud at (480) 348-3574.

The Town of Paradise Valley endeavors to make all public meetings accessible to persons with disabilities. With 72 hours advance notice, special assistance can be provided for disabled persons at public meetings. Please call 480-948-7411 (voice) or 483-1811 (TDD) to request accommodation.

Notice is hereby given pursuant to A.R.S. §38-431.02 that members of the Planning Commission may attend by audio/video conference call.

All agendas are subject to change. You can view the agenda, find application material, and provide your input via eComment approximately 4-6 days prior to the meeting date at <https://paradisevalleyaz.legistar.com/Calendar.aspx>. You may also contact the staff liaison, Paul Michaud on this application at [pmichaud@paradisevalleyaz.gov](mailto:pmichaud@paradisevalleyaz.gov) or 480-348-3574 at any time before the scheduled meeting date.  
Pub: Apr 15, 2023

VICKY FELTY  
Notary Public  
State of Wisconsin

**AFFIDAVIT OF MAILING NOTIFICATION**

STATE OF ARIZONA )

) ss:

County of Maricopa )

In accordance with the requirements of the Town of Paradise Valley, the undersigned hereby certifies that the mailing list for the proposed project is a complete list of property owners within 1900 feet of the subject property, as obtained from the Maricopa County Assessor's Office on the following date April 5, 2023, and such notification has been mailed on the following date April 13, 2023.

[Signature]  
Signature

The foregoing instrument was acknowledged by me this 13<sup>th</sup> day of April, 2023, by Kayla Bertoldo.  
Name

[Signature]  
NOTARY PUBLIC

My commission expires:  
MARCH 24, 2025





April 5, 2023

Paul Michaud  
Planning Manager  
Town of Paradise Valley  
6401 E. Lincoln Drive  
Paradise Valley, AZ 85253

## NOTIFICATION OF PLANNING COMMISSION PUBLIC HEARING

Dear Resident:

This letter is being sent to advise you an upcoming public hearing for an amendment to the Special Use Permit zoning at the Scottsdale Plaza Resort. Mailing notification is being sent to property owners within 1,500 feet of the proposed request. The Planning Commission makes a recommendation to Town Council. Notification of the Town Council public hearing will be mailed at a later date.

Notice is hereby given that the **Town of Paradise Valley Planning Commission will hold a public hearing at 6:00 p.m. on Tuesday, May 2, 2023**, at Town Hall, 6401 East Lincoln Drive, Paradise Valley, Arizona, 85253 for:

**PUBLIC HEARING:** Discussion and possible action of an Intermediate Special Use Permit amendment (SUP-22-02) of the 36.5-net acre Scottsdale Plaza Resort located at 7200 N Scottsdale Road (Maricopa County Assessor Numbers 174-49-001A, 174-49-001B, and 174-49-002A) submitted by Rose Law Group, P.C., on behalf of 7200 Scottsdale Rd Owner LP, a Delaware limited partnership (being the hospitality investment & management company called Highgate).

The proposal includes similar uses (guest units, meeting spaces, spa, pool/sport courts, lobby/administrative offices, and food/beverage) to the existing resort, with the redevelopment focused on the east portion of the site located near Scottsdale Road. The request includes 64 additional guest units (an increase from 404 to 468 units with no for-sale product), three new signature restaurants, new spa with café including second-level pool area, new lobby pavilion, redesigned resort pool, freshly painted exterior/interior renovation for all existing buildings, enhanced landscaping and lighting, signage, underground parking, and improvements to site infrastructure.

If you have questions about this application, please call Planning Manager Paul Michaud at (480) 348-3574.

Sincerely,

Paul Michaud  
Planning Manager



The Town of Paradise Valley endeavors to make all public meetings accessible to persons with disabilities. With 72 hours advance notice, special assistance can be provided for disabled persons at public meetings. Please call 480-948-7411 (voice) or 483-1811 (TDD) to request accommodation.

Notice is hereby given pursuant to A.R.S. §38-431.02 that members of the Town Council may attend by audio/video conference call.

All agendas are subject to change. You can view the agenda, find application material, and provide your input via eComment approximately 4-6 days prior to the meeting date at <https://paradisevalleyaz.legistar.com/Calendar.aspx>. You may also contact the staff liaison, Paul Michaud on this application at [pmichaud@paradisevalleyaz.gov](mailto:pmichaud@paradisevalleyaz.gov) or 480-348-3574 at any time before the scheduled meeting date.

3BP1 LLC  
9596 E POINSETTIA DR SCOTTSDALE AZ USA  
85260

6840 AVENIDA EL ALBA LLC  
PO BOX 7787 ASPEN CO USA 81612

6847 JOSHUA TREE LLC  
182 RACE ST DENVER CO USA 80206-4611

6883 E JOSHUA TREE LN LLC  
6883 E JOSHUA TREE LN PARADISE VALLEY AZ  
USA 85253

7000 EAST LINCOLN RESORT COMMUNITY  
PARCEL B RESIDENTIAL ASSOCIATION  
1600 W BROADWAY RD STE 200 TEMPE AZ USA  
85282

7200 SCOTTSDALE RD OWNER LP  
3953 MAPLE AVE STE 300 DALLAS TX USA 75219

869563 ALBERTA LTD  
1111-3 AVENUE S LETHBRIDGE AB CANADA  
T1J0J5

ADAMS BEECHER P/CAROL R  
5828 E CACTUS WREN RD PARADISE VALLEY AZ  
USA 85253

APORIA LLC  
350 E VIRGINIA AVE SUITE 100 PHOENIX AZ USA  
85004

ARGENT REVOCABLE TRUST  
PO BOX 4170 INCLINE VILLAGE NV USA 89450

ARMSTRONG CHRISTOPHER/STEPHANIE  
6850 N 72ND PL SCOTTSDALE AZ USA 85250

ARSANJANI REZA/KILIAN CAROLINE  
6848 E MEADOWLARK LN PARADISE VALLEY AZ  
USA 85253

ARTESIA DEVELOPMENT PARTNERS LLC  
8800 E RAINTREE DR STE 300 SCOTTSDALE AZ  
USA 85260

ASCENSION LUTHERAN CHURCH INC PARADISE  
VALLEY ARIZONA  
7100 N MOCKINGBIRD LN PARADISE VALLEY AZ  
USA 85253

ASCHERL GEORGE F JR/GEORGE F III  
7537 E MCDONALD DR SCOTTSDALE AZ USA  
85250

AZADEH HAFEZ  
9116 N FOOTHILLS MANOR DR PARADISE  
VALLEY AZ USA 85253

BABINS ERIC M/GOLD-BABINS BONNY  
1316 CARYLE RD SW CALGARY AB CANADA  
T2V2T8

BAGAI RAKESH/RIDDHIMA  
7373 N 71ST PL PARADISE VALLEY AZ USA 85253

BAIN FAMILY TRUST  
7117 N 68TH PL PARADISE VALLEY AZ USA  
85253

BAIRD HAL C/BEVERLY  
119 S 10TH ST APT 605 BOISE ID USA 83702

BALOW ROSEANN G  
6767 E ARROYO CT PARADISE VALLEY AZ USA  
85253

BARBE CHAD/KENNETH JR  
PO BOX 2107 ROSWELL NM USA 88202

BARBEE FAMILY TRUST  
7611 N MOCKINGBIRD LN PARADISE VALLEY AZ  
USA 85253

BARCLAY FAMILY TRUST  
7275 N SCOTTSDALE RD UNIT 1009 SCOTTSDALE  
AZ USA 85253-2606

BAZAN MARIANNE  
PO BOX 6574 SCOTTSDALE AZ USA 85261

BEAMER RICHARD S/PATRICIA A  
4821 LAKE WASHINGTON BLVD S SEATTLE WA  
USA 98118-1550

BERNARD G RETHORE LIVING TRUST  
7010 E AVENIDA EL ALBA PARADISE VALLEY AZ  
USA 85253

BERTRAM BRIAN D/PAIGE K  
6863 E JOSHUA TREE LN PARADISE VALLEY AZ  
USA 85253

BEUCUS ELIZABETH L TR/ROBERT W  
6824 AVENIDA EL ALBA PARADISE VALLEY AZ  
USA 85253

BHATIA ANAND/AMRITA  
8770 E HIGH POINT DR SCOTTSDALE AZ USA  
85266

BINDI LIVING TRUST  
312 ARIAS ST SAN RAFAEL CA USA 94903-3351

BISSELL CAROLINE VIRGINIA TR  
7231 E CACTUS WREN RD SCOTTSDALE AZ USA  
85250

BLAIK ROBERT M/DOROTHY E  
7291 N SCOTTSDALE RD UNIT 2005 SCOTTSDALE  
AZ USA 85253

BLAKEMAN BRADLEY A  
6701 N SCOTTSDALE RD LOT 28 SCOTTSDALE AZ  
USA 85250

BLUMETTI FAMILY TRUST  
6939 E HUMMINGBIRD LN PARADISE VALLEY AZ  
USA 85253

BMTR LLC  
4812E E BLUEFIELD AVE SCOTTSDALE AZ USA  
85254

BOUCHER REBECCA  
7027 N SCOTTSDALE RD UNIT 223 PARADISE  
VALLEY AZ USA 85253

BOWEN MARCUS  
6802 N 72ND PL SCOTTSDALE AZ USA 85250

BOWMAN DARREN B/KAY E  
6898 E JOSHUA TREE LN PARADISE VALLEY AZ  
USA 85253

BRADLEY IAN/VALERIE  
14003 77 AVE EDMONTON AB CANADA T5R3B2

BRANDT TYLER ALLEN  
2508 ROSE CREEK PKWY S FARGO ND USA  
58104

BRIAN A BROOKS AND TAMBRA L BROOKS  
TRUST  
3225 FAIRWAY CT MORGAN HILLS CA USA  
95037

BRIAN A WEINBERGER LIVING TRUST  
7249 E JOSHUA TREE LN SCOTTSDALE AZ USA  
85250

BRUMMER ROBERT/LORI  
1106 SIEMER DR DENISON IA USA 51442

BRUSHA GENCI/PATRICIA  
2425 E CHARLENE PL PHOENIX AZ USA 85024

BTSH FAMILY TRUST  
6902 E HUMMINGBIRD LN PARADISE VALLEY AZ  
USA 85253

BUA JOSEPH  
7297 N SCOTTSDALE RD UNIT 1001 PARADISE  
VALLEY AZ USA 85253

BUNCH HENRY S/KAREN LYNN  
6815 E CAMELBACK RD UNIT 2023 SCOTTSDALE  
AZ USA 85251

BURKE STEPHEN/PATRICIA  
7275 N SCOTTSDALE RD UNIT 1003 PARADISE  
VALLEY AZ USA 85253

BURNHAM JOHN P  
7027 N SCOTTSDALE RD STE 215 PARADISE  
VALLEY AZ USA 85253-3687

CALAMITO LUCETTE G  
6829 N 72ND PL SCOTTSDALE AZ USA 85250

CALDWELL CAITLIN BACHER  
6400 E THOMAS RD APT 1051 SCOTTSDALE AZ  
USA 85251

CAMPBELL NATALEE SIMONE  
6760 E ARROYO CT PARADISE VALLEY AZ USA  
85253

CANAD MANOR AZ INC  
3RD-930 JEFFERSON AVE WINNIPEG MB  
CANADA R2P 1W1

CAREFOOT ANNE V S  
7291 N SCOTTSDALE RD UNIT 4011 PARADISE  
VALLEY AZ USA 85253

CAREY ROBERT B/GRETCHEN K  
6708 E EXETER BLVD SCOTTSDALE AZ USA  
85251

CARTER INVESTMENTS PARTNERSHIP USA  
215-1300 8 ST SW CALGARY AB CANADA T2R  
1B2

CASHMAN SUSAN E/VITO JAMES M  
7437 N 71ST ST PARADISE VALLEY AZ USA 85253

CAVELL ARIZONA INC  
900 10310 JASPER AVE EDMONTON AB CANADA  
T5J1Y8

CHENEY DR LLC  
7505 N 70TH ST PARADISE VALLEY AZ USA  
85253

CHENEY HOLDINGS LLC  
6905 E CHENEY DR PARADISE VALLEY AZ USA  
85253

CHESIN MATTHEW  
7027 N SCOTTSDALE RD NO 222 PARADISE  
VALLEY AZ USA 85253

CHRISTINE H SODERQUIST LIVING TRUST  
7302 E JOSHUA TREE LN SCOTTSDALE AZ USA  
85250

CHUN WOOKJIN/MOON MINSOO  
7004 E AVENIDA EL ALBA PARADISE VALLEY AZ  
USA 85253

CLAUDIA LUCAIRE LIVING TRUST  
7408 E ONYX CT SCOTTSDALE AZ USA 85258

CLIFFORD AND BIBI DURGANA LIVING TRUST  
22113 N 31ST ST PHOENIX AZ USA 85050

CLS TRUST  
PO BOX 45515 PHOENIX AZ USA 85064-5515

CMXII HOLDINGS LLC  
631 N STEPHANIE ST NO 343 HENDERSON NV  
USA 89014

COHN JAMES M/LINDA BETH  
7100 E Lincoln Drive  
Paradise Valley, AZ 85253

COUTELIN DOREEN  
7246 E JOSHUA TREE LN SCOTTSDALE AZ USA  
85250

CRAIG LANCE A  
4148 STONEYBROOK LN PORT ARTHUR TX USA  
77642

CRAIK DAVID L/VIOLET  
9025 N FLYING BUTTE DR FOUNTAIN HILLS AZ  
USA 85268

CUERNAVACA HOMEOWNERS ASSOC INC  
16625 S DESERT FOOTHILLS PKWY PHOENIX AZ  
USA 85048

CWH REVOCABLE TRUST  
7241 E JOSHUA TREE LN SCOTTSDALE AZ USA  
85250

DAKAJOS JOHN/DEBORAH  
7003 E AVENIDA EL ALBA PARADISE VALLEY AZ  
USA 85253

DAVIS RICHARD K/THERESA A  
7018 N 69TH PL PARADISE VALLEY AZ USA  
85253

DE LA ROSA ANTONIO/NICOLE TR  
7027 E VISTA DR PARADISE VALLEY AZ USA  
85253

DEMPSEY PATRICK F/NATALIE A  
16W719 HILLSIDE LN WILLOWBROOK IL USA  
60527

DENNIS A MITCHELL REVOCABLE TRUST  
1360 POINT O WOODS DR BENTON HARBOR MI  
USA 49022-9428

DENNISON NINA  
7291 N SCOTTSDALE RD UNIT 3004 PARADISE  
VALLEY AZ USA 85253

DERMIT FAMILY TRUST  
11231 NE 116TH PL KIRKLAND WA USA 98034

DESERT VIKING SPECTRUM LLC  
3002 E WASHINGTON ST PHOENIX AZ USA  
85034

DHAMIIA ROHIT/CATHERINE R  
2281 WUTHERING HEIGHTS WY OAKVILLE ON  
CANADA L6M0A6

DIAZ ALEXIS MARIE  
PO BOX 5130 SNOWMASS VILLAGE CO USA  
81615

DICIANO JULIEN D  
101-200 RONSON DR ETOBICOKE ON CANADA  
M9W 5Z9

DIGBY DONALD TR  
1400 W 64TH AVE DENVER CO USA 80221

DISQUE FAMILY TRUST  
9215 N AMERICAN RANCH RD PRESCOTT AZ  
USA 86305

DJAHANDIDEH FARADJOLLAH F  
7275 N SCOTTSDALE RD STE 1008 SCOTTSDALE  
AZ USA 85253

DJSJ 4007 LLC  
6983 E NORTHERN AVE PARADISE VALLEY AZ  
USA 85253

EBERLE VIVIAN FAMILY LIVING TRUST  
6823 E AVENIDA EL ALBA PARADISE VALLEY AZ  
USA 85253

ECONOMOS SOPHIA  
6838 E OAK ST SCOTTSDALE AZ USA 85257

EDELSTEIN CAREN J  
7291 N SCOTTSDALE RD UNIT 1009 PARADISE  
VALLEY AZ USA 85253

EFUNE HILTON/MELANIE A TR  
7140 E BLUEBIRD LN PARADISE VALLEY AZ USA  
85253

EILEEN ELLENS LIVING TRUST  
670 OLD ORCHARD RD HOLLAND MI USA 49423

ELK ESTATES LLC  
15215 S 48TH ST STE 139 PHOENIX AZ USA  
85044

EMILEE A MARKMAN TRUST  
7291 N SCOTTSDALE RD UNIT 2006 PARADISE  
VALLEY AZ USA 85253

ENCK SCOTT/EMILY J  
31722 12TH PLACE SW FEDERAL WAY WA USA  
98023

ESPOSITO DONNA M TR  
7027 N SCOTTSDALE RD 108 SCOTTSDALE AZ  
USA 85253

EW17-MOF-JV SEVILLE LLC  
PO BOX 460189 DEPT 126 HOUSTON TX USA  
77056

FARZAD KHAMOOSHI TRUST  
6830 N 72ND PL SCOTTSDALE AZ USA 85250

FATEMA KHATIB-SHAHIDI REVOCABLE TRUST  
7291 N SCOTTSDALE RD UNIT 3016 SCOTTSDALE  
AZ USA 85253

FERRARO JOSEPH P  
7035 N 69TH PL PARADISE VALLEY AZ USA  
85253

FEUER FAMILY TRUST  
5353 N 16TH ST SUITE 105 PHOENIX AZ USA  
85016

FIVE STAR LAND OWNER LLC  
6720 N SCOTTSDALE RD STE 130 SCOTTSDALE  
AZ USA 85253

FIVE STAR RESORT OWNER LLC  
6720 N SCOTTSDALE RD SUITE 130 SCOTTSDALE  
AZ USA 85253

FLAMINGO REVOCABLE TRUST  
15215 N KIERLAND BLVD NO 735 SCOTTSDALE  
AZ USA 85254

FLETCHER S T TR  
7027 N SCOTTSDALE RD UNIT 123 SCOTTSDALE  
AZ USA 85253

FORSTER KARL D/ SALLY A TR  
6835 E MEADOWLARK LN PARADISE VALLEY AZ  
USA 85253

FRANCES R KIRSCHNER REVOCABLE TRUST  
7291 N SCOTTSDALE RD UNIT 3009 PARADISE  
VALLEY AZ USA 85253

FREDERICK PHILIP SNOW REVOCABLE  
TRUST/JENNIFER XUAN THANH SNOW  
REVOCABLE TRUST  
21 BEAUMONT ST FAIRFIELD CT USA 06824

FREDERICKSON FAMILY TRUST  
930 TAHOE BLVD STE 802 PMB 551 INCLINE  
VILLAGE NV USA 89451

FUREY JAMES H/VICKI H  
1221 SANTA BARBARA DR NEWPORT BEACH CA  
USA 92660-6371

FV CASA RESERVE LLC  
1013 ALTA CIR LOUISVILLE KY USA 40205

GAIDICI FLORIN/ADRIANA T TR  
7115 E MOCKINGBIRD LN PARADISE VALLEY AZ  
USA 85253

GAINES DEBORAH ANN  
4140 W PLACITA DEL MONTE TUCSON AZ USA  
85745

GARY D FROST AND KRISTINE M MARCHIONDA-  
FROST FAMILY TRUST  
6767 E BLUEBIRD LN PARADISE VALLEY AZ USA  
85253

GATELY CHRISTOPHER J  
7275 N SCOTTSDALE RD UNIT 1020 SCOTTSDALE  
AZ USA 85253-2616

GEOFFREY A COUCH FAMILY TRUST  
PO BOX 281 PEBBLE BEACH CA USA 93953

GERALD BUESING TRUST  
18972 N 98TH WAY SCOTTSDALE AZ USA 85255

GHANIABADI EFFIE K  
6820 N 73RD ST SCOTTSDALE AZ USA 85250

GIBBONS DALE  
7100 E VALLEY TRL PARADISE VALLEY AZ USA  
85253

GIGLIO GARY/PATRICIA  
6701 N SCOTTSDALE ROAD 21 SCOTTSDALE AZ  
USA 85253

GINA LYNN FRANKLIN REVOCABLE TRUST  
7027 N SCOTTSDALE RD NO 109 SCOTTSDALE AZ  
USA 85253

GINSBURG HOWARD L  
6934 E HUMMINGBIRD LANE PARADISE VALLEY  
AZ USA 85253

GLASCOCK BONSAI H/ALEXIS J TR  
7016 E HUMMINGBIRD LN PARADISE VALLEY AZ  
USA 85253

GLICK JACOB C  
7291 N SCOTTSDALE RD UNIT 4002 PARADISE  
VALLEY AZ USA 85253

GLORIA STAKEMILLER LIVING TRUST  
6924 E INDIAN BEND RD PARADISE VALLEY AZ  
USA 85253

GOLDSTEIN ALLISON  
7291 N SCOTTSDALE RD NO 2013 SCOTTSDALE  
AZ USA 85253

GOODWIN DYLAN E  
7027 N SCOTTSDALE RD STE 136 PARADISE  
VALLEY AZ USA 85253-3685

GORANSON FAMILY TRUST  
3305 E HUBER ST MESA AZ USA 85213

GREEN GULCH RANCH  
5640 E CABALLO DR PARADISE VALLEY AZ USA  
85253

GREEN ROBERT S/JILL S  
6695 E INDIAN BEND RD PARADISE VALLEY AZ  
USA 85253

GREGG AND DAPHNE WARREN 2015 FAMILY  
TRUST  
6914 E. CACTUS WREN RD. PARADISE VALLEY AZ  
USA 85253

GROSSMAN RESIDENCE TRUST  
6874 E JOSHUA TREE LN PARADISE VALLEY AZ  
USA 85253

GRUNTLER AUDREY R  
8648 CRICKET TREE LN INDIANAPOLIS IN USA  
46260

GTG INC  
231 SASKATCHEWAN AVE EAST  
PORTAGELAPRAIRIE MB CANADA R1N3B2

GUPTA JYOTHI/DIWAKAR/DIVYA  
7291 N SCOTTSDALE RD UNIT 4010 PARADISE  
VALLEY AZ USA 85253

HA RICHARD JUNEYOUNG/JEONG JAE  
9132 COUNTY ROAD 422 HANNIBAL MO USA  
63401-6819

HAMPSHIRE 2000 REVOCABLE TRUST  
7275 N SCOTTSDALE RD UNIT 1006 BLDG G2  
SCOTTSDALE AZ USA 85253

HARLAN STANLEY FLEECE JR LIVING TRUST  
7275 N SCOTTSDALE RD UNIT 1015 PARADISE  
VALLEY AZ USA 85253

HARRIS ALISA  
7027 N SCOTTSDALE RD UNIT 213 PARADISE  
VALLEY AZ USA 85253

HAWKINS JAMES B/MARY PAT  
1678 ORVIETO CT PLEASANTON CA USA 94566-  
6494

HAWKINS THOMAS/LINDA  
7275 N SCOTTSDALE RD UNIT 1016 PARADISE  
VALLEY AZ USA 85253

HAZZI ADRIAN J  
1133 PARKLOSS LN BRITISH COLUMBIA BC  
CANADA V1V 2Y3

HEARD GARFIELD  
7291 N SCOTTSDALE RD UNIT 2003 SCOTTSDALE  
AZ USA 85253

HEIER BERNARD/CONNIE  
3901 FIRETHORN CT LINCOLN NE USA 68520

HELEN Y CHANG FAMILY TRUST  
6945 E CHENEY DR PARADISE VALLEY AZ USA  
85253

HERNANDEZ JAIME/MASARYK ZUZANA E  
7027 N SCOTTSDALE RD SUITE 208 SCOTTSDALE  
AZ USA 85253-3687

HILL WALTER PAUL & SHIRLEY J  
6827 N 73RD ST SCOTTSDALE AZ USA 85253

HOLWAY RICHARD V/ROBIN J  
7036 N 69TH PL PARADISE VLY AZ USA 85253-  
4410

HOOD EDWARD J/COLLEEN  
7291 N SCOTTSDALE RD UNIT 2012 SCOTTSDALE  
AZ USA 85253

HORAN FAMILY TRUST  
7137 E BLUEBIRD LN PARADISE VALLEY AZ USA  
85253

HILLER INC  
1829 N FREDERIC ST  
WICHITA KS 67206

HORVAT CHRISTY M  
850 BONNIE BRAE BLVD DENVER CO USA 80209

HOWARD S CARNEY TRUST  
7275 N SCOTTSDALE RD UNIT 1010 SCOTTSDALE  
AZ USA 85253

HOWZE DENISE  
7291 N SCOTTSDALE RD UNIT 2014 PARADISE  
VALLEY AZ USA 85253

IBRAHIM WILLIAM/CARIE  
6823 N 73RD ST SCOTTSDALE AZ USA 85250

IFFLAND JAMIE M  
7027 N SCOTTSDALE RD SCOTTSDALE AZ USA  
85253

ILARDO SALVATORE/GRAZIA  
7291 N 71ST PL PARADISE VALLEY AZ USA 85253

INOUYE CRAIG S/ROBERSON CHARLOTTE  
5434 E LINCOLN DR NO 23 PARADISE VALLEY AZ  
USA 85253

ISBISTER FAMILY TRUST  
6311 CENTRE STREET SW CALGARY AB CANADA  
T2H0C7

JA IRREVOCABLE TRUST  
7155 E PARADISE CANYON RD PARADISE VALLEY  
AZ USA 85253

JACKSON GEORGE W JR  
29181 WOODCREST CT SOUTHFIELD MI USA  
48076

JACOBS CAROLE R  
8634 E ILIFF DR DENVER CO USA 80231-3809

JAINS NISHA MARY  
7291 N SCOTTSDALE RD UNIT 3012 SCOTTSDALE  
AZ USA 85253

JAMES R LAMON FAMILY LIVING TRUST  
7300 N 70TH ST PARADISE VALLEY AZ USA  
85253

JANECEK NATHAN  
8213 E REDWING RD SCOTTSDALE AZ USA  
85250

JASPER TRUST  
6925 E CHENEY DR PARADISE VALLEY AZ USA  
85253

JBS ARIZONA LLC  
5101 N CASA BLANCA DR UNIT 5 PARADISE  
VALLEY AZ USA 85253

JEAN ANN SMITH REVOCABLE TRUST  
6950 E CACTUS WREN RD PARADISE VALLEY AZ  
USA 85253

JEAN ANN SMITH REVOCABLE TRUST  
2350 S GILBERT RD CHANDLER AZ USA 85286

JERRY AND THORA BARKER FAMILY TRUST  
6923 E HUMMINGBIRD LN PARADISE VALLEY AZ  
USA 85253

JEWETT GREGORY P/LAURA L  
PO BOX 27874 SCOTTSDALE AZ USA 85255

JOHNSON CONSTANCE L  
7025 N SCOTTSDALE RD UNIT 139 SCOTTSDALE  
AZ USA 85253

JOSHUA & INETTE BROWN REVOCABLE TRUST  
2300 WOLF ST UNIT 12MC DALLAS TX USA  
75201

JUDITH A BRECKNER REVOCABLE TRUST  
4014 GRAINWOOD TRL NE PRIOR LAKE MN USA  
55372

JUDSON COMMUNITY ASSOCIATION  
PO BOX 15427 SCOTTSDALE AZ USA 85267

JURKIEWICZ MARK A/BOZENA K  
31947 N 63RD PL CAVE CREEK AZ USA 85331

KASS HOWARD E/JULIE E  
9220 BENTRIDGE AVE POTOMAC MD USA  
20854

KATZ NATALIE/LAWRENCE E TR  
6828 N 73RD ST SCOTTSDALE AZ USA 85250

KAZOKU HOLDINGS LLC  
12600 N 92ND PL SCOTTSDALE AZ USA 85260

KEILTY THOMAS  
6831 N 73RD ST SCOTTSDALE AZ USA 85250

KENNETH J WOOMER AND NIKI M WOOMER  
JOINT LIVING TRUST  
1600 SW DASH POINT RD STE B PMB 260  
FEDERAL WAY WA USA 98023

KENT REED NOBLE REVOCABLE TRUST/LESLIE  
SCARLETT NOBLE REVOCABLE TRUST  
6958 E JOSHUA TREE LN PARADISE VALLEY AZ  
USA 85253

KLEIN MARY PATRICIA/PACINO STEVEN C  
33900 LAKEDGE LN CHAGRIN FALLS OH USA  
44022

KLIBANOFF LIVING TRUST  
6929 E CHENEY DR PARADISE VALLEY AZ USA  
85253

KLIMEK JOHN S/DIANE M TR  
9304 KILREA DR ORLAND OARK IL USA 60462

KLING ASHLEY ROSE  
7027 N SCOTTSDALE RD UNIT 201 SCOTTSDALE  
AZ USA 85252

KLT HOLDINGS LLC  
22611 N 39TH TER PHOENIX AZ USA 85050

KOE BETTY  
6701 N SCOTTSDALE RD UNIT 29 SCOTTSDALE  
AZ USA 85250

KOHL CAROL J  
7027 N SCOTTSDALE RD 110 SCOTTSDALE AZ  
USA 85253

KOUROUGLOS REVOCABLE LIVING TRUST  
6814 E INDIAN BEND RD PARADISE VALLEY AZ  
USA 85253

KOZLOV ALEKSEY/KOZLOVA IRINA  
1322 91ST AVENUE NE CLYDE HILL WA USA  
98004



KRESICKI-OBERLE FAMILY TRUST  
4057 N MIRADA CIR MESA AZ USA 85207

KRIGEL JAMES E/FELICIA JON  
6854 E CACTUS WREN RD PARADISE VALLEY AZ  
USA 85253

KRISHNA SUNITA A  
86 BILTMORE ESTATES PHOENIX AZ USA 85016

KROL RICHARD G/SUZANNE M  
24365 N 72<sup>nd</sup> Way  
Scottsdale AZ 85255

KUBIAK LARISSA C  
7291 N SCOTTSDALE RD UNIT 1005 PARADISE  
VALLEY AZ USA 85253

KUSPER JUSTUS LIVING TRUST  
7275 N SCOTTSDALE RD #1014 PARADISE  
VALLEY AZ USA 85253

KYLES PATRICK J  
1711 DONOVAN AVE ELLINGHAM WA USA  
96225

LAURA A CAMERON LIVING TRUST  
7027 N SCOTTSDALE RD STE 218 PARADISE  
VALLEY AZ USA 85253-3687

LEROY PIERRE E  
6901 E JOSHUA TREE LN PARADISE VALLEY AZ  
USA 85253

LEVINE ROARK/JUDY  
76 ROBINSON HILL RD FRANKLIN CT USA 06254

LIEBERMAN DAVID A  
6112 E CORTEZ DR SCOTTSDALE AZ USA 85254

LILIEN FAMILY TRUST  
7140 E KIERLAND BLVD APT 520 SCOTTSDALE AZ  
USA 85254

LORRAIN A ETZEL AND ELLEN J ETZEL REV TRUST  
7027 N SCOTTSDALE RD STE 117 SCOTTSDALE  
AZ USA 85253-3683

LOVEJOY JEREMY O/COX-LOVEJOY SABRINA L TR  
7123 N 68TH PL PARADISE VALLEY AZ USA  
85253

LUDDEN WATSON TRUST  
1 ANNABEL LN SAN RAMON CA USA 94583

LYNCH LAND DEVELOPMENT LLC  
411 OVERLAND AVE BURLEY ID USA 83318

MAGGIO ANTHONY/CATHY  
7291 N SCOTTSDALE RD UNIT 3007 PARADISE  
VALLEY AZ USA 85253

MAKKAR AKASH/MEENAKSHI  
7005 N 68TH PL PARADISE VALLEY AZ USA  
85253

MANGRAM ALICIA J/ESTELIA  
7101 N 69TH PL PARADISE VALLEY AZ USA  
85253

MANN KENNETH L/JANET H  
6822 N 72ND PL SCOTTSDALE AZ USA 85250

MARELLA PUNNAIAH C/SIRIPURAPU  
SHANTIPRIYA  
7025 E CHENEY DR PARADISE VALLEY AZ USA  
85253

MARGO S POPOVICH INDIVIDUAL PROPERTY  
TRUST  
6386 SPRUCE MEADOWS LN LAND O LAKES WI  
USA 54540

MARIE SWAIM TRUST AGREEMENT  
7291 N SCOTTSDALE RD UNIT 4008 PARADISE  
VALLEY AZ USA 85253

MARK B GOODE REVOCABLE TRUST  
2876 FREDRIC CT NORTHBROOK IL USA 60062

MARK S MICHELINI AND DEBRA J MICHELINI  
REVOCABLE TRUST  
808 BLACK WALNUT DR SUGAR GROVE IL USA  
60554

MARTIN FAMILY TRUST  
835 TROPICAL CIRCLE SARASOTA FL USA 34242-  
1440

MARY A ELTON LIVING TRUST  
7027 N SCOTTSDALE RD UNIT 116 PARADISE  
VALLEY AZ USA 85253

MARY LYNN LIVING TRUST  
7297 N SCOTTSDALE RD UNIT 1004 PARADISE  
VALLEY AZ USA 85253

MARY SHEILA SMITH TRUST  
250 W SPRING ST APT 717 COLUMBUS OH USA  
43215

MASH JASON/HIZER CAROL S  
7291 N SCOTTSDALE RD UNIT 1012 PARADISE  
VALLEY AZ USA 85253

MCCORMICK RANCH GOLF CLUB INC  
7505 MCCORMICK PKWY SCOTTSDALE AZ USA  
85258

MCCRACKEN MALCOLM  
PO BOX 5053 WHITEFISH MT USA 59937

MERVIS ADAM J/KROACK LAUREL L  
2095 RESERVE WAY DECATUR IL USA 62521

MEYERS PHILLIP D/BARBARA J  
7123 E BLUEBIRD LN PARADISE VALLEY AZ USA  
85253-3639

MICHAEL OTHITES AND JOY OTHITES REV TRUST  
7045 N 69TH PL PARADISE VALLEY AZ USA  
85253

MILLER LEGACY HOMES LLC  
23016 N 19TH WAY PHOENIX AZ USA 85024

MILMOE WILLIAM H/JEANNE M  
180 NE 6TH AVE APT M DELRAY BEACH FL USA  
33483

MIRALAEFF GEORGE S SR TR  
6023 FOREST DR MORTRON GROVE IL USA  
60053

MIRCHANDANI PITU B  
7027 N SCOTTSDALE RD NO 230 SCOTTSDALE AZ  
USA 85253

MIT HOLDINGS LLC  
15720 N GREENWAY HAYDEN LOOP STE 1  
SCOTTSDALE AZ USA 85260

MITCHELL GARY/CONNIE  
6853 E MEADOWLARK LN PARADISE VALLEY AZ  
USA 85253

MKA FOUR LLC  
PO BOX 17202 PHOENIX AZ USA 85011

MORRIS THOMAS NORMAN/DENISE RUTH  
6930 E CACTUS WREN RD PARADISE VALLEY AZ  
USA 85253

MOWRY DEAN/NANCY  
6812 N 73RD ST SCOTTSDALE AZ USA 85250

MUNDHENKE GARY/MULLIGAN SUSAN L  
2615 S RIDGEVIEW WAY SIOUX FALLS SD USA  
57105

NAAB BRONSON/THOMPSON GRECIA  
14209 N 68TH ST SCOTTSDALE AZ USA 85254

NANCY WHITMAN DICKSON REVOCABLE TRUST  
6869 E CACTUS WREN RD PARADISE VALLEY AZ  
USA 85253

NASHIF DOUGLAS M/DIANA/DOUGLAS  
M/DIANE S  
6825 NORTH 72ND PLACE SCOTTSDALE AZ USA  
85250

NEKZAD SHOAIB/CHRISTIE M  
7291 N SCOTTSDALE RD UNIT 2002 PARADISE  
VALLEY AZ USA 85253

NELSON KELLY K  
7213 N 70TH ST PARADISE VALLEY AZ USA  
85253

NENAD FAMILY REVOCABLE LIVING TRUST  
6901 E CHENEY DR PARADISE VALLEY AZ USA  
85253

NERM LIVING TRUST  
7239 N MOCKINGBIRD LN PARADISE VALLEY AZ  
USA 85253

NEXT CHAPTER REAL ESTATE LLC  
6450 SAND LAKE RD STE 200 DAYTON OH USA  
45414

NIELSON DONALD L/VINI E TR  
7235 E CACTUS WREN RD SCOTTSDALE AZ USA  
85250

NOVIELLI KIMBERLY R  
5894 GLENEAGLES CIR SAN JOSE CA USA 95138

OCONNOR TIMOTHY P/JANET JANUARY  
PO BOX 4083 SCOTTSDALE AZ USA 85261

OGLE GWEN  
7291 N SCOTTSDALE RD UNIT 1002 PARADISE  
VALLEY AZ USA 85253

OKSANA ANN YUSUPOV QUALIFIED PERSONAL  
RESIDENCE TRUST/IGOR RICHARD YUSUPOV  
QUALIFIED PERSONAL RES TR  
7410 N 71ST PL PARADISE VALLEY AZ USA 85253

OLCHER KEN/BENNETT JENNIFER LYNN  
1607 W WHISPERING WIND DR PHOENIX AZ  
USA 85085

OLSEN LYNSIE  
7295 N SCOTTSDALE RD UNIT 1001 PARADISE  
VALLEY AZ USA 85253

ORANGE PENGUIN TRUST  
7275 N SCOTTSDALE RD UNIT 1017 PARADISE  
VALLEY AZ USA 85253-2616

ORCHID PARADISE LLC  
7009 E AVENIDA EL ALBA PARADISE VALLEY AZ  
USA 85253

ORRETT JENNIFER/ROSS  
6908 E HUMMINGBIRD LN PARADISE VALLEY AZ  
USA 85253

PARADISE VALLEY TOWN OF  
6401 E LINCOLN DR PARADISE VALLEY AZ USA  
85253

PATEL YATIN R  
7275 N SCOTTSDALE UNIT 1012 SCOTTSDALE AZ  
USA 85253

PEARL STEPHANIE RACHEL  
7027 N SCOTTSDALE RD NO 202 SCOTTSDALE AZ  
USA 85253

PHILIPOVITCH FAMILY TRUST  
3601 SPRINGBROOK ST DALLAS TX USA 75205

PIERCE ELIZABETH  
7291 N SCOTTSDALE RD NO 1001 SCOTTSDALE  
AZ USA 85253

PKS2 LLC  
2464 VINEYARD RD NOVATO CA USA 94947

PLENCNER RACHEL A  
16633 W LOMA ROJO CT SURPRISE AZ USA  
85387

POPICH ASHLEY/AMYRA L  
7027 N SCOTTSDALE RD SUITE 224 PARADISE  
VALLEY AZ USA 85253-3688

PRASIL FAMILY MATTERS LLC  
7275 N SCOTTSDALE RD UNIT 1007 PARADISE  
VALLEY AZ USA 85253

PRELL STEVEN J  
7291 N SCOTTSDALE RD UNIT 4013 SCOTTSDALE  
AZ USA 85253

PRICHARD WILLIAM/MARIAFRANCESCA  
7027 N SCOTTSDALE RD UNIT 130 PARADISE  
VALLEY AZ USA 85253

QAQISH IBRAHIM  
5625 E GROVERS AVE SCOTTSDALE AZ USA  
85254

RANDAL D VOSTI REVOCABLE TRUST  
904 LA TERRAZA CT MONTEREY CA USA 93940

RATUSHNY M SCOTT/MURDOCH LARA L  
81 ANATAPI LANE SW CALGARY AB CANADA  
T3H4G2

RCI WESTWAY LLC/KPN INDUSTRIAL LLC  
11225 W BERNARDO CT SUITE 100 SAN DIEGO  
CA USA 92127

REBECCA LEE BOWMAN TRUST  
6741 N INVERGORDAN RD PARADISE VALLEY AZ  
USA 85253

RED CEDAR TRUST  
7027 N SCOTTSDALE RD UNIT 212 PARADISE  
VALLEY AZ USA 85253

RETHORE BERNARD G/MICHELS SHIRLEY A  
7010 E AVENIDA EL ALBA PARADISE VALLEY AZ  
USA 85253

RICHARD DALE MUNSON REV TR/MUNSON  
CONSTANCE  
7298 N 71ST PL PARADISE VALLEY AZ USA 85253

RIVIERE M ELLIOT/MARGARET W  
6701 N SCOTTSDALE ROAD SCOTTSDALE AZ USA  
85250

RIZZO JOSEPH/DESPINA  
7291 N SCOTTSDALE RD UNIT 4009 PARADISE  
VALLEY AZ USA 85253

ROBBINS CAROL M  
7027 N SCOTTSDALE RD UNIT 214 SCOTTSDALE  
AZ USA 85253

ROBERT J AMMAN AND MARINA R AMMAN  
FAMILY TRUST  
6878 E CACTUS WREN RD PARADISE VALLEY AZ  
USA 85253

ROBERT M TAXIN LIVING TRUST  
6164 N LAS BRISAS DR PARADISE VALLEY AZ USA  
85253

ROBERT W STANTON IRREVOCABLE TRUST  
7181 N 68TH PL PARADISE VALLEY AZ USA  
85253

RODERICK S TERAUCHI AND REIKO TERAUCHI  
REVOCABLE TRUST  
2315 CEDAR ST EL CERRITO CA USA 94530

ROGERS JENNIFER CHRISTINE  
7027 N SCOTTSDALE RD UNIT 231 PARADISE  
VALLEY AZ USA 85253

ROLLINS TRUST  
251 KILIOOPU ST WAILUKU HI USA 96793

RONCK BRYAN/CATHERINE S  
4301 GLEN FALLS LN VAIL CO USA 81657

ROTTUNDA KURTIS/ADRIANA  
7027 N SCOTTSDALE RD UNIT 112 PARADISE  
VALLEY AZ USA 85253

RUDIN JEFFREY S/PEARLMAN VIVIAN A  
4830 HIGHBURY LN MINNETONKA MN USA  
55345

SAFIR DOV  
10632 N SCOTTSDALE RD 488 SCOTTSDALE AZ  
USA 85254

SAM MARCHESE TRUST  
1436 N 143RD AVE OMAHA NE USA 68154

SANDRA BRUINSMA FAMILY TRUST 2017  
18-24528 STURGEON RD STURGEON COUNTY  
AB CANADA T8T0A1

SANDRA L PRICE LIVING TRUST  
7250 E JOSHUA TREE LN SCOTTSDALE AZ USA  
85250

SANDS NORTH TOWNHOUSES  
1450 E INDIAN SCHOOL RD STE C PHOENIX AZ  
USA 85014

SANDS RESIDENTIAL LLC  
6130 W FLAMINGO RD STE 3006 LAS VEGAS NV  
USA 89103

SANDS RESIDENTIAL LLC  
6130 W FLAMINGO RD SUITE 3006 LAS VEGAS  
NV USA 89103

SANTUCCI FAMILY REVOCABLE TRUST  
6701 N SCOTTSDALE RD LOT 26 SCOTTSDALE AZ  
USA 85250

SAUNDERS JOSHUA  
6835 N 73RD ST SCOTTSDALE AZ USA 85250

SCC ARTESIA LLC  
3300 ENTERPRISE PARKWAY BEACHWOOD OH  
USA 44122

SCHALLER JOEL L  
7171 E PARADISE CANYON RD PARADISE VALLEY  
AZ USA 85253-3176

SCHECHTER LAVI  
7297 N SCOTTSDALE RD UNIT 1002 PARADISE  
VALLEY AZ USA 85253

SCOTTSDALE CITY OF  
7447 E INDIAN SCHOOL RD STE 205  
SCOTTSDALE AZ USA 85251

SCOTTSDALE OFFICE CENTER LLC  
660 NEWPORT CENTER DR STE 1300 NEWPORT  
BEACH CA USA 92660

SCOTTSDALE SPECTRUM LLC  
6730 N SCOTTSDALE RD SCOTTSDALE AZ USA  
85253

SCRIBNER FAMILY TRUST  
6969 E PARADISE RANCH RD PARADISE VALLEY  
AZ USA 85253

SETOODEH ABRAHIM/SHAHAZ ASHLEY P  
7407 N 71ST PL PARADISE VALLEY AZ USA 85253

SHARON B SIEGEL REVOCABLE TRUST  
6983 E PARADISE RANCH RD PARADISE VALLEY  
AZ USA 85253

SHARON E IVES REVOCABLE TRUST  
7027 N SCOTTSDALE RD UNIT 240 SCOTTSDALE  
AZ USA 85253

SHEA HOMES LTD PARTNERSHIP  
8800 N GAINES CENTER DR STE 350  
SCOTTSDALE AZ USA 85258

SHORT ELIZABETH BADER  
7447 E SIERRA VISTA DR SCOTTSDALE AZ USA  
85250

SHUKUFUKU LLC  
12600 N 92ND PL SCOTTSDALE AZ USA 85260

SIEVERS AMANDA/LINGER ALEXA  
7310 E JOSHUA TREE LN SCOTTSDALE AZ USA  
85250

SINGER ROBERT/CYNTHIA MACDONALD  
6842 E HUMMINGBIRD LN PARADISE VALLEY AZ  
USA 85253

SK/MK TRUST  
6997 E PARADISE RANCH RD PARADISE VALLEY  
AZ USA 85257

SMITH REVOCABLE LIVING TRUST  
6615 N 39TH WAY PARADISE VALLEY AZ USA  
85253

SO MABEL/RONALD  
6701 N SCOTTSDALE RD NO 25 SCOTTSDALE AZ  
USA 85250

SO RONALD/MABEL  
6701 N SCOTTSDALE RD LOT 25 SCOTTSDALE AZ  
USA 85250-4404

SORENSEN PARADISE ESTATE LLC  
8702 N 65TH ST PARADISE VALLEY AZ USA  
85253

SORENSEN SCOTTSDALE ESTATE LLC  
8702 N 65TH ST PARADISE VALLEY AZ USA  
85253

SPRANDO PATRICIA L  
7257 SW ETON CT PORTLAND OR USA 97225

ST BARNABAS OF THE DESERT  
6715 N MOCKINGBIRD LN SCOTTSDALE AZ USA  
85253

ST PIERRE CASEY  
7027 N SCOTTSDALE RD UNIT 205 PARADISE  
VALLEY AZ USA 85253

STAMPS MICHAEL RAY TR/BEATRIZ GARCIA TR  
7115 N 69TH PL PARADISE VALLEY AZ USA  
85253

STEVEN J HILTON FAMILY TRUST/ETAL  
6893 E CACTUS WREN DR PARADISE VALLEY AZ  
USA 85253

STEWART JUSTIN LARRY/KELLI K  
6867 E MEADOWLARK LN PARADISE VALLEY AZ  
USA 85253

STONER ALAN B/CINDY M  
7154 W EUGIE AVE PEORIA AZ USA 85381

SUMMERS JOHN JR/KATINA P  
PO BOX 6100 SCOTTSDALE AZ USA 85261

SUNLIGHT PROPERTIES LLC  
7239 E CACTUS WREN RD SCOTTSDALE AZ USA  
85250

SYLVIA F LITTLE LIVING TRUST  
10632 N SCOTTSDALE RD STE B-195  
SCOTTSDALE AZ USA 85254

TAFT DEREK  
2128 MT BRYNION RD KELSO WA USA 98626

TAFT MARK H/LORI L  
319 HAGENMAN RD KELSO WA USA 98626

TAFT MARK H/LORI L  
319 HAGEMAN RD KELSO WA USA 98626

TAN SHELLEY LYNN  
6357 WILD OAKS TER NORTHWEST PRIOR LAKE  
MN USA 55372

TEHRANI LEILA K  
6820 N 73RD ST SCOTTSDALE AZ USA 85250

TENN FAMILY TRUST  
6917 E CACTUS WREN RD PARADISE VALLEY AZ  
USA 85253

THOMAS AND SABRINA PRASIL REVOCABLE  
TRUST  
7275 N SCOTTSDALE RD UNIT 1007 PARADISE  
VALLEY AZ USA 85253-2606

THOMAS M RETTLER REVOCABLE  
TRUST/COURTNAY A RETTLER REVOCABLE  
TRUST  
2328 E STIRLING PKWY APPLETON WI USA  
54913-7852

THURMAN FAMILY LIVING TRUST  
7002 N 68TH PL PARADISE VALLEY AZ USA  
85253

TIMMERMAN BRADLEY  
7291 N SCOTTSDALE RD UNIT 3006 SCOTTSDALE  
AZ USA 85253

TIMOTHY & NANCY CASSIDY FAMILY TRUST  
7275 N SCOTTSDALE RD UNIT 1002 PARADISE  
VALLEY AZ USA 85253

TOLLEN THOMAS/TIFFINIE  
7320 N 71ST ST PARADISE VALLEY AZ USA 85253

TOTH DOUGLAS F  
7027 N SCOTTSDALE RD SUITE 131 PARADISE  
VALLEY AZ USA 85253

TRAVIATA CONDOMINIUMS HOMEOWNERS  
ASSOC  
7255 E HAMPTON AVE STE 101 MESA AZ USA  
85209

TREGER SHANNON DEAN  
9145 N 70TH ST PARADISE VALLEY AZ USA  
85253

TROISI 7027 LLC  
8207 E BERRIDGE LN SCOTTSDALE AZ USA  
85250

TUCKER MARLENE ANN  
7027 N SCOTTSDALE RD SUITE 140 PARADISE  
VALLEY AZ USA 85253

UNDERHILL LARRY G TR  
2911 N FOSSIL RIM WITCHITA KS USA 67205

UNITED CHINA EDUCATION FOUNDATION INC  
7401 N SCOTTSDALE RD NO 42 PARADISE  
VALLEY AZ USA 85253

VALOS FAMILY LIVING TRUST  
7291 N SCOTTSDALE RD UNIT 3005 PARADISE  
VALLEY AZ USA 85253

VANDERPOEL MICHAEL/SHELLEY  
5013 W TAPPS DRIVE E LAKE TAPPS WA USA  
98391

VERNON RICHARD W TR  
6821 N 72ND PL SCOTTSDALE AZ USA 85253

VICORI REVOCABLE TRUST  
6890 E CACTUS WREN RD PARADISE VALLEY AZ  
USA 85253

VIKKI L RASKIN REVOCABLE TRUST  
6821 E JOSHUA TREE LN LOT 58 PARADISE  
VALLEY AZ USA 85253

WALKER WENDY R  
6701 N SCOTTSDALE RD UNIT 24 SCOTTSDALE  
AZ USA 85250

WARSTLER CAROLYN GUIMARIN  
6919 E JOSHUA TREE LN PARADISE VALLEY AZ  
USA 85253

WATSON GENE R/LAURA E  
7291 N SCOTTSDALE RD UNIT 3008 SCOTTSDALE  
AZ USA 85253

WECHSLER ROBERT L/BARBARA KAUFMAN  
7275 N SCOTTSDALE RD UNIT 1022 PARADISE  
VALLEY AZ USA 85253

WEISEL FAMILY TRUST  
6886 E JOSHUA TREE LN PARADISE VALLEY AZ  
USA 85253

WERNER MICHAEL/DENISE  
6920 E HUMMINGBIRD LN PARADISE VALLEY AZ  
USA 85253

WESTOVER DECEDENTS TRUST  
6835 E CHENEY RD PARADISE VALLEY AZ USA  
85253

WESTREICH DOROTHY/PHILLIP  
6701 N SCOTTSDALE RD UNIT 27 SCOTTSDALE  
AZ USA 85250

WHEELER MARGARET J  
6811 N 73RD ST SCOTTSDALE AZ USA 85250

WHITE JEROME S JR/JEANINE D  
1648 CANFIELD AVE PARK RIDGE IL USA 60068

WHITSTONE SEVILLE LLC  
2600 S GESSNER RD SUITE 500 HOUSTON TX  
USA 77063

WIENER SANDER N/LINDA B  
7012 E HUMMINGBIRD LN PARADISE VALLEY AZ  
USA 85253

WILL WINSTON HOLDINGS LLC  
6989 E CACTUS WREN RD PARADISE VALLEY AZ  
USA 85253

WILLIAM BRADFORD LITLE AND MONICA SEGO  
LITLE TRUST  
7030 E CHENEY DR PARADISE VALLEY AZ USA  
85253

WILLIAMS BRIAN C/AMY N  
2715 84TH PL NE BELLEVUE WA USA 98004

WINCHELSEA LLC  
PO BOX 681 CAVE CREEK AZ USA 85327

WISHON MICHAEL/CAROL  
2632 SAMUEL DR OFALLON MO USA 63368

WOZNY ROBERT  
51500 STRATTON CT GRANGER IN USA 46530

YOUNG SCOTT DOUGLAS/GILROY DENISE LEE  
8755 E VIA DE ENCANTO SCOTTSDALE AZ USA  
85258

YOYO TRUST  
7525 E GAINNEY RANCH RD UNIT 115  
SCOTTSDALE AZ USA 85258

ZOWINE DAVID T TR  
6752 E ARROYO CT PARADISE VALLEY AZ USA  
85253

AFFIDAVIT OF POSTING

STATE OF ARIZONA )

) SS:

County of Maricopa )

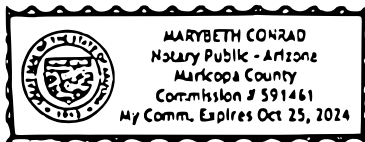

I, Meghan Liggett, depose and state that the attached notice, of proposed application SUP-22-02 located at NWC Indian Bend & Scottsdale Rd. for the (Planning Commission/Town Council/Board of Adjustment/Hillside Committee) meeting date of 2nd of May, 2023 is a true and correct copy of a notice which I cause to be posted by the following day of the week Tuesday, and on the following date April 11th, 2023 in the following location(s):

All in the Town of Paradise Valley, Arizona and County and State aforesaid, the same being public places in said County and in the following locations:

All to the Town of Paradise Valley, Arizona and County and State aforesaid.

DATED this 14th day of April, 2023.

Meghan Liggett  
Signature

This affidavit was SUBSCRIBED AND SWORN to before me this 14th day of April, 2023

Mary Beth Conrad

NOTARY PUBLIC

My commission expires:

10-25-24







**ZONING HEARING**

**TOWN OF PARADISE VALLEY**

**Planning Commission**

**401 S. Lincoln Blvd., Paradise Valley, AZ**

**85253-1001**

**APRIL 11, 2023 10:00 AM**

**8:00 AM - 10:00 AM**

**10:00 AM - 11:00 AM**

**11:00 AM - 12:00 PM**

**12:00 PM - 1:00 PM**

**1:00 PM - 2:00 PM**

**2:00 PM - 3:00 PM**

**3:00 PM - 4:00 PM**

**4:00 PM - 5:00 PM**

**5:00 PM - 6:00 PM**

**6:00 PM - 7:00 PM**

**7:00 PM - 8:00 PM**

**8:00 PM - 9:00 PM**

**9:00 PM - 10:00 PM**

**10:00 PM - 11:00 PM**

**11:00 PM - 12:00 AM**

**12:00 AM - 1:00 AM**

**1:00 AM - 2:00 AM**

**2:00 AM - 3:00 AM**

**3:00 AM - 4:00 AM**

**4:00 AM - 5:00 AM**

**5:00 AM - 6:00 AM**

**6:00 AM - 7:00 AM**

**7:00 AM - 8:00 AM**

**8:00 AM - 9:00 AM**

**9:00 AM - 10:00 AM**

**10:00 AM - 11:00 AM**

**11:00 AM - 12:00 PM**

**12:00 PM - 1:00 PM**

**1:00 PM - 2:00 PM**

**2:00 PM - 3:00 PM**

**3:00 PM - 4:00 PM**

**4:00 PM - 5:00 PM**

**5:00 PM - 6:00 PM**

**6:00 PM - 7:00 PM**

**7:00 PM - 8:00 PM**

**8:00 PM - 9:00 PM**

**9:00 PM - 10:00 PM**

**10:00 PM - 11:00 PM**

**11:00 PM - 12:00 AM**

**12:00 AM - 1:00 AM**

**1:00 AM - 2:00 AM**

**2:00 AM - 3:00 AM**

**3:00 AM - 4:00 AM**

**4:00 AM - 5:00 AM**

**5:00 AM - 6:00 AM**

Apr 11, 2023 at 1:20:25 PM  
N Scottsdale Rd  
Paradise Valley AZ 85253  
United States  
Scottsdale Plaza Resort & Villas

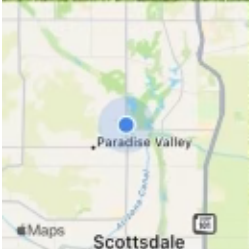



# ZONING HEARING

TOWN OF PARADISE VALLEY  
Planning Commission

6401 E. Lincoln Drive, Paradise Valley, AZ  
6:00 O'CLOCK 2ND DAY OF MAY, 2023

Notice is hereby given that the Town of Paradise Valley Board of Adjustment will hold a public hearing at 6:00 p.m. on Friday, May 2nd, 2023, at Town Hall, 6401 East Lincoln Drive, Paradise Valley, AZ, 85253 for  
**PUBLIC HEARING.**

**Discussion and possible action of an Intermediate Special Use Permit amendment (SUP22-02) of the 38.5-acre wine Scottsdale Plaza Resort located at 7200 N Scottsdale Road (Maricopa County Assessor's Parcel ID: 174-08-001A, 174-08-001B, and 174-08-001C) submitted by Rose Law Group, P.C., on behalf of 7200 Scottsdale Rd Owner LP, a Delaware limited partnership (being the hospitality investment & management company called Highgate).**

The proposal includes similar uses (guest units, meeting spaces, spa, pool/spa court, hotel/administrative offices, and food/beverage) to the existing resort, with the redevelopment located on the east portion of the site located near Scottsdale Road. The request generally includes 64 additional guest units (an increase from 484 to 548 units with six for-sale products), three new signature restaurants, new spa with cafe including second-level pool area, new lobby pavilion, redesigned resort pool, newly painted exterior/interior renovation for all existing buildings, enhanced landscaping and lighting, storage, underground parking, and improvements to site infrastructure.

If you have questions about this application, please call Planning Manager Paul Michael with the Planning Department at (480) 345-3374.

**PENALTY FOR DEPRIVING POSTER PRIOR TO DATE OF HEARING**  
CASE NO. 22-02 POSTING DATE BY April 30, 2023

Apr 11, 2023 at 1:14:53 PM  
7119-7155 E Hummingbird Ln  
Paradise Valley, AZ 85253  
United States  
Scottsdale Plaza Resort & Villas

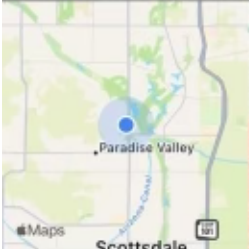

**NEIGHBOR RECEPTION MEETING**

**OCTOBER 3, 2022**

# You're Invited

*to a neighbor reception to learn  
about our exciting plans to renovate and  
renew The Scottsdale Plaza Resort.*

PLEASE JOIN US

MONDAY, OCTOBER 3RD, 2022

THE SCOTTSDALE PLAZA RESORT  
CAMELBACK VISTA  
5-6 PM

*If you are unable to attend – we are happy to schedule  
another time to meet with you individually.*

Please RSVP to Jennifer Hall  
at 480-505-3938 or [jhall@roselawgroup.com](mailto:jhall@roselawgroup.com)



Name	Address	Email	Phone	Y/N to receive project updates
LINDA & SANDER WIENER	7012 E. HUMMINGBIRD	SANDER@ NOHSC.COM	480-663-3373	
BONNIE GLASCOCK	7016 E. HUMMINGBIRD	BONNIE@ BARBARASA.COM	480-367 8567	
Bee Stamps	7115 N. GPK PI.	5stamps.b@ gmail.com	480-948- 4367	



NEIGHBOR  
7101 N 71ST PL  
PARADISE VALLEY, AZ 85253

NEIGHBOR  
7241 N 71ST PL  
PARADISE VALLEY, AZ 85253

NEIGHBOR  
7137 E BLUEBIRD LN  
PARADISE VALLEY, AZ 85253

NEIGHBOR  
7140 E BLUEBIRD LN  
PARADISE VALLEY, AZ 85253

NEIGHBOR  
7123 E BLUEBIRD LN  
PARADISE VALLEY, AZ 85253

NEIGHBOR  
7126 E BLUEBIRD LN  
PARADISE VALLEY, AZ 85253

NEIGHBOR  
7202 N 71ST ST  
PARADISE VALLEY, AZ 85253

NEIGHBOR  
7230 N 71ST ST  
PARADISE VALLEY, AZ 85253

NEIGHBOR  
7016 E HUMMINGBIRD LN  
PARADISE VALLEY, AZ 85253

NEIGHBOR  
7012 E HUMMINGBIRD LN  
PARADISE VALLEY, AZ 85253

NEIGHBOR  
6112 E CORTEZ DR  
SCOTTSDALE, AZ 85254

NEIGHBOR  
6920 E HUMMINGBIRD LN  
PARADISE VALLEY, AZ 85253

NEIGHBOR  
6912 E HUMMINGBIRD LN  
PARADISE VALLEY, AZ 85253

NEIGHBOR  
6902 E HUMMINGBIRD LN  
PARADISE VALLEY, AZ 85253

NEIGHBOR  
6908 E HUMMINGBIRD LN  
PARADISE VALLEY, AZ 85253

NEIGHBOR  
6939 E HUMMINGBIRD LN  
PARADISE VALLEY, AZ 85253

NEIGHBOR  
6923 E HUMMINGBIRD LN  
PARADISE VALLEY, AZ 85253

NEIGHBOR  
7115 N 69TH PL  
PARADISE VALLEY, AZ 85253

NEIGHBOR  
7101 N 69TH PL  
PARADISE VALLEY, AZ 85253

NEIGHBOR  
7045 N 69TH PL  
PARADISE VALLEY, AZ 85253

NEIGHBOR  
7035 N 69TH PL  
PARADISE VALLEY, AZ 85253

NEIGHBOR  
7019 N 69TH PL  
PARADISE VALLEY, AZ 85253

NEIGHBOR  
6940 E INDIAN BEND RD  
PARADISE VALLEY, AZ 85253

NEIGHBOR  
6924 E INDIAN BEND RD  
PARADISE VALLEY, AZ 85253

NEIGHBOR  
7008 N 69TH PL  
PARADISE VALLEY, AZ 85253

NEIGHBOR  
7018 N 69TH PL  
PARADISE VALLEY, AZ 85253

NEIGHBOR  
7036 N 69TH PL  
PARADISE VALLEY, AZ 85253

NEIGHBOR  
7050 N 69TH PL  
PARADISE VALLEY, AZ 85253

NEIGHBOR  
7100 N 69TH PL  
PARADISE VALLEY, AZ 85253

NEIGHBOR  
7130 N 69TH PL  
PARADISE VALLEY, AZ 85253



NEIGHBOR  
7170 N 69TH PL  
PARADISE VALLEY, AZ 85253

NEIGHBOR  
6842 E HUMMINGBIRD LN  
PARADISE VALLEY, AZ 85253

NEIGHBOR  
6836 E HUMMINGBIRD LN  
PARADISE VALLEY, AZ 85253

NEIGHBOR  
6824 E HUMMINGBIRD LN  
PARADISE VALLEY, AZ 85253

NEIGHBOR  
6830 E HUMMINGBIRD LN  
PARADISE VALLEY, AZ 85253

NEIGHBOR  
7201 N MOCKINGBIRD LN  
PARADISE VALLEY, AZ 85253

NEIGHBOR  
7235 N MOCKINGBIRD LN  
PARADISE VALLEY, AZ 85253

NEIGHBOR  
7239 N MOCKINGBIRD LN  
PARADISE VALLEY, AZ 85253

NEIGHBOR  
7181 N 68TH PL  
PARADISE VALLEY, AZ 85253

NEIGHBOR  
7123 N 68TH PL  
PARADISE VALLEY, AZ 85253

NEIGHBOR  
7117 N 68TH PL  
PARADISE VALLEY, AZ 85253

NEIGHBOR  
6819 E HUMMINGBIRD LN  
PARADISE VALLEY, AZ 85253

NEIGHBOR  
6803 E HUMMINGBIRD LN  
PARADISE VALLEY, AZ 85253

NEIGHBOR  
7115 N MOCKINGBIRD LN  
PARADISE VALLEY, AZ 85253

NEIGHBOR  
6820 E MEADOWLARK LN  
PARADISE VALLEY, AZ 85253

NEIGHBOR  
6848 E MEADOWLARK LN  
PARADISE VALLEY, AZ 85253

NEIGHBOR  
6867 E MEADOWLARK LN  
PARADISE VALLEY, AZ 85253

NEIGHBOR  
6853 E MEADOWLARK LN  
PARADISE VALLEY, AZ 85253

NEIGHBOR  
6835 E MEADOWLARK LN  
PARADISE VALLEY, AZ 85253

NEIGHBOR  
6807 E MEADOWLARK LN  
PARADISE VALLEY, AZ 85253

NEIGHBOR  
6814 E INDIAN BEND RD  
PARADISE VALLEY, AZ 85253

NEIGHBOR  
7008 N 68TH PL  
PARADISE VALLEY, AZ 85253

NEIGHBOR  
7002 N 68TH PL  
PARADISE VALLEY, AZ 85253

NEIGHBOR  
7005 N 68TH PL  
PARADISE VALLEY, AZ 85253

NEIGHBOR  
7291 N 71ST PL  
PARADISE VALLEY, AZ 85253

NEIGHBOR  
7298 N 71ST PL  
PARADISE VALLEY, AZ 85253

NEIGHBOR  
7121 E VALLEY TR  
PARADISE VALLEY, AZ 85253

NEIGHBOR  
7320 N 71ST ST  
PARADISE VALLEY, AZ 85253

NEIGHBOR  
7272 N 71ST ST  
PARADISE VALLEY, AZ 85253

**COMMUNITY OPEN HOUSE MEETING**

**FEBRUARY 6, 2023**

Name	Address	Email	Phone	Y/N to receive project updates
AL BARKOV FOR RODERICK TOSUCHI	7291 N. SCOTTSDALE RD UNIT 1003 ARTIST CONDO	al@barkov.us	561-289 0733	Y
Colleen Hood	7291 N. Scottsdale Unit 2012	colmhood@gmail.com	734-755- 6897	Y
CHARLES HALL	SCOTTSDALE	HALLW3@GMAIL.com		Y
J/M ROSE	PV			N
Brian + Nina Dennison	7291 N Scottsdale			N
Donald Frederick				
Barclay				
Carmory				
Natalee Campbell	6750 E Arroyo Court PV		347 724 2412	Y



**AFFIDAVIT OF MAILING NOTIFICATION**

STATE OF ARIZONA )

) ss:

County of Maricopa )

In accordance with the requirements of the Town of Paradise Valley, the undersigned hereby certifies that the mailing list for the proposed project is a complete list of property owners within 1900 feet of the subject property, as obtained from the Maricopa County Assessor's Office on the following date January 9, 2023, and such notification has been mailed on the following date January 24, 2023.

[Signature] Kayla Bertoldo  
Signature

The foregoing instrument was acknowledged by me this 28th day of January, 2023, by Kayla Bertoldo.  
Name

Angelica van Balen  
NOTARY PUBLIC

My commission expires:  
June 5, 2023

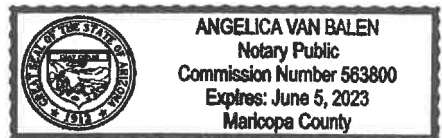

ROSE LAW GROUP<sub>pc</sub>  
RICH ■ CARTER ■ FISHER

JENNIFER HALL  
7144 E. Stetson Drive, Suite 300  
Scottsdale, AZ 85251  
Phone 480.505.3938 Fax 480.505.3925  
JHall@RoseLawGroup.com  
www.RoseLawGroup.com

January 23, 2023

Dear Property Owner, Neighbor, or Interested Party:

This notification letter is to inform you that The Scottsdale Plaza Resort (“SPR”) is proposing some overdue renovations and improvements to the Resort property located at 7200 N. Scottsdale Road in Paradise Valley (Case #SUP-22-02). These elegant upgrades and imaginative improvements will rejuvenate one of the Town’s oldest and most cherished resort properties.

Specifically, SPR plans to amend the existing Special Use Permit (“SUP”) to allow for 60 additional hotel rooms, three new signature restaurants, new Spa with café, new Lobby pavilion, a redesigned resort pool, freshly painted exterior finishes for all existing buildings, and undergrounding of select parking.

Please join us to learn more about the property enhancements:

SPR Community Informational Meeting  
Monday, February 6, 2023  
6:00PM – 7:00PM  
Camelback Vista Building  
(Building on the corner of Scottsdale Rd and Indian Bend Rd)

If you are unable to attend this meeting please contact me directly for more information. I am happy to discuss and answer any questions that you may have regarding this proposal. Please feel free to reach out to me at any time at 480-505-3938 or by email at [jhall@roselawgroup.com](mailto:jhall@roselawgroup.com).

You may also reach out to Paul Michaud, Planning Manager at the Town of Paradise Valley, at 480-348-3574 or [pmichaud@paradisevalleyaz.gov](mailto:pmichaud@paradisevalleyaz.gov) to provide public comment.

Sincerely,

*Jennifer Hall*

Senior Project Manager

**PROJECT LOCATION MAP**



## Town notifications get a new look

We've changed the look of the Town's notifications to help residents identify mail containing official Town business. If you receive an envelop that looks like the one below, this is **official Town business** with informaton that may interest you.



Town of Paradise Valley  
Community Development Department  
6401 East Lincoln Drive  
Paradise Valley, AZ 85253

Resident Name  
Address  
City, State, Zip Code



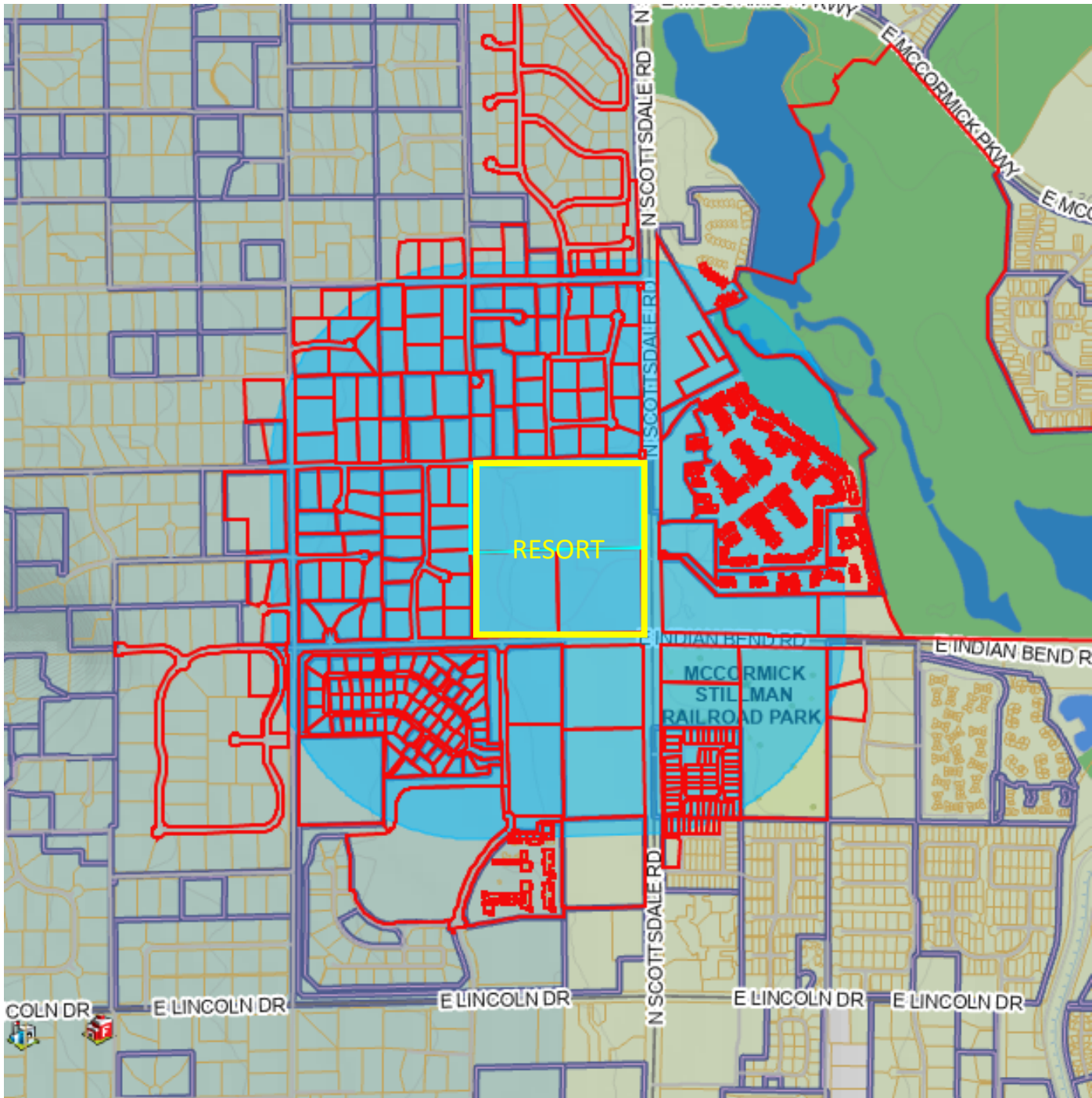

THE SCOTTSDALE  
**PLAZA**  
RESORT

COMMUNITY INFORMATIONAL MEETING  
1500 FT BUFFER MAP

3BP1 LLC  
9596 E POINSETTIA DR SCOTTSDALE AZ USA  
85260

6840 AVENIDA EL ALBA LLC  
PO BOX 7787 ASPEN CO USA 81612

6847 JOSHUA TREE LLC  
182 RACE ST DENVER CO USA 80206-4611

6883 E JOSHUA TREE LN LLC  
6883 E JOSHUA TREE LN PARADISE VALLEY AZ  
USA 85253

7000 EAST LINCOLN RESORT COMMUNITY  
PARCEL B RESIDENTIAL ASSOCIATION  
1600 W BROADWAY RD STE 200 TEMPE AZ USA  
85282

7200 SCOTTSDALE RD OWNER LP  
3953 MAPLE AVE STE 300 DALLAS TX USA 75219

869563 ALBERTA LTD  
1111-3 AVENUE S LETHBRIDGE AB CANADA  
T1J0J5

ABDIN ALADIN/CHIANTELLA JACQUELINE  
7401 N SCOTTSDALE RD PARADISE VALLEY AZ  
USA 85253

ADAMS BEECHER P/CAROL R  
5828 E CACTUS WREN RD PARADISE VALLEY AZ  
USA 85253

AHDOOT FAMILY TRUST  
5909 E SOLCITO LN PARADISE VALLEY AZ USA  
85253

APORIA LLC  
350 E VIRGINIA AVE SUITE 100 PHOENIX AZ USA  
85004

ARGENT REVOCABLE TRUST  
PO BOX 4170 INCLINE VILLAGE NV USA 89450

ARMSTRONG CHRISTOPHER/STEPHANIE  
6850 N 72ND PL SCOTTSDALE AZ USA 85250

ARSANJANI REZA/KILIAN CAROLINE  
6848 E MEADOWLARK LN PARADISE VALLEY AZ  
USA 85253

ARTESIA DEVELOPMENT PARTNERS LLC  
8800 E RAINTREE DR STE 300 SCOTTSDALE AZ  
USA 85260

ASCENSION LUTHERAN CHURCH INC PARADISE  
VALLEY ARIZONA  
7100 N MOCKINGBIRD LN PARADISE VALLEY AZ  
USA 85253

ASCHERL GEORGE F JR/GEORGE F III  
7537 E MCDONALD DR SCOTTSDALE AZ USA  
85250

AULT M CRAIG/JANET M  
7275 N SCOTTSDALE RD UNIT 1019 SCOTTSDALE  
AZ USA 85253

AZADEH HAFEZ  
9116 N FOOTHILLS MANOR DR PARADISE  
VALLEY AZ USA 85253

BABINS ERIC M/GOLD-BABINS BONNY  
1316 CARYLE RD SW CALGARY AB CANADA  
T2V2T8

BAGAI RAKESH/RIDDHIMA  
7373 N 71ST PL PARADISE VALLEY AZ USA 85253

BAIN FAMILY TRUST  
7117 N 68TH PL PARADISE VALLEY AZ USA  
85253

BAIRD HAL C/BEVERLY  
119 S 10TH ST APT 605 BOISE ID USA 83702

BALOW ROSEANN G  
6767 E ARROYO CT PARADISE VALLEY AZ USA  
85253

BARBE CHAD/KENNETH JR  
PO BOX 2107 ROSWELL NM USA 88202

BARBEE FAMILY TRUST  
7611 N MOCKINGBIRD LN PARADISE VALLEY AZ  
USA 85253

BARCLAY FAMILY TRUST  
7275 N SCOTTSDALE RD UNIT 1009 SCOTTSDALE  
AZ USA 85253-2606

BAZAN MARIANNE  
PO BOX 6574 SCOTTSDALE AZ USA 85261

BEAMER RICHARD S/PATRICIA A  
4821 LAKE WASHINGTON BLVD S SEATTLE WA  
USA 98118-1550

BERNARD G RETHORE LIVING TRUST  
7010 E AVENIDA EL ALBA PARADISE VALLEY AZ  
USA 85253

BERTRAM BRIAN D/PAIGE K  
6863 E JOSHUA TREE LN PARADISE VALLEY AZ  
USA 85253

BETA PROPERTY HOLDINGS INC  
PO BOX 31210 LAS VEGAS NV USA 89173

BEUCUS ELIZABETH L TR/ROBERT W  
6824 AVENIDA EL ALBA PARADISE VALLEY AZ  
USA 85253

BHATIA ANAND/AMRITA  
8770 E HIGH POINT DR SCOTTSDALE AZ USA  
85266

BINDI LIVING TRUST  
312 ARIAS ST SAN RAFAEL CA USA 94903-3351

BISSELL CAROLINE VIRGINIA TR  
7231 E CACTUS WREN RD SCOTTSDALE AZ USA  
85250

BLAIK ROBERT M/DOROTHY E  
7291 N SCOTTSDALE RD UNIT 2005 SCOTTSDALE  
AZ USA 85253

BLAKEMAN BRADLEY A  
6701 N SCOTTSDALE RD LOT 28 SCOTTSDALE AZ  
USA 85250

BLUMETTI FAMILY TRUST  
6939 E HUMMINGBIRD LN PARADISE VALLEY AZ  
USA 85253

BMTR LLC  
4812E E BLUEFIELD AVE SCOTTSDALE AZ USA  
85254

BOUCHER REBECCA  
7027 N SCOTTSDALE RD UNIT 223 PARADISE  
VALLEY AZ USA 85253

BOWEN MARCUS  
6802 N 72ND PL SCOTTSDALE AZ USA 85250

BOWMAN DARREN B/KAY E  
6898 E JOSHUA TREE LN PARADISE VALLEY AZ  
USA 85253

BRADLEY IAN/VALERIE  
14003 77 AVE EDMONTON AB CANADA T5R3B2

BRANDT TYLER ALLEN  
2508 ROSE CREEK PKWY S FARGO ND USA  
58104

BRIAN A BROOKS AND TAMBRA L BROOKS  
TRUST  
3225 FAIRWAY CT MORGAN HILLS CA USA  
95037

BRIAN A WEINBERGER LIVING TRUST  
7249 E JOSHUA TREE LN SCOTTSDALE AZ USA  
85250

BRODKIN TERRY B  
7320 E SHOEMAN LN SCOTTSDALE AZ USA  
85251

BRUMMER ROBERT/LORI  
1106 SIEMER DR DENISON IA USA 51442

BRUSHA GENCI/PATRICIA  
2425 E CHARLENE PL PHOENIX AZ USA 85024

BTSH FAMILY TRUST  
6902 E HUMMINGBIRD LN PARADISE VALLEY AZ  
USA 85253

BUA JOSEPH  
7297 N SCOTTSDALE RD UNIT 1001 PARADISE  
VALLEY AZ USA 85253

BUECHEL JASON J  
7725 N SCOTTSDALE RD UNIT 1005 BLDG G2  
SCOTTSDALE AZ USA 85253

BUNCH HENRY S/KAREN LYNN  
6815 E CAMELBACK RD UNIT 2023 SCOTTSDALE  
AZ USA 85251

BURKE STEPHEN/PATRICIA  
7275 N SCOTTSDALE RD UNIT 1003 PARADISE  
VALLEY AZ USA 85253

BURNHAM JOHN P  
7027 N SCOTTSDALE RD STE 215 PARADISE  
VALLEY AZ USA 85253-3687

CACTUS RUN LLC  
6114 S CHERRYWOOD CIRCLE CENTENNIAL CO  
USA 80121

CALAMITO LUCETTE G  
6829 N 72ND PL SCOTTSDALE AZ USA 85250

CALDWELL CAITLIN BACHER  
6400 E THOMAS RD APT 1051 SCOTTSDALE AZ  
USA 85251

CAMPBELL NATALEE SIMONE  
6760 E ARROYO CT PARADISE VALLEY AZ USA  
85253

CANAD MANOR AZ INC  
3RD-930 JEFFERSON AVE WINNIPEG MB  
CANADA R2P 1W1

CAREFOOT ANNE V S  
7291 N SCOTTSDALE RD UNIT 4011 PARADISE  
VALLEY AZ USA 85253

CAREY ROBERT B/GRETCHEN K  
6708 E EXETER BLVD SCOTTSDALE AZ USA  
85251

CARTER INVESTMENTS PARTNERSHIP USA  
215-1300 8 ST SW CALGARY AB CANADA T2R  
1B2

CASHMAN SUSAN E/VITO JAMES M  
7437 N 71ST ST PARADISE VALLEY AZ USA 85253

CAVELL ARIZONA INC  
9141 E HIDDEN SPUR TRAIL SUITE 105  
SCOTTSDALE AZ USA 85255

CAVELL ARIZONA INC  
900 10310 JASPER AVE EDMONTON AB CANADA  
T5J1Y8

CHENEY DR LLC  
7505 N 70TH ST PARADISE VALLEY AZ USA  
85253

CHENEY ESTATES OWNERS ASSOCIATION  
9000 E PIMA CTR PKWY 300 SCOTTSDALE AZ  
USA 85258

CHENEY HOLDINGS LLC  
6905 E CHENEY DR PARADISE VALLEY AZ USA  
85253

CHENEY PLACE HOMEOWNERS ASSOCIATION  
7373 DOUBLETREE RANCH RD SCOTTSDALE AZ  
USA 85258

CHESIN MATTHEW  
7027 N SCOTTSDALE RD NO 222 PARADISE  
VALLEY AZ USA 85253

CHRISTINE H SODERQUIST LIVING TRUST  
7302 E JOSHUA TREE LN SCOTTSDALE AZ USA  
85250

CHUN WOOKJIN/MOON MINSOO  
7004 E AVENIDA EL ALBA PARADISE VALLEY AZ  
USA 85253

CLAUDIA LUCAIRE LIVING TRUST  
7408 E ONYX CT SCOTTSDALE AZ USA 85258

CLIFFORD AND BIBI DURGANA LIVING TRUST  
22113 N 31ST ST PHOENIX AZ USA 85050

CLS TRUST  
PO BOX 45515 PHOENIX AZ USA 85064-5515

CMXII HOLDINGS LLC  
631 N STEPHANIE ST NO 343 HENDERSON NV  
USA 89014

COHN JAMES M/LINDA BETH  
6152 N LAS BRISAS DR PARADISE VALLEY AZ USA  
85253

COUTELIN DOREEN  
7246 E JOSHUA TREE LN SCOTTSDALE AZ USA  
85250

CRAIG LANCE A  
4148 STONEYBROOK LN PORT ARTHUR TX USA  
77642

CRAIK DAVID L/VIOLET  
9025 N FLYING BUTTE DR FOUNTAIN HILLS AZ  
USA 85268

CUERNAVACA HOMEOWNERS ASSOC INC  
16625 S DESERT FOOTHILLS PKWY PHOENIX AZ  
USA 85048

CWH REVOCABLE TRUST  
7241 E JOSHUA TREE LN SCOTTSDALE AZ USA  
85250

DAKAJOS JOHN/DEBORAH  
7003 E AVENIDA EL ALBA PARADISE VALLEY AZ  
USA 85253

DAVIS RICHARD K/THERESA A  
7018 N 69TH PL PARADISE VALLEY AZ USA  
85253

DE LA ROSA ANTONIO/NICOLE TR  
7027 E VISTA DR PARADISE VALLEY AZ USA  
85253

DED LLC  
3223 32ND AVE S STE 201 FARGO ND USA  
58103

DEMPSEY PATRICK F/NATALIE A  
16W719 HILLSIDE LN WILLOWBROOK IL USA  
60527

DENISE R BOYLE TRUST  
18905 N 101ST WAY SCOTTSDALE AZ USA 85255

DENNIS A MITCHELL REVOCABLE TRUST  
1360 POINT O WOODS DR BENTON HARBOR MI  
USA 49022-9428

DENNISON NINA  
7291 N SCOTTSDALE RD UNIT 3004 PARADISE  
VALLEY AZ USA 85253

DERMIT FAMILY TRUST  
11231 NE 116TH PL KIRKLAND WA USA 98034

DESERT VIKING SPECTRUM LLC  
3002 E WASHINGTON ST PHOENIX AZ USA  
85034

DEVRIES CHRISTOPHER JOHN/JAMIE C DONNELL  
TR  
6501 E GREENWAY PKWY SUITE 103 PMB 218  
SCOTTSDALE AZ USA 85254-2070

DHAMIJA ROHIT/CATHERINE R  
2281 WUTHERING HEIGHTS WY OAKVILLE ON  
CANADA L6M0A6

DIAZ ALEXIS MARIE  
PO BOX 5130 SNOWMASS VILLAGE CO USA  
81615

DICIANO JULIEN D  
101-200 RONSON DR ETOBICOKE ON CANADA  
M9W 5Z9

DIGBY DONALD TR  
1400 W 64TH AVE DENVER CO USA 80221

DISQUE FAMILY TRUST  
9215 N AMERICAN RANCH RD PRESCOTT AZ  
USA 86305

DJAHANDIDEH FARADJOLLAH F  
7275 N SCOTTSDALE RD STE 1008 SCOTTSDALE  
AZ USA 85253

DJSJ 4007 LLC  
6983 E NORTHERN AVE PARADISE VALLEY AZ  
USA 85253

EBERLE VIVIAN FAMILY LIVING TRUST  
6823 E AVENIDA EL ALBA PARADISE VALLEY AZ  
USA 85253

ECONOMOS SOPHIA  
6838 E OAK ST SCOTTSDALE AZ USA 85257

EDELSTEIN CAREN J  
7291 N SCOTTSDALE RD UNIT 1009 PARADISE  
VALLEY AZ USA 85253

EFUNE HILTON/MELANIE A TR  
7140 E BLUEBIRD LN PARADISE VALLEY AZ USA  
85253

EILEEN ELLENS LIVING TRUST  
670 OLD ORCHARD RD HOLLAND MI USA 49423

ELK ESTATES LLC  
15215 S 48TH ST STE 139 PHOENIX AZ USA  
85044

EMILEE A MARKMAN TRUST  
7291 N SCOTTSDALE RD UNIT 2006 PARADISE  
VALLEY AZ USA 85253

ENCK SCOTT/EMILY J  
31722 12TH PLACE SW FEDERAL WAY WA USA  
98023

ESPOSITO DONNA M TR  
7027 N SCOTTSDALE RD 108 SCOTTSDALE AZ  
USA 85253

EW17-MOF-JV SEVILLE LLC  
PO BOX 460189 DEPT 126 HOUSTON TX USA  
77056

FARZAD KHAMOOSHI TRUST  
6830 N 72ND PL SCOTTSDALE AZ USA 85250

FATEMA KHATIB-SHAHIDI REVOCABLE TRUST  
7291 N SCOTTSDALE RD UNIT 3016 SCOTTSDALE  
AZ USA 85253

FERRARO JOSEPH P  
7035 N 69TH PL PARADISE VALLEY AZ USA  
85253

FEUER FAMILY TRUST  
5353 N 16TH ST SUITE 105 PHOENIX AZ USA  
85016

FIVE STAR LAND OWNER LLC  
6720 N SCOTTSDALE RD STE 130 SCOTTSDALE  
AZ USA 85253

FIVE STAR RESORT OWNER LLC  
6720 N SCOTTSDALE RD SUITE 130 SCOTTSDALE  
AZ USA 85253

FLAMINGO REVOCABLE TRUST  
15215 N KIERLAND BLVD NO 735 SCOTTSDALE  
AZ USA 85254

FLETCHER S T TR  
7027 N SCOTTSDALE RD UNIT 123 SCOTTSDALE  
AZ USA 85253

FORSTER KARL D/ SALLY A TR  
6835 E MEADOWLARK LN PARADISE VALLEY AZ  
USA 85253

FRANCES R KIRSCHNER REVOCABLE TRUST  
7291 N SCOTTSDALE RD UNIT 3009 PARADISE  
VALLEY AZ USA 85253

FREDERICK PHILIP SNOW REVOCABLE  
TRUST/JENNIFER XUAN THANH SNOW  
REVOCABLE TRUST  
21 BEAUMONT ST FAIRFIELD CT USA 06824

FREDERICKSON FAMILY TRUST  
930 TAHOE BLVD STE 802 PMB 551 INCLINE  
VILLAGE NV USA 89451

FUREY JAMES H/VICKI H  
1221 SANTA BARBARA DR NEWPORT BEACH CA  
USA 92660-6371

FV CASA RESERVE LLC  
1013 ALTA CIR LOUISVILLE KY USA 40205

GAIDICI FLORIN/ADRIANA T TR  
7115 E MOCKINGBIRD LN PARADISE VALLEY AZ  
USA 85253

GAINES DEBORAH ANN  
4140 W PLACITA DEL MONTE TUCSON AZ USA  
85745

GARY D FROST AND KRISTINE M MARCHIONDA-  
FROST FAMILY TRUST  
6767 E BLUEBIRD LN PARADISE VALLEY AZ USA  
85253

GATELY CHRISTOPHER J  
7275 N SCOTTSDALE RD UNIT 1020 SCOTTSDALE  
AZ USA 85253-2616

GEOFFREY A COUCH FAMILY TRUST  
PO BOX 281 PEBBLE BEACH CA USA 93953

GERALD BUESING TRUST  
18972 N 98TH WAY SCOTTSDALE AZ USA 85255

GHANIABADI EFFIE K  
6820 N 73RD ST SCOTTSDALE AZ USA 85250

GIBBONS DALE  
7100 E VALLEY TRL PARADISE VALLEY AZ USA  
85253

GIGLIO GARY/PATRICIA  
6701 N SCOTTSDALE ROAD 21 SCOTTSDALE AZ  
USA 85253

GINA LYNN FRANKLIN REVOCABLE TRUST  
7027 N SCOTTSDALE RD NO 109 SCOTTSDALE AZ  
USA 85253

GINSBURG HOWARD L  
6934 E HUMMINGBIRD LANE PARADISE VALLEY  
AZ USA 85253

GLASCOCK BONSAI H/ALEXIS J TR  
7016 E HUMMINGBIRD LN PARADISE VALLEY AZ  
USA 85253

GLICK JACOB C  
7291 N SCOTTSDALE RD UNIT 4002 PARADISE  
VALLEY AZ USA 85253

GLORIA STAKEMILLER LIVING TRUST  
6924 E INDIAN BEND RD PARADISE VALLEY AZ  
USA 85253

GOLDSTEIN ALLISON  
7291 N SCOTTSDALE RD NO 2013 SCOTTSDALE  
AZ USA 85253

GOODWIN DYLAN E  
7027 N SCOTTSDALE RD STE 136 PARADISE  
VALLEY AZ USA 85253-3685

GORANSON FAMILY TRUST  
3305 E HUBER ST MESA AZ USA 85213

GREEN GULCH RANCH  
5640 E CABALLO DR PARADISE VALLEY AZ USA  
85253

GREEN ROBERT S/JILL S  
6695 E INDIAN BEND RD PARADISE VALLEY AZ  
USA 85253

GREGG AND DAPHNE WARREN 2015 FAMILY  
TRUST  
6914 E. CACTUS WREN RD. PARADISE VALLEY AZ  
USA 85253

GROSSMAN RESIDENCE TRUST  
6874 E JOSHUA TREE LN PARADISE VALLEY AZ  
USA 85253

GRUNTLER AUDREY R  
8648 CRICKET TREE LN INDIANAPOLIS IN USA  
46260

GTG INC  
231 SASKATCHEWAN AVE EAST  
PORTAGELAPRAIRIE MB CANADA R1N3B2

GUPTA JYOTHI/DIWAKAR/DIVYA  
7291 N SCOTTSDALE RD UNIT 4010 PARADISE  
VALLEY AZ USA 85253

HA RICHARD JUNEYOUNG/JEONG JAE  
9132 COUNTY ROAD 422 HANNIBAL MO USA  
63401-6819

HAMPSHIRE 2000 REVOCABLE TRUST  
7275 N SCOTTSDALE RD UNIT 1006 BLDG G2  
SCOTTSDALE AZ USA 85253

HARLAN STANLEY FLEECE JR LIVING TRUST  
7275 N SCOTTSDALE RD UNIT 1015 PARADISE  
VALLEY AZ USA 85253

HARRIS ALISA  
7027 N SCOTTSDALE RD UNIT 213 PARADISE  
VALLEY AZ USA 85253

HAWKINS JAMES B/MARY PAT  
1678 ORVIETO CT PLEASANTON CA USA 94566-  
6494

HAWKINS THOMAS/LINDA  
7275 N SCOTTSDALE RD UNIT 1016 PARADISE  
VALLEY AZ USA 85253

HAZZI ADRIAN J  
1133 PARKLOSS LN BRITISH COLUMBIA BC  
CANADA V1V 2Y3

HEARD GARFIELD  
7291 N SCOTTSDALE RD UNIT 2003 SCOTTSDALE  
AZ USA 85253

HEIER BERNARD/CONNIE  
3901 FIRETHORN CT LINCOLN NE USA 68520

HELEN Y CHANG FAMILY TRUST  
6945 E CHENEY DR PARADISE VALLEY AZ USA  
85253

HERNANDEZ JAIME/MASARYK ZUZANA E  
7027 N SCOTTSDALE RD SUITE 208 SCOTTSDALE  
AZ USA 85253-3687

HILL WALTER PAUL & SHIRLEY J  
6827 N 73RD ST SCOTTSDALE AZ USA 85253

HOFFMAN ALISON TR/BERT ELLIOT/ROBERTA  
LEE TR  
7291 N SCOTTSDALE RD NO 2004 SCOTTSDALE  
AZ USA 85253

HOLWAY RICHARD V/ROBIN J  
7036 N 69TH PL PARADISE VLY AZ USA 85253-  
4410

HOOD EDWARD J/COLLEEN  
7291 N SCOTTSDALE RD UNIT 2012 SCOTTSDALE  
AZ USA 85253

HORAN FAMILY TRUST  
7137 E BLUEBIRD LN PARADISE VALLEY AZ USA  
85253

HORST K HILLER REVOCABLE TRUST  
630 N WASHINGTON WICHITA KS USA 67214

HORVAT CHRISTY M  
850 BONNIE BRAE BLVD DENVER CO USA 80209

HOWARD S CARNEY TRUST  
7275 N SCOTTSDALE RD UNIT 1010 SCOTTSDALE  
AZ USA 85253

HOWZE DENISE  
7291 N SCOTTSDALE RD UNIT 2014 PARADISE  
VALLEY AZ USA 85253

IBRAHIM WILLIAM/CARIE  
6823 N 73RD ST SCOTTSDALE AZ USA 85250

IFFLAND JAMIE M  
7027 N SCOTTSDALE RD SCOTTSDALE AZ USA  
85253

ILARDO SALVATORE/GRAZIA  
7291 N 71ST PL PARADISE VALLEY AZ USA 85253

INDIAN BEND 7575 LLLP  
PO BOX 26447 SCOTTSDALE AZ USA 85255

INOUYE CRAIG S/ROBERSON CHARLOTTE  
5434 E LINCOLN DR NO 23 PARADISE VALLEY AZ  
USA 85253

ISBISTER FAMILY TRUST  
6311 CENTRE STREET SW CALGARY AB CANADA  
T2H0C7

JA IRREVOCABLE TRUST  
7155 E PARADISE CANYON RD PARADISE VALLEY  
AZ USA 85253

JACKSON GEORGE W JR  
29181 WOODCREST CT SOUTHFIELD MI USA  
48076

JACOBS CAROLE R  
8634 E ILIFF DR DENVER CO USA 80231-3809

JAINS NISHA MARY  
7291 N SCOTTSDALE RD UNIT 3012 SCOTTSDALE  
AZ USA 85253

JAMES R LAMON FAMILY LIVING TRUST  
7300 N 70TH ST PARADISE VALLEY AZ USA  
85253

JANECEK NATHAN  
8213 E REDWING RD SCOTTSDALE AZ USA  
85250

JASPER TRUST  
6925 E CHENEY DR PARADISE VALLEY AZ USA  
85253

JB ARIZONA LLC  
15431 W 100TH TER LENEXA KS USA 66219

JBS ARIZONA LLC  
5101 N CASA BLANCA DR UNIT 5 PARADISE  
VALLEY AZ USA 85253

JEAN ANN SMITH REVOCABLE TRUST  
6950 E CACTUS WREN RD PARADISE VALLEY AZ  
USA 85253

JEAN ANN SMITH REVOCABLE TRUST  
2350 S GILBERT RD CHANDLER AZ USA 85286

JERRY AND THORA BARKER FAMILY TRUST  
6923 E HUMMINGBIRD LN PARADISE VALLEY AZ  
USA 85253

JEWETT GREGORY P/LAURA L  
PO BOX 27874 SCOTTSDALE AZ USA 85255

JOHNSON CONSTANCE L  
7025 N SCOTTSDALE RD UNIT 139 SCOTTSDALE  
AZ USA 85253

JOSHUA & INETTE BROWN REVOCABLE TRUST  
2300 WOLF ST UNIT 12MC DALLAS TX USA  
75201

JUDITH A BRECKNER REVOCABLE TRUST  
4014 GRAINWOOD TRL NE PRIOR LAKE MN USA  
55372

JUDSON COMMUNITY ASSOCIATION  
PO BOX 15427 SCOTTSDALE AZ USA 85267

JURKIEWICZ MARK A/BOZENA K  
31947 N 63RD PL CAVE CREEK AZ USA 85331

KASS HOWARD E/JULIE E  
9220 BENTRIDGE AVE POTOMAC MD USA  
20854

KATZ NATALIE/LAWRENCE E TR  
6828 N 73RD ST SCOTTSDALE AZ USA 85250

KAZOKU HOLDINGS LLC  
12600 N 92ND PL SCOTTSDALE AZ USA 85260

KEILTY THOMAS  
6831 N 73RD ST SCOTTSDALE AZ USA 85250

KENNETH J WOOMER AND NIKI M WOOMER  
JOINT LIVING TRUST  
1600 SW DASH POINT RD STE B PMB 260  
FEDERAL WAY WA USA 98023

KENT REED NOBLE REVOCABLE TRUST/LESLIE  
SCARLETT NOBLE REVOCABLE TRUST  
6958 E JOSHUA TREE LN PARADISE VALLEY AZ  
USA 85253

KLEIN MARY PATRICIA/PACINO STEVEN C  
33900 LAKEDGE LN CHAGRIN FALLS OH USA  
44022

KLIBANOFF LIVING TRUST  
6929 E CHENEY DR PARADISE VALLEY AZ USA  
85253

KLIMEK JOHN S/DIANE M TR  
9304 KILREA DR ORLAND OARK IL USA 60462

KLING ASHLEY ROSE  
7027 N SCOTTSDALE RD UNIT 201 SCOTTSDALE  
AZ USA 85252

KLT HOLDINGS LLC  
22611 N 39TH TER PHOENIX AZ USA 85050

KOE BETTY  
6701 N SCOTTSDALE RD UNIT 29 SCOTTSDALE  
AZ USA 85250

KOHL CAROL J  
7027 N SCOTTSDALE RD 110 SCOTTSDALE AZ  
USA 85253

KORNEGAY WILLIAM/REKA SAHAR  
31535 LINDERO CANYON RD NO 16 WESTLAKE  
VILLAGE CA USA 91361

KOUROUGLOS REVOCABLE LIVING TRUST  
6814 E INDIAN BEND RD PARADISE VALLEY AZ  
USA 85253

KOZLOV ALEKSEY/KOZLOVA IRINA  
1322 91ST AVENUE NE CLYDE HILL WA USA  
98004



KRESICKI-OBERLE FAMILY TRUST  
4057 N MIRADA CIR MESA AZ USA 85207

KRIGEL JAMES E/FELICIA JON  
6854 E CACTUS WREN RD PARADISE VALLEY AZ  
USA 85253

KRISHNA SUNITA A  
86 BILTMORE ESTATES PHOENIX AZ USA 85016

KROL RICHARD G/SUZANNE M  
15802 N 71ST ST UNIT 402 SCOTTSDALE AZ USA  
85254

KUBIAK LARISSA C  
7291 N SCOTTSDALE RD UNIT 1005 PARADISE  
VALLEY AZ USA 85253

KUSPER JUSTUS LIVING TRUST  
7275 N SCOTTSDALE RD #1014 PARADISE  
VALLEY AZ USA 85253

KYLES PATRICK J  
1711 DONOVAN AVE ELLINGHAM WA USA  
96225

LAURA A CAMERON LIVING TRUST  
7027 N SCOTTSDALE RD STE 218 PARADISE  
VALLEY AZ USA 85253-3687

LEIGHTON RUDY/DIANE  
5317 164TH AVE SE BELLEVUE WA USA 98006

LEROY PIERRE E  
6901 E JOSHUA TREE LN PARADISE VALLEY AZ  
USA 85253

LEVINE ROARK/JUDY  
76 ROBINSON HILL RD FRANKLIN CT USA 06254

LHS REVOCABLE TRUST  
PO BOX 14672 SCOTTSDALE AZ USA 85267

LIEBERMAN DAVID A  
6112 E CORTEZ DR SCOTTSDALE AZ USA 85254

LILIEN FAMILY TRUST  
7140 E KIERLAND BLVD APT 520 SCOTTSDALE AZ  
USA 85254

LORRAIN A ETZEL AND ELLEN J ETZEL REV TRUST  
7027 N SCOTTSDALE RD STE 117 SCOTTSDALE  
AZ USA 85253-3683

LOVEJOY JEREMY O/COX-LOVEJOY SABRINA L TR  
7123 N 68TH PL PARADISE VALLEY AZ USA  
85253

LUDDEN WATSON TRUST  
1 ANNABEL LN SAN RAMON CA USA 94583

LYNCH LAND DEVELOPMENT LLC  
411 OVERLAND AVE BURLEY ID USA 83318

MAGGIO ANTHONY/CATHY  
7291 N SCOTTSDALE RD UNIT 3007 PARADISE  
VALLEY AZ USA 85253

MAKKAR AKASH/MEENAKSHI  
7005 N 68TH PL PARADISE VALLEY AZ USA  
85253

MANGRAM ALICIA J/ESTELIA  
7101 N 69TH PL PARADISE VALLEY AZ USA  
85253

MANN KENNETH L/JANET H  
6822 N 72ND PL SCOTTSDALE AZ USA 85250

MARELLA PUNNAIAH C/SIRIPURAPU  
SHANTIPRIYA  
7025 E CHENEY DR PARADISE VALLEY AZ USA  
85253

MARGO S POPOVICH INDIVIDUAL PROPERTY  
TRUST  
6386 SPRUCE MEADOWS LN LAND O LAKES WI  
USA 54540

MARIE SWAIM TRUST AGREEMENT  
7291 N SCOTTSDALE RD UNIT 4008 PARADISE  
VALLEY AZ USA 85253

MARK B GOODE REVOCABLE TRUST  
2876 FREDRIC CT NORTHBROOK IL USA 60062

MARK S MICHELINI AND DEBRA J MICHELINI  
REVOCABLE TRUST  
808 BLACK WALNUT DR SUGAR GROVE IL USA  
60554

MARTIN DANA REVOCABLE TRUST  
7710 E GAINNEY RANCH RD UNIT 131  
SCOTTSDALE AZ USA 85258

MARTIN FAMILY TRUST  
835 TROPICAL CIRCLE SARASOTA FL USA 34242-  
1440

MARY A ELTON LIVING TRUST  
7027 N SCOTTSDALE RD UNIT 116 PARADISE  
VALLEY AZ USA 85253

MARY LYNN LIVING TRUST  
7297 N SCOTTSDALE RD UNIT 1004 PARADISE  
VALLEY AZ USA 85253

MARY SHEILA SMITH TRUST  
250 W SPRING ST APT 717 COLUMBUS OH USA  
43215

MASH JASON/HIZER CAROL S  
7291 N SCOTTSDALE RD UNIT 1012 PARADISE  
VALLEY AZ USA 85253

MCCORMICK RANCH GOLF CLUB INC  
7505 MCCORMICK PKWY SCOTTSDALE AZ USA  
85258

MCCRACKEN MALCOLM  
PO BOX 5053 WHITEFISH MT USA 59937

MERVIS ADAM J/KROACK LAUREL L  
2095 RESERVE WAY DECATUR IL USA 62521

MEYERS PHILLIP D/BARBARA J  
7123 E BLUEBIRD LN PARADISE VALLEY AZ USA  
85253-3639

MICHAEL OTHITES AND JOY OTHITES REV TRUST  
7045 N 69TH PL PARADISE VALLEY AZ USA  
85253

MIECZYSLAW & EWA BAK TRUST  
6440 STONERIDGE MALL RD UNIT K215  
PLEASANTON CA USA 94588

MILLER LEGACY HOMES LLC  
23016 N 19TH WAY PHOENIX AZ USA 85024

MILMOE WILLIAM H/JEANNE M  
180 NE 6TH AVE APT M DELRAY BEACH FL USA  
33483

MIRALAEFF GEORGE S SR TR  
6023 FOREST DR MORTRON GROVE IL USA  
60053

MIRCHANDANI PITU B  
7027 N SCOTTSDALE RD NO 230 SCOTTSDALE AZ  
USA 85253

MIT HOLDINGS LLC  
15720 N GREENWAY HAYDEN LOOP STE 1  
SCOTTSDALE AZ USA 85260

MITCHELL GARY/CONNIE  
6853 E MEADOWLARK LN PARADISE VALLEY AZ  
USA 85253

MKA FOUR LLC  
PO BOX 17202 PHOENIX AZ USA 85011

MORRIS THOMAS NORMAN/DENISE RUTH  
6930 E CACTUS WREN RD PARADISE VALLEY AZ  
USA 85253

MOWRY DEAN/NANCY  
6812 N 73RD ST SCOTTSDALE AZ USA 85250

MUNDHENKE GARY/MULLIGAN SUSAN L  
2615 S RIDGEVIEW WAY SIOUX FALLS SD USA  
57105

NAAB BRONSON/THOMPSON GRECIA  
14209 N 68TH ST SCOTTSDALE AZ USA 85254

NADRAMIA MICHAEL/RHONDA  
6810 N 72ND PL SCOTTSDALE AZ USA 85250

NANCY WHITMAN DICKSON REVOCABLE TRUST  
6869 E CACTUS WREN RD PARADISE VALLEY AZ  
USA 85253

NASHIF DOUGLAS M/DIANA/DOUGLAS  
M/DIANE S  
6825 NORTH 72ND PLACE SCOTTSDALE AZ USA  
85250

NEKZAD SHOAI/CHRISTIE M  
7291 N SCOTTSDALE RD UNIT 2002 PARADISE  
VALLEY AZ USA 85253

NELSON KELLY K  
7213 N 70TH ST PARADISE VALLEY AZ USA  
85253

NENAD FAMILY REVOCABLE LIVING TRUST  
6901 E CHENEY DR PARADISE VALLEY AZ USA  
85253

NERM LIVING TRUST  
7239 N MOCKINGBIRD LN PARADISE VALLEY AZ  
USA 85253

NEXT CHAPTER REAL ESTATE LLC  
6450 SAND LAKE RD STE 200 DAYTON OH USA  
45414

NIELSON DONALD L/VINI E TR  
7235 E CACTUS WREN RD SCOTTSDALE AZ USA  
85250

NNH LLC  
3370 N HAYDEN RD STE 123 PMB 941  
SCOTTSDALE AZ USA 85251

NOVIELLI KIMBERLY R  
5894 GLENEAGLES CIR SAN JOSE CA USA 95138

OCONNOR TIMOTHY P/JANET JANUARY  
PO BOX 4083 SCOTTSDALE AZ USA 85261

OGLE GWEN  
7291 N SCOTTSDALE RD UNIT 1002 PARADISE  
VALLEY AZ USA 85253

OKSANA ANN YUSUPOV QUALIFIED PERSONAL  
RESIDENCE TRUST/IGOR RICHARD YUSUPOV  
QUALIFIED PERSONAL RES TR  
7410 N 71ST PL PARADISE VALLEY AZ USA 85253

OLCHER KEN/BENNETT JENNIFER LYNN  
1607 W WHISPERING WIND DR PHOENIX AZ  
USA 85085

OLSEN LYNSIE  
7295 N SCOTTSDALE RD UNIT 1001 PARADISE  
VALLEY AZ USA 85253

ORANGE PENGUIN TRUST  
7275 N SCOTTSDALE RD UNIT 1017 PARADISE  
VALLEY AZ USA 85253-2616

ORCHID PARADISE LLC  
7009 E AVENIDA EL ALBA PARADISE VALLEY AZ  
USA 85253

ORRETT JENNIFER/ROSS  
6908 E HUMMINGBIRD LN PARADISE VALLEY AZ  
USA 85253

PARADISE VALLEY TOWN OF  
6401 E LINCOLN DR PARADISE VALLEY AZ USA  
85253

PATEL YATIN R  
7275 N SCOTTSDALE UNIT 1012 SCOTTSDALE AZ  
USA 85253

PEARL STEPHANIE RACHEL  
7027 N SCOTTSDALE RD NO 202 SCOTTSDALE AZ  
USA 85253

PHILIPOVITCH FAMILY TRUST  
3601 SPRINGBROOK ST DALLAS TX USA 75205

PIERCE ELIZABETH  
7291 N SCOTTSDALE RD NO 1001 SCOTTSDALE  
AZ USA 85253

PKS2 LLC  
2464 VINEYARD RD NOVATO CA USA 94947

PLENCNER RACHEL A  
16633 W LOMA ROJO CT SURPRISE AZ USA  
85387

POPICH ASHLEY/AMYRA L  
7027 N SCOTTSDALE RD SUITE 224 PARADISE  
VALLEY AZ USA 85253-3688

PRASIL FAMILY MATTERS LLC  
7275 N SCOTTSDALE RD UNIT 1007 PARADISE  
VALLEY AZ USA 85253

PRELL STEVEN J  
7291 N SCOTTSDALE RD UNIT 4013 SCOTTSDALE  
AZ USA 85253

PRICHARD WILLIAM/MARIAFRANCESCA  
7027 N SCOTTSDALE RD UNIT 130 PARADISE  
VALLEY AZ USA 85253

QAQISH IBRAHIM  
5625 E GROVERS AVE SCOTTSDALE AZ USA  
85254

R AND R MILLER FAMILY TRUST  
7301 N MOCKINGBIRD LN SCOTTSDALE AZ USA  
85253

RAMDAS INVESTMENTS I INC  
7201 N MOCKINGBIRD LN PARADISE VALLEY AZ  
USA 85253

RANDAL D VOSTI REVOCABLE TRUST  
904 LA TERRAZA CT MONTEREY CA USA 93940

RATUSHNY M SCOTT/MURDOCH LARA L  
81 ANATAPI LANE SW CALGARY AB CANADA  
T3H4G2

RCI WESTWAY LLC/KPN INDUSTRIAL LLC  
11225 W BERNARDO CT SUITE 100 SAN DIEGO  
CA USA 92127

REBECCA LEE BOWMAN TRUST  
6741 N INVERGORDAN RD PARADISE VALLEY AZ  
USA 85253

RED CEDAR TRUST  
7027 N SCOTTSDALE RD UNIT 212 PARADISE  
VALLEY AZ USA 85253

RETHORE BERNARD G/MICHELS SHIRLEY A  
7010 E AVENIDA EL ALBA PARADISE VALLEY AZ  
USA 85253

RICHARD DALE MUNSON REV TR/MUNSON  
CONSTANCE  
7298 N 71ST PL PARADISE VALLEY AZ USA 85253

RIVIERE M ELLIOT/MARGARET W  
6701 N SCOTTSDALE ROAD SCOTTSDALE AZ USA  
85250

RIZZO JOSEPH/DESPINA  
7291 N SCOTTSDALE RD UNIT 4009 PARADISE  
VALLEY AZ USA 85253

ROBBINS CAROL M  
7027 N SCOTTSDALE RD UNIT 214 SCOTTSDALE  
AZ USA 85253

ROBERT J AMMAN AND MARINA R AMMAN  
FAMILY TRUST  
6878 E CACTUS WREN RD PARADISE VALLEY AZ  
USA 85253

ROBERT M TAXIN LIVING TRUST  
6164 N LAS BRISAS DR PARADISE VALLEY AZ USA  
85253

ROBERT W STANTON IRREVOCABLE TRUST  
7181 N 68TH PL PARADISE VALLEY AZ USA  
85253

RODERICK S TERAUCHI AND REIKO TERAUCHI  
REVOCABLE TRUST  
2315 CEDAR ST EL CERRITO CA USA 94530

ROGERS JENNIFER CHRISTINE  
7027 N SCOTTSDALE RD UNIT 231 PARADISE  
VALLEY AZ USA 85253

ROLLINS TRUST  
251 KILIOOPU ST WAILUKU HI USA 96793

RONCK BRYAN/CATHERINE S  
4301 GLEN FALLS LN VAIL CO USA 81657

ROONEY THOMAS D/GILDA R  
7027 N SCOTTSDALE RD SCOTTSDALE AZ USA  
85253

ROTTUNDA KURTIS/ADRIANA  
7027 N SCOTTSDALE RD UNIT 112 PARADISE  
VALLEY AZ USA 85253

RUDIN JEFFREY S/PEARLMAN VIVIAN A  
4830 HIGHBURY LN MINNETONKA MN USA  
55345

SAFIR DOV  
10632 N SCOTTSDALE RD 488 SCOTTSDALE AZ  
USA 85254

SAM MARCHESE TRUST  
1436 N 143RD AVE OMAHA NE USA 68154

SANDRA BRUINSMA FAMILY TRUST 2017  
18-24528 STURGEON RD STURGEON COUNTY  
AB CANADA T8T0A1

SANDRA L PRICE LIVING TRUST  
7250 E JOSHUA TREE LN SCOTTSDALE AZ USA  
85250

SANDS NORTH TOWNHOUSES  
1450 E INDIAN SCHOOL RD STE C PHOENIX AZ  
USA 85014

SANDS RESIDENTIAL LLC  
801 S OLIVE ST UNIT 1506 LOS ANGELES CA USA  
90014

SANDS RESIDENTIAL LLC  
6130 W FLAMINGO RD STE 3006 LAS VEGAS NV  
USA 89103

SANDS RESIDENTIAL LLC  
6130 W FLAMINGO RD SUITE 3006 LAS VEGAS  
NV USA 89103

SANTUCCI FAMILY REVOCABLE TRUST  
6701 N SCOTTSDALE RD LOT 26 SCOTTSDALE AZ  
USA 85250

SAUNDERS JOSHUA  
6835 N 73RD ST SCOTTSDALE AZ USA 85250

SB TRUST  
15215 N KIERLAND BLVD UNIT 317 SCOTTSDALE  
AZ USA 85254

SCC ARTESIA LLC  
3300 ENTERPRISE PARKWAY BEACHWOOD OH  
USA 44122

SCHALLER JOEL L  
7171 E PARADISE CANYON RD PARADISE VALLEY  
AZ USA 85253-3176

SCHECHTER LAVI  
7297 N SCOTTSDALE RD UNIT 1002 PARADISE  
VALLEY AZ USA 85253

SCOTT CAPITAL MANAGEMENT INC  
7181 E CAMELBACK RD UNIT 704 SCOTTSDALE  
AZ USA 85251-8211

SCOTTSDALE CITY OF  
7447 E INDIAN SCHOOL RD STE 205  
SCOTTSDALE AZ USA 85251

SCOTTSDALE OFFICE CENTER LLC  
660 NEWPORT CENTER DR STE 1300 NEWPORT  
BEACH CA USA 92660

SCOTTSDALE SPECTRUM LLC  
6730 N SCOTTSDALE RD SCOTTSDALE AZ USA  
85253

SCRIBNER FAMILY TRUST  
6969 E PARADISE RANCH RD PARADISE VALLEY  
AZ USA 85253

SETOODEH ABRAHIM/SHAHAZ ASHLEY P  
7407 N 71ST PL PARADISE VALLEY AZ USA 85253

SFI ARTESIA LLC  
180 GLASTONBURY BLVD STE 201  
GLASTONBURY CT USA 06033

SHARON B SIEGEL REVOCABLE TRUST  
6983 E PARADISE RANCH RD PARADISE VALLEY  
AZ USA 85253

SHARON E IVES REVOCABLE TRUST  
7027 N SCOTTSDALE RD UNIT 240 SCOTTSDALE  
AZ USA 85253

SHEA HOMES LTD PARTNERSHIP  
8800 N GAINES CENTER DR STE 350  
SCOTTSDALE AZ USA 85258

SHORT ELIZABETH BADER  
7447 E SIERRA VISTA DR SCOTTSDALE AZ USA  
85250

SHUKUFUKU LLC  
12600 N 92ND PL SCOTTSDALE AZ USA 85260

SIEVERS AMANDA/LINGER ALEXA  
7310 E JOSHUA TREE LN SCOTTSDALE AZ USA  
85250

SINGER ROBERT/CYNTHIA MACDONALD  
6842 E HUMMINGBIRD LN PARADISE VALLEY AZ  
USA 85253

SK/MK TRUST  
6997 E PARADISE RANCH RD PARADISE VALLEY  
AZ USA 85257

SMITH REVOCABLE LIVING TRUST  
6615 N 39TH WAY PARADISE VALLEY AZ USA  
85253

SO MABEL/RONALD  
6701 N SCOTTSDALE RD NO 25 SCOTTSDALE AZ  
USA 85250

SO RONALD/MABEL  
6701 N SCOTTSDALE RD LOT 25 SCOTTSDALE AZ  
USA 85250-4404

SORENSEN PARADISE ESTATE LLC  
8702 N 65TH ST PARADISE VALLEY AZ USA  
85253

SORENSEN SCOTTSDALE ESTATE LLC  
8702 N 65TH ST PARADISE VALLEY AZ USA  
85253

SPRANDO PATRICIA L  
7257 SW ETON CT PORTLAND OR USA 97225

ST BARNABAS OF THE DESERT  
6715 N MOCKINGBIRD LN SCOTTSDALE AZ USA  
85253

ST PIERRE CASEY  
7027 N SCOTTSDALE RD UNIT 205 PARADISE  
VALLEY AZ USA 85253

STAMPS MICHAEL RAY TR/BEATRIZ GARCIA TR  
7115 N 69TH PL PARADISE VALLEY AZ USA  
85253

STEVEN J HILTON FAMILY TRUST/ETAL  
6893 E CACTUS WREN DR PARADISE VALLEY AZ  
USA 85253

STEWART JUSTIN LARRY/KELLI K  
6867 E MEADOWLARK LN PARADISE VALLEY AZ  
USA 85253

STONER ALAN B/CINDY M  
7154 W EUGIE AVE PEORIA AZ USA 85381

SUMMERS JOHN JR/KATINA P  
PO BOX 6100 SCOTTSDALE AZ USA 85261

SUNLIGHT PROPERTIES LLC  
7239 E CACTUS WREN RD SCOTTSDALE AZ USA  
85250

SWIDER MARISHA  
110 E CORTEZ DR NO 217 SEDONA AZ USA  
86351

SYLVIA F LITTLE LIVING TRUST  
10632 N SCOTTSDALE RD STE B-195  
SCOTTSDALE AZ USA 85254

TAFT DEREK  
2128 MT BRYNION RD KELSO WA USA 98626

TAFT MARK H/LORI L  
319 HAGENMAN RD KELSO WA USA 98626

TAFT MARK H/LORI L  
319 HAGEMAN RD KELSO WA USA 98626

TAN SHELLEY LYNN  
6357 WILD OAKS TER NORTHWEST PRIOR LAKE  
MN USA 55372

TAYLOR DARLA  
7027 N SCOTTSDALE RD SCOTTSDALE AZ USA  
85253

TEHRANI LEILA K  
6820 N 73RD ST SCOTTSDALE AZ USA 85250

TENGLER AZ RE HOLDINGS LLC  
864 OPHIR PEAK RD INCLINE VILLAGE NV USA  
89451

TENN FAMILY TRUST  
6917 E CACTUS WREN RD PARADISE VALLEY AZ  
USA 85253

THOMAS AND SABRINA PRASIL REVOCABLE  
TRUST  
7275 N SCOTTSDALE RD UNIT 1007 PARADISE  
VALLEY AZ USA 85253-2606

THOMAS M RETTLER REVOCABLE  
TRUST/COURTNAY A RETTLER REVOCABLE  
TRUST  
2328 E STIRLING PKWY APPLETON WI USA  
54913-7852

THURMAN FAMILY LIVING TRUST  
7002 N 68TH PL PARADISE VALLEY AZ USA  
85253

TIMMERMAN BRADLEY  
7291 N SCOTTSDALE RD UNIT 3006 SCOTTSDALE  
AZ USA 85253

TIMOTHY & NANCY CASSIDY FAMILY TRUST  
7275 N SCOTTSDALE RD UNIT 1002 PARADISE  
VALLEY AZ USA 85253

TOLLEN THOMAS/TIFFINIE  
7320 N 71ST ST PARADISE VALLEY AZ USA 85253

TOTH DOUGLAS F  
7027 N SCOTTSDALE RD SUITE 131 PARADISE  
VALLEY AZ USA 85253

TRAILOV TRENT J/HILLENBRAND TIA  
207 PARK LN APT 208 KIRKLAND WA USA 98033

TRAVIATA CONDOMINIUMS HOMEOWNERS  
ASSOC  
7255 E HAMPTON AVE STE 101 MESA AZ USA  
85209

TREGER SHANNON DEAN  
9145 N 70TH ST PARADISE VALLEY AZ USA  
85253

TROISI 7027 LLC  
8207 E BERRIDGE LN SCOTTSDALE AZ USA  
85250

TUCKER MARLENE ANN  
7027 N SCOTTSDALE RD SUITE 140 PARADISE  
VALLEY AZ USA 85253

UNDERHILL LARRY G TR  
2911 N FOSSIL RIM WITCHITA KS USA 67205

UNITED CHINA EDUCATION FOUNDATION INC  
7401 N SCOTTSDALE RD NO 42 PARADISE  
VALLEY AZ USA 85253

VALOS FAMILY LIVING TRUST  
7291 N SCOTTSDALE RD UNIT 3005 PARADISE  
VALLEY AZ USA 85253

VANDERPOEL MICHAEL/SHELLEY  
5013 W TAPPS DRIVE E LAKE TAPPS WA USA  
98391

VERNON RICHARD W TR  
6821 N 72ND PL SCOTTSDALE AZ USA 85253

VICORI REVOCABLE TRUST  
6890 E CACTUS WREN RD PARADISE VALLEY AZ  
USA 85253

VIKKI L RASKIN REVOCABLE TRUST  
6821 E JOSHUA TREE LN LOT 58 PARADISE  
VALLEY AZ USA 85253

WALKER WENDY R  
6701 N SCOTTSDALE RD UNIT 24 SCOTTSDALE  
AZ USA 85250

WARSTLER CAROLYN GUIMARIN  
6919 E JOSHUA TREE LN PARADISE VALLEY AZ  
USA 85253

WATSON GENE R/LAURA E  
7291 N SCOTTSDALE RD UNIT 3008 SCOTTSDALE  
AZ USA 85253

WECHSLER ROBERT L/BARBARA KAUFMAN  
7275 N SCOTTSDALE RD UNIT 1022 PARADISE  
VALLEY AZ USA 85253

WEISEL FAMILY TRUST  
6886 E JOSHUA TREE LN PARADISE VALLEY AZ  
USA 85253

WERNER MICHAEL/DENISE  
6920 E HUMMINGBIRD LN PARADISE VALLEY AZ  
USA 85253

WESTOVER DECEDENTS TRUST  
6835 E CHENEY RD PARADISE VALLEY AZ USA  
85253

WESTREICH DOROTHY/PHILLIP  
6701 N SCOTTSDALE RD UNIT 27 SCOTTSDALE  
AZ USA 85250

WHEELER MARGARET J  
6811 N 73RD ST SCOTTSDALE AZ USA 85250

WHITE JEROME S JR/JEANINE D  
1648 CANFIELD AVE PARK RIDGE IL USA 60068

WHITESTONE SEVILLE LLC  
2600 S GESSNER RD SUITE 500 HOUSTON TX  
USA 77063

WIENER SANDER N/LINDA B  
7012 E HUMMINGBIRD LN PARADISE VALLEY AZ  
USA 85253

WILL WINSTON HOLDINGS LLC  
6989 E CACTUS WREN RD PARADISE VALLEY AZ  
USA 85253

WILLENBRINK JEFFREY L  
7027 N SCOTTSDALE RD STE 129 PARADISE  
VALLEY AZ USA 85253-3685

WILLIAM BRADFORD LITLE AND MONICA SEGO  
LITLE TRUST  
7030 E CHENEY DR PARADISE VALLEY AZ USA  
85253

WILLIAMS BRIAN C/AMY N  
2715 84TH PL NE BELLEVUE WA USA 98004

WINCHELSEA LLC  
PO BOX 681 CAVE CREEK AZ USA 85327

WISHON MICHAEL/CAROL  
2632 SAMUEL DR OFALLON MO USA 63368

WOZNY ROBERT  
51500 STRATTON CT GRANGER IN USA 46530

YOUNG SCOTT DOUGLAS/GILROY DENISE LEE  
8755 E VIA DE ENCANTO SCOTTSDALE AZ USA  
85258

YOYO TRUST  
7525 E GAINNEY RANCH RD UNIT 115  
SCOTTSDALE AZ USA 85258

ZOWINE DAVID T TR  
6752 E ARROYO CT PARADISE VALLEY AZ USA  
85253