

# TOWN OF PARADISE VALLEY

“Pavement Management”  
Preserving The Town’s  
Roadways



# Purpose of Presentation

- Maintenance District 1, 3 & 9
- Palo Cristi Rd. from Lincoln Dr. to Stanford Dr.
- Program Schedule
- Project Summary
- Questions



# Maintenance Districts 1, 3 & 9

## Maintenance District 3:

- 3.9 linear miles of streets - Pavement Condition Index (PCI) rating between 57 to 65 which requires a full mill and a 1 ½ asphalt overlay.
- 4.6 linear miles of streets - PCI rating of 75 to 85 which requires crack seal and a High Density Mineral Bond (PMM) surface treatment.

## Maintenance Districts 1 & 9:

- 13.8 linear miles of streets - PCI rating of 75 to 85 which requires crack seal and a High Density Mineral Bond (PMM) surface treatment.

## Palo Cristi Rd:

- 1.0 linear mile – PCI rating of 57 which requires a full mill and a 1 ½ asphalt overlay.

## Staff recommends:

- Full mill and pave 4.9 linear miles of streets with a 1 ½ asphalt overlay.
- Apply crack seal material and High Density Mineral Bond (PMM) to the remaining 13.8 linear miles of streets.







**Section 1**  
 Crack Seal & PMM  
 • 6.41 Linear Miles  
 • 109,262 Square Yards  
 • Average PCI 73

Crack Seal & Surface Seal 

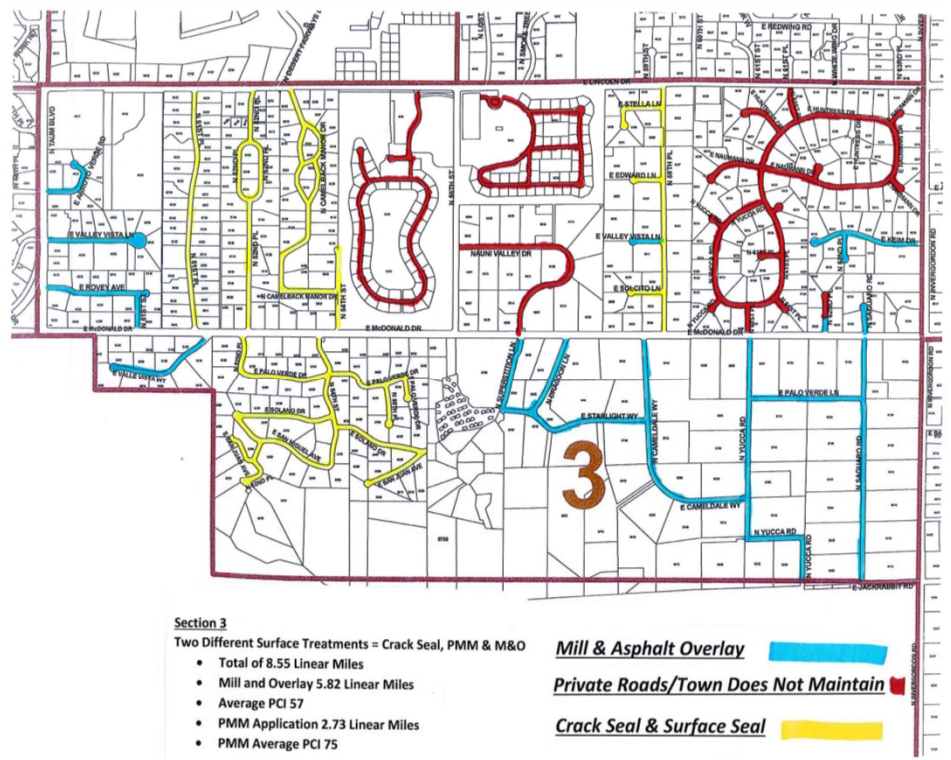

**Section 3**  
 Two Different Surface Treatments = Crack Seal, PMM & M&O  
 • Total of 8.55 Linear Miles  
 • Mill and Overlay 5.82 Linear Miles  
 • Average PCI 57  
 • PMM Application 2.73 Linear Miles  
 • PMM Average PCI 75

Mill & Asphalt Overlay 

Private Roads/Town Does Not Maintain 

Crack Seal & Surface Seal 



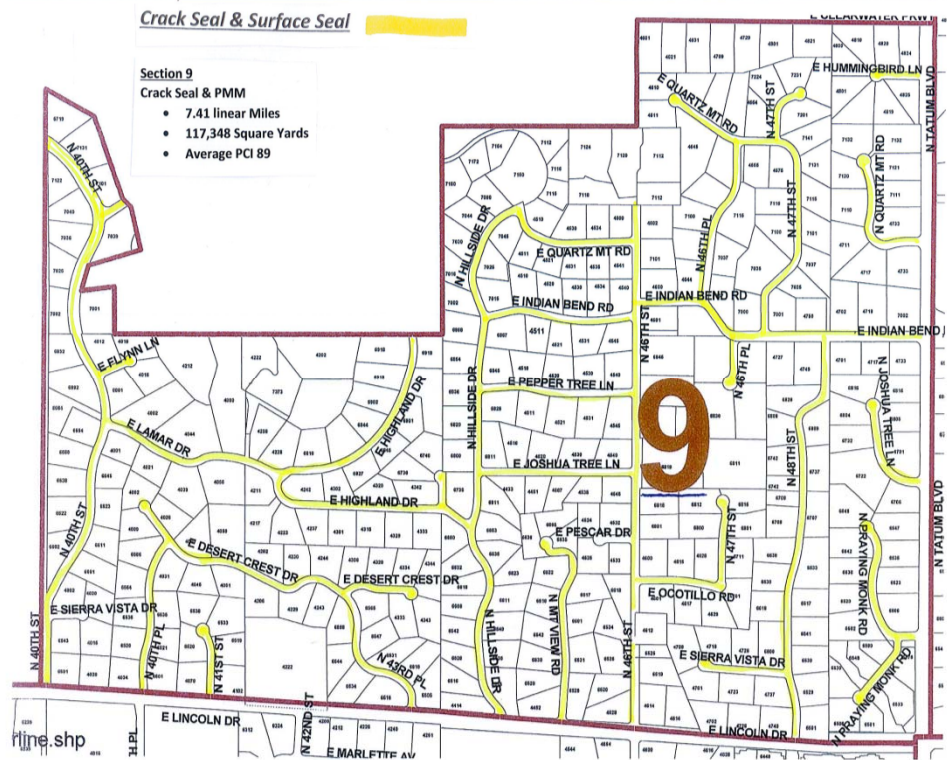

# FY16-17 Program Schedule

- Crack seal in maintenance districts 1, 3 & 9 in January and February of 2017.
- Full mill and pave 4.9 linear miles in maintenance district 3 and Palo Cristi Rd. April of 2017.
- Apply PMM beginning in April 2017 and completed by mid-June of 2017.



# FY16/17 Program Procurement

- The selection of contractors was completed through the use of cooperative purchasing agreements.
- City of Chandler – The City of Chandler currently has a contract with M.R. Tanner for the mill and overlay process.
- City of Buckeye – The City of Buckeye currently has a Job Order Contract (JOC) with Sunland Asphalt for the application of crack seal and high density mineral bond.





# FY16/17 Program Summary

- Cost for Asphalt Overlay = \$847,016.00 – M.R. Tanner
- Cost for Crack Seal & PMM = \$656,037.00 – Sunland Asphalt
- Total Combined Contract Cost = \$1,503,053.00
- Pavement Management Budget = \$1,540,000.00





# Pavement Management

## Questions?



April 2014

# 52nd St.

December 2016

