



---

George Burton  
Senior Planner  
Town of Paradise Valley  
6401 E. Lincoln Drive  
Paradise Valley, AZ 85253

Dear Resident:

Notice is hereby given that the Town of Paradise Valley Planning Commission will hold a public hearing at **6:00 p.m. on Tuesday, April 7, 2026**, at Town Hall, 6401 East Lincoln Drive, Paradise Valley, Arizona, 85253 for:

**PUBLIC HEARING:** Discussion and Possible Action on an application requesting an Intermediate Special Use Permit Amendment to the Phoenix County Day School Special Use Permit to renovate and update the existing baseball field, construct a new Wellness Center building, and add two new digital information signs (one in north parking lot and one in the east parking lot). The property is located at 3901 E. Stanford Drive (Assessor's Parcel Numbers 170-09-001B and 170-09-001A).

If you have any questions about this application, please call the Community Development Department at 480-348-3525.

Sincerely,

*George Burton*

Senior Planner

The Town of Paradise Valley endeavors to make all public meetings accessible to persons with disabilities. With 72 hours advance notice, special assistance can be provided for disabled persons at public meetings. Please call 480-948-7411 (voice) or 483-1811 (TDD) to request accommodation.

For further information about any of these matters, please contact the Community Development Department, 6401 E. Lincoln Drive, Paradise Valley, Arizona, 480-348-3692.

All agendas are subject to change. You can view the agenda, find application material, and provide your input via eComment approximately 4-6 days prior to the meeting date at <https://paradisevalleyaz.legistar.com/Calendar.aspx>. You may also contact the staff liaison, George Burton on this application at [gburton@paradisevalleyaz.gov](mailto:gburton@paradisevalleyaz.gov) or 480-348-3525 at any time before the scheduled meeting date.

Proposed Site Plan on Other Side 

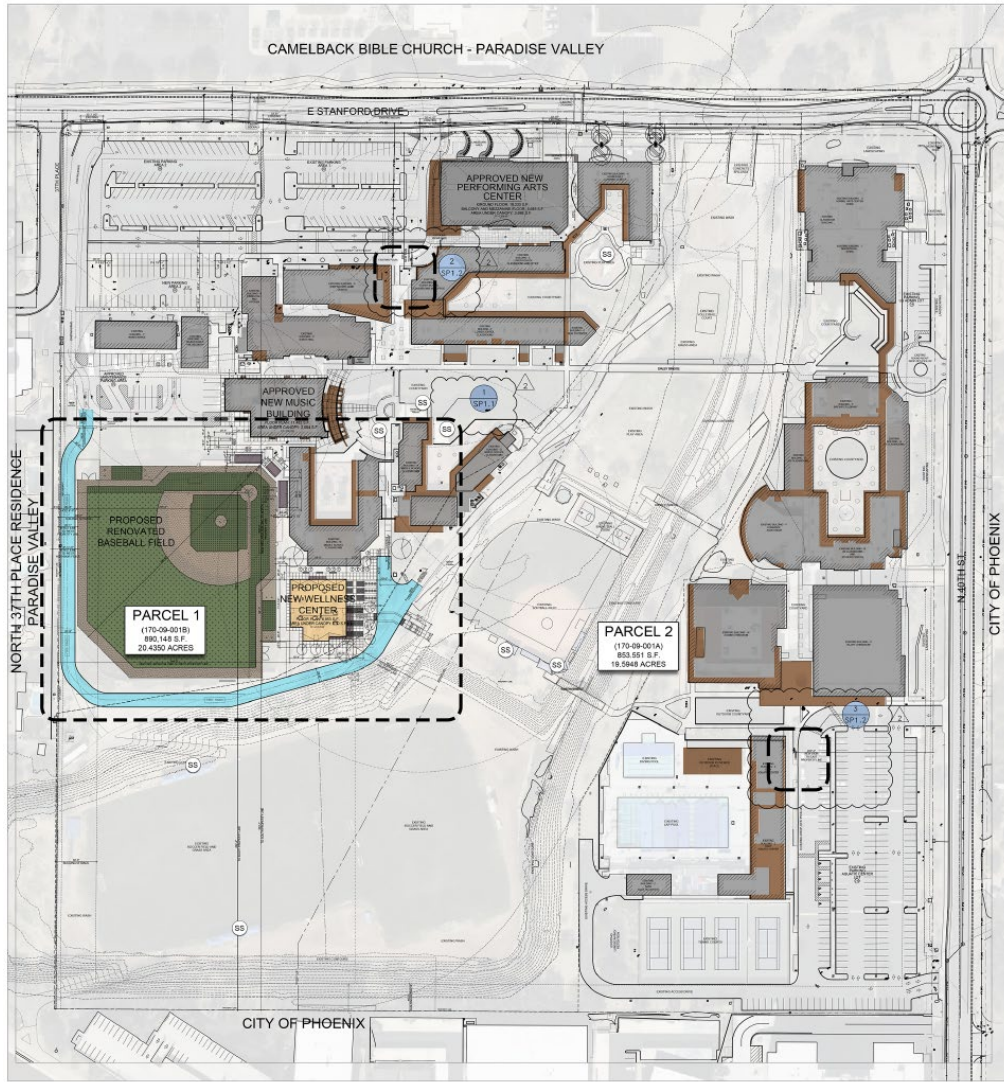

OVERALL ARCHITECTURAL PLAN LEGEND

	EXISTING GROSS BUILDING AREA		EMERGENCY SERVICE VEHICLES ACCESS ROUTE
	EXISTING COVERED EXTERIOR AREA		RENOVATED BASEBALL FIELD
	NEW GROSS BUILDING AREA		
	NEW COVERED EXTERIOR AREA		

 THIS SYMBOL INDICATES AN APPROVED SHADE COVER NOT TO EXCEED 20' OF HIGH COLORED SHADE COVER PER SQUARE TO BLANKING TRAIL. NO NEW SHADE STRUCTURES IN THIS PERMIT.

OVERALL ARCHITECTURAL SITE PLAN

SCALE: 1"=80'-0"



NORTH



3 - VIEW FROM FENCE LINE (PROPOSED RENOVATED BASEBALL FIELD)

SCALE: N.T.S.



2 - VIEW FROM FENCE LINE (PROPOSED RENOVATED BASEBALL FIELD)

SCALE: N.T.S.



1 - VIEW FROM FENCE LINE (PROPOSED RENOVATED BASEBALL FIELD)

SCALE: N.T.S.



3 - VIEW FROM FENCE LINE (EXISTING CONDITIONS)

SCALE: N.T.S.



2 - VIEW FROM FENCE LINE (EXISTING CONDITIONS)

SCALE: N.T.S.



1 - VIEW FROM FENCE LINE (EXISTING CONDITIONS)

SCALE: N.T.S.



# COMMUNITY DEVELOPMENT DEPARTMENT AFFIDAVIT OF MAILING NOTIFICATION

Town of Paradise Valley • 6401 East Lincoln Drive • Paradise Valley, Arizona 85253 • Phone: (480) 348-3692

STATE OF ARIZONA        )  
  ) ss:  
County of Maricopa        )

In accordance with the requirements of the Town of Paradise Valley, the undersigned hereby certifies that all the property owners within 1,500 feet of the property, as obtained from the Maricopa County Assessor's Office on March 9, 2026, for the proposed application PCDS SUP Amendment has been mailed on the following date March 13, 2026. (Case Number)

(This property list shall not be older than thirty (30) days at the time of filing of the application).

Kayla Amado  
\_\_\_\_\_  
*KA*  
\_\_\_\_\_

The foregoing instrument was acknowledged by me this 13<sup>th</sup> day of March, 2026, by Kayla Amado.  
Name

*Emily Ragsdale*  
\_\_\_\_\_  
NOTARY PUBLIC

My commission expires:  
March 11, 2029

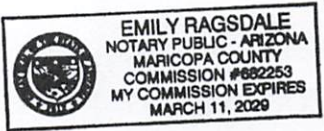

3702 E CAMELBACK LLC  
3702 E CAMELBACK RD  
PHOENIX AZ 85018

3900 E STANFORD LLC  
3900 E STANFORD DR  
PARADISE VALLEY AZ 85253

4040 EAST CAMELBACK ROAD LLC  
1505 S REDWOOD RD  
SALT LAKE CITY UT 84104

4040 EAST CAMELBACK ROAD LLC  
1505 S REDWOOD DR  
SALT LAKE CITY UT 84104

4211 STANFORD LLC  
4211 E STANFORD DR  
PHOENIX AZ 85018

5060 BUILDING LLC  
2400 E ARIZONA BILTMORE CIR STE 1200  
PHOENIX AZ 85016

5141 BUILDING LLC  
5141 N 40TH ST 500  
PHOENIX AZ 85018

51ZERO8 LLC  
5202 S 40TH ST  
PHOENIX AZ 85040

A & M TRUST  
4647 N 32ND ST B-245  
PHOENIX AZ 85018

ADC LIVING TRUST  
4024 E SAN MIGUEL AVE  
PHOENIX AZ 85018

ADRIAN V BALDERRAMA LIVING TRUST  
3710 E ORANGE DR  
PHOENIX AZ 85018

ALBER DANIEL/KRISTIN  
15833 S 36TH ST  
PHOENIX AZ 85048

ALLAN H GELBER TRUST  
5329 N 41ST PL  
PHOENIX AZ 85018

ALLREDS HERMOSA INN LLC  
2 POURTALES RD  
COLORADO SPRINGS CO 80906

AMY MENOUSEK REVOCABLE TRUST  
3811 E SOLANO DR  
PARADISE VALLEY AZ 85253

ANDRE AND MAGGIE ETHIER REVOCABLE  
LIVING TRUST  
14350 N 87TH ST 185  
SCOTTSDALE AZ 85260

ANNE TAYLOR KUNKEL TRUST  
5425 N 41ST ST  
PHOENIX AZ 85018

ARCADIA RENTAL PROPERTIES LLC  
3825 E CAMELBACK RD UNIT 282  
PHOENIX AZ 85018

ARCADIA SURVIVORS TRUST/ACRCADIA  
DECEDENTS TRUST  
5119 N 41ST ST  
PHOENIX AZ 85018

ARCADIA VILLA LLC  
600 MAMARONECK AVE FL 5  
HARRISON NY 10528

ASSET MANAGEMENT SPECIALISTS LLC  
2633 E INDIAN SCHOOL RD STE 320  
PHOENIX AZ 85016

ATON FAMILY REVOCABLE LIVING TRUST  
3614 E ORANGE DR  
PHOENIX AZ 85018

AUER HEATHER/SAVANNAH  
35404 N 87TH PL  
SCOTTSDALE AZ 85266

AZ7 LLC  
445 HAMILTON AVE STE 700  
WHITE PLAINS NY 10601

AZHAR NILI/URDANETA JOSE J  
5050 N 38TH PL  
PHOENIX AZ 85018

BACKMAN STEPHEN  
CHRISTOPHER/GUARINO MEGHAN RENEE  
3642 E PASADENA AVE  
PHOENIX AZ 85018

BAKER MARIAN  
5102 N 41ST ST  
PHOENIX AZ 85018

BALL ROBERT B & MELANIE L  
4039 E SAN MIGUEL  
PHOENIX AZ 85018

BALLAST LIVING TRUST  
3601 E MEDLOCK DR  
PHOENIX AZ 85018

BARBARA GOULD REVOCABLE LIVING TRUST  
3630 E COLTER ST  
PHOENIX AZ 85018

BARRETT REBEKAH S/BLOMGREN PETER A  
4010 E SAN JUAN AVE  
PHOENIX AZ 85018

BASSUK LIVING TRUST  
5507 N CALLE DEL SANTO  
PHOENIX AZ 85018

BAUER BRITTANY N  
3825 E CAMELBACK RD UNIT 286  
PHOENIX AZ 85018

BELDEN CRISTINA  
4126 E MEDLOCK DR  
PHOENIX AZ 85018

BELDEN FAMILY TRUST  
5240 N 41ST PL  
PHOENIX AZ 85018

BELOW SCOTTSDALE LLC  
9626 N 35TH PL  
PHOENIX AZ 85028

BENNETT JOSEPH J/SANDRA K TR  
5319 N 40TH ST  
PHOENIX AZ 85018

BESANCON JAMES ADRIAN/RACHEL ERIN  
5101 N 41ST ST  
PHOENIX AZ 85018

BILTMORE SANCTUARY HOA INC  
3808 E CAMELBACK RD  
PHOENIX AZ 85018

BILTMORE SANCTUARY HOA INC  
1606 W WHISPERING WIND DR  
PHOENIX AZ 85085

BILTMORE SANCTUARY IRREVOCABLE TRUST  
3808 E CAMELBACK RD  
PHOENIX AZ 85018

BLAIR HOLDINGS LIMITED PARTNERSHIP  
305 W ROSE LN  
PHOENIX AZ 85013

BLAKE WILLIAM TONN AND CAROLINE  
NICOLE TONN FAMILY TRUST  
3722 E PASADENA AVE  
PHOENIX AZ 85018

BLOCK FAMILY LIVING TRUST  
4111 E SAN MIGUEL AVE  
PHOENIX AZ 85018

BLOOM TRAVIS R/TEALE L  
5220 N 42ND PL  
PHOENIX AZ 85018

BOWERS FAMILY TRUST  
7306 TRASK AVE  
PLAYA DEL REY CA 90293

BOYD JAMES P/ELIZABETH TR  
5602 N ROYAL CIR  
PARADISE VALLEY AZ 85253

BQ HOLDINGS LLC  
6527 N 31ST WAY  
PHOENIX AZ 85016

BRADFORD P TERRY SEPARATE PROPERTY  
TRUST  
5603 N CALLE DEL SANTO  
PHOENIX AZ 85018

BRAMLET FAMILY LIVING TRUST  
3701 E MEDLOCK DR  
PHOENIX AZ 85018

BREAM SCOTT/SHELLY  
4111 E PASADENA AVE  
PHOENIX AZ 850181618

BRENDA L JOHNSON REVOCABLE TRUST  
5434 E LINCOLN DR 77  
PARADISE VALLEY AZ 85253

BRETT S DRUMMOND TRUST  
3643 E COLTER ST  
PHOENIX AZ 85018

BRIAN AND ERIN CAIN LIVING TRUST  
5311 N 37TH PL  
PARADISE VALLEY AZ 85253

BRICHER JENNA L  
3825 E CAMELBACK RD 190  
PHOENIX AZ 85018

BRIGGS JOE DALE III/WHITNEY  
4010 E MONTEBELLO AVE  
PHOENIX AZ 85018

BRILL LIVING TRUST  
3639 E DENTON LN  
PARADISE VALLEY AZ 85253

BROCKMAN TREACY L  
5001 N 38TH PL  
PHOENIX AZ 85018

BROWN FAMILY TRUST  
5519 N CALLE DEL SANTO  
PHOENIX AZ 85018

BUKOVEC ROBERT/JENNIFER  
4139 E MEDLOCK DR  
PHOENIX AZ 85018

BURR RYAN/MADISON  
3624 E COLTER ST  
PHOENIX AZ 85018

BUSHARD FAMILY TRUST  
5316 N 42ND PL  
PHOENIX AZ 85018

CACTUS REUNION LLC  
1515 E MISSOURI AVE 201  
PHOENIX AZ 85014

CAIRN108 LLC  
5648 N DELOS CIR  
PARADISE VALLEY AZ 85253

CAMELBACK TERRACES  
7009 E ACOMA DR STE 1004  
SCOTTSDALE AZ 85254

CAMUNEZ DINO R/BLEEKER-CAMUNEZ HEIDI  
C  
3702 E MEDLOCK DR  
PHOENIX AZ 85018

CANTOR STIRLEY N  
3638 E ORANGE DR  
PHOENIX AZ 85018

CANTWELL ROBERT J & KATHERINE A  
3701 E PASADENA  
PHOENIX AZ 85018

CAPRI CAMELBACK GARDENS LP/DG201  
CAPRI CAMELBACK LLC/ETAL  
999 WATERSIDE DR STE 2300  
NORFOLK VA 23510

CAROLE FERRIS KROEGER 2021  
IRREVOCABLE TRUST  
4026 E SAINT JOSEPH WAY  
PHOENIX AZ 85018

CARTER JOHN PATRICK/ALISON PULASKI  
5401 N 41ST ST  
PHOENIX AZ 85018

CASA COCO TRUST  
5325 N 41ST ST  
PHOENIX AZ 85018

CASE VENTURES LLC  
10143 E CLINTON ST  
SCOTTSDALE AZ 85260

CASTIGLIA ANTHONY/HILARY  
4112 E PASADENA AVE  
PHOENIX AZ 850181619

CHARLAND JOHN E/DE LOURDES  
4115 S MONTEBELLO  
PHOENIX AZ 85018

CHARLES AND BARBRA RIGNEY LIVING  
TRUST  
4026 E MONTEBELLO AVE  
PHOENIX AZ 850181120

CHARLES JAMES KEENLEY SEPARATE  
PROPERTY TRUST  
10632 N SCOTTSDALE RD STE 118  
SCOTTSDALE AZ 85254

CHRISTINA W KEARNEY LIVING TRUST  
3532 E ORANGE DR  
PHOENIX AZ 85018

CHRISTOPHER AND LAURA CROWNOVER  
JOINT TRUST  
61474 E MONTEBELLO AVE  
PHOENIX AZ 85018

CHRISTOPHER GERALD HAHN AND MIRIAM  
THERESE HAHN REVOCABLE TRUST  
4131 E MEDLOCK DR  
PHOENIX AZ 85018

CIUTAC BOGDAN/DRAGAN SELAGINELA  
3560 E OREGON AVE  
PHOENIX AZ 85018

CLARK FAMILY LIVING TRUST  
3740 E PASADENA AVE  
PHOENIX AZ 85018

CLARK JAMES P TR  
4105 E STANFORD DR  
PHOENIX AZ 85012

CLR REVOCABLE TRUST/LAR REVOCABLE  
TRUST  
2236 GULF SHORE BLVD  
NAPLES FL 34102

COHEN BABAK/SHARONA  
5504 N CALLE DEL SANTO  
PHOENIX AZ 85018

COHEN FAMILY L L C  
8 BILTMORE EST UNIT 215  
PHOENIX AZ 85016

COLETTI JULIE  
4107 E SAN MIGUEL AVE  
PHOENIX AZ 85018

COLLINS WALTER V  
3650 E ORANGE DR  
PHOENIX AZ 85018

CONANT JERRY & GAIL A TR  
4001 E STANFORD DR  
PHOENIX AZ 85018

CONELLY CHAD H  
4011 E SAN JUAN AVE  
PHOENIX AZ 85018

COZY ON CAMELBACK LLC  
40623 N KEY LN  
ANTHEM AZ 85086

CPG PRIVATE TRUST  
6115 E SAN BERNADINO  
TUCSON AZ 85715

CROGNALE FAMILY LIVING TRUST  
4105 E MONTEBELLO AVE  
PHOENIX AZ 85018

CROWLEY TED J & KATHLEEN M  
4102 E ST JOSEPH WAY  
PHOENIX AZ 85018

CURTIS JAY VARNER AND SUE-MENG LAU  
LIVING TRUST  
3653 E STANFORD DR  
PARADISE VALLEY AZ 85253

DADAM JOHN JR/BARBARA TR  
5520 N 40TH ST  
PARADISE VALLEY AZ 85253

DANIEL P KRIVICKAS JR LIVING TRUST  
3935 E SAN MIGUEL AVE  
PARADISE VALLEY AZ 85253

DAVID ALLEN MERICLE FAMILY TRUST  
5018 N 38TH PL  
PHOENIX AZ 85018

DAVIES FAMILY TRUST  
3921 E SOLANO DR  
PARADISE VALLEY AZ 85253

DB AZ LLC  
5310 N 37TH PL  
PARADISE VALLEY AZ 85253

DEAL MCKENZIE L  
4106 E CAMELBACK RD  
PHOENIX AZ 85018

DECKER LE JEUNE  
5325 N 37TH PL  
PARADISE VALLEY AZ 85253

DELUCA LAWRENCE/ELIZABETH LEE  
4103 E SAINT JOSEPH WAY  
PHOENIX AZ 85018

DEMPSEY PATRICIA G TR  
3623 E COLTER ST  
PHOENIX AZ 85018

DENTON HOLDINGS LLC  
3000 POSTON AVE STE 301  
NASHVILLE TN 37203

DEVELOPMENT SERVICES OF AMERICA INC  
16100 N 71ST ST STE 520  
SCOTTSDALE AZ 85254

DEVINE CARIBE  
3813 E PASADENA AVE  
PHOENIX AZ 85018

DHILLON SIMI/ANTAL MANDEEP  
3737 E MEDLOCK DR  
PHOENIX AZ 85018

DI FULGO TRACY M/GASS STEPHANIE A  
121 W LANDING  
WILLIAMSBURG VA 23185

DIANA TAURASI AND PENELOPE TAYLOR  
REVOCABLE FAMILY TRUST  
4031 E MONTEBELLO AVE  
PHOENIX AZ 85018

DITTER STEVEN J  
5225 N 40TH ST  
PHOENIX AZ 85018

DITULLIO JOHN D/FAVOUR LYNN A  
4130 E SAN MIGUEL  
PHOENIX AZ 85018

DREAM WEAVER TRUST  
7904 E CHAPARRAL RD STE A110 512  
SCOTTSDALE AZ 85250

DRNJEVIC REVOCABLE TRUST  
4032 E ST JOSEPH WY  
PHOENIX AZ 85018

DUTCHER ABBY  
3825 E CAMELBACK RD UNIT 283  
PHOENIX AZ 850182651

EDGE CAMINO LLC  
4408 N 12TH ST STE 200  
PHOENIX AZ 85014

EDGERTON MAX A/MAXINE A TR  
4110 E CAMELBACK RD  
PHOENIX AZ 85018

EIFLER FAMILY TRUST  
5630 N DELOS CIR  
PARADISE VALLEY AZ 85253

EIFLER GEORGE TR  
4109 E ST JOSEPH WY  
PHOENIX AZ 85018

EIFLER LISA R  
3825 E CAMELBACK RD UNIT 187  
PHOENIX AZ 85018

EISENSTADT MATTHEW E/RACHAEL B  
9070 E GARY RD UNIT 120  
SCOTTSDALE AZ 85260

ELLER ACQUISITION INC  
4686 E VAN BUREN STE 200  
PHOENIX AZ 85008

ENTZ TRUST  
3632 E PASADENA AVE  
PHOENIX AZ 85018

ERIC AND JANA WOOD REVOCABLE TRUST  
3808 E PASADENA AVE  
PHOENIX AZ 85018

ERIC AND KERRI NELSON TRUST  
4016 E SAN MIGUEL AVE  
PHOENIX AZ 85018

ERIC L MEYEROWITZ REVOCABLE TRUST  
4127 E SAN MIGUEL AVE  
PHOENIX AZ 85018

ESSERT SHANE/MORGANNE  
4111 E MEDLOCK DR  
PHOENIX AZ 85018

EVN TRUST  
3653 E COLTER  
PHOENIX AZ 85018

F BENNETT FAMILY TRUST  
4128 E SAINT JOSEPH WAY  
PHOENIX AZ 85018

FABRICANT LAURA M TR  
5301 N 37TH PL  
PARADISE VALLEY AZ 85253

FARROKH FAMILY TRUST  
3727 E PASADENA AVE  
PHOENIX AZ 85018

FATTALEH ALICE  
PO BOX 15934  
PHOENIX AZ 850605934

FENDER GERTRUDE  
3825 E CAMELBACK RD UNIT 101  
PHOENIX AZ 0

FISCHER ARON/STACY  
4002 E SAN JUAN AVE  
PHOENIX AZ 85018

FITZPATRICK ALBERT E II/MELISSA  
5830 N 12TH PL 2  
PHOENIX AZ 85014

FJCJ LIVING TRUST  
3741 E PASADENA AVE  
PHOENIX AZ 85018

FL SAWALHA FAMILY TRUST  
5302 N 41ST ST  
PHOENIX AZ 85018

FLOOD CONTROL DISTRICT OF MARICOPA  
COUNTY  
2801 W DURANGO ST  
PHOENIX AZ 85009

FLOOD WILLIAM C/DARCYANNE H  
3825 E CAMELBACK RD UNIT 192  
PHOENIX AZ 85018

FLYING J RANCH FAMILY TRUST  
4101 E SOLANO DR  
PHOENIX AZ 85018

FORTRESS OF SOLITUDE REVOCABLE TRUST  
3219 E CAMELBACK RD STE 419  
PHOENIX AZ 85018

FOTH BENJAMIN  
3825 E CAMELBACK RD UNIT 201  
PHOENIX AZ 850182641

FRAKES BRIAN/CHRISTIE TR  
3616 E MEDLOCK DR  
PHOENIX AZ 85018

FREUND KARL/ASHLEY  
3636 E CAMELBACK RD  
PHOENIX AZ 85018

FREVOLA FAMILY TRUST  
3628 E MEDLOCK DR  
PHOENIX AZ 85018

FUDENNA BROS INC  
PO BOX 1636  
FREMONT CA 94538

FULLER ALFRED W/MICHELLE C TR  
3611 E PASADENA AVE  
PHOENIX AZ 85018

GAMMAGE AND YOUSSE LIVING TRUST  
4115 E COLTER ST  
PHOENIX AZ 85018

GAMMAGE AND YOUSSE LIVING TRUST  
4415 E COLTER ST  
PHOENIX AZ 85018

GATT KEN J  
3612 E PASADENA AVE  
PHOENIX AZ 85018

GEORGE R HARRIS REVOCABLE LIVING  
TRUST  
PO BOX 864  
WILSON WY 83014

GEORGELOS PAMELA G/DEMETRA V  
3802 E SOLANO DR  
PARADISE VALLEY AZ 85253

GERALD AND JUDITH DEFALCO TRUST  
4104 E PASADENA AVE  
PHOENIX AZ 85018

GIBBS WILLIAM H  
3902 E SOLANO DR  
PARADISE VALLEY AZ 85253

GLASS SCOT K/CAROLYN A  
5205 N 41ST PL  
PHOENIX AZ 85018

GLEN B LOCKWOOD AND TERESA S  
LOCKWOOD TRUST  
4043 E MONTEBELLO AVE  
PHOENIX AZ 85018

GLORIA J GRADY TRUST  
5648 N ROYAL CIR  
PARADISE VALLEY AZ 85253

GOLDSTEIN FAMILY TRUST  
4043 E SOLANO DR  
PHOENIX AZ 85018

GREENWOOD FAMILY TRUST  
3601 E PASADENA AVE  
PHOENIX AZ 85018

GRONINGER CHRISTINE L  
5053 N 38TH PL  
PHOENIX AZ 85018

GROOVER JOHN/KELLY-GROOVER LORRAINE  
4106 E SAN MIGUEL AVE  
PHOENIX AZ 85018

GROVER JAMES MADISON  
3812 E CAMELBACK RD  
PHOENIX AZ 85018

GURUSWAMY VIVEK/SARAH JANE  
4037 E SOLANO DR  
PHOENIX AZ 85018

GUY G WILLIAMS REVOCABLE TRUST  
20 WATTES LANDING RD  
FALMOUTH ME 4105

HABERMAN DONALD C/LIDIA W TR  
4042 E SAN MIGUEL AVE  
PHOENIX AZ 85018

HACKER DALLAS  
3825 E CAMELBACK RD UNIT 291  
PHOENIX AZ 85018

HACKETT ROBERT C/SHERRIE A TR  
3616 E DENTON LN  
PARADISE VALLEY AZ 85253

HAKAK AMIR  
3130 N 62ND ST AT  
SCOTTSDALE AZ 85251

HANS PETER EDELSTEIN FAMILY TRUST  
1721 E HATCHER DR  
PHOENIX AZ 85020

HARRINGTON JAMES P/TAMYRA MAY  
3732 E PASADENA  
PHOENIX AZ 85018

HARRISON DEVELOPMENT LLC  
5112 N 40TH ST STE 105  
PHOENIX AZ 85018

HART BRIAN WILLIAM/YU SOOJIE  
4020 E COLTER ST  
PHOENIX AZ 85018

HAYDON DAVID/JANENE D  
5072 N 38TH PL  
PHOENIX AZ 85018

HENRY LINDA M/MARKOVITS MICHAEL JAY  
25 FOREST ST 17C  
STAMFORD CT 69011854

HILLER FAMILY TRUST  
5342 N 37TH PL  
PARADISE VALLEY AZ 85253

HIRSCH JEFFREY WALTER/DOROTHY ZOLLO  
5302 N 42ND PL  
PHOENIX AZ 85018

HOBAICA DANIEL/LORA  
4040 E CUDIA WAY  
PHOENIX AZ 85018

HOBSON HILLARY  
1537 VRAIN ST  
DENVER CO 80204

HOGAN FAMILY TRUST  
5120 N 42ND PL  
PHOENIX AZ 85018

HOH PV LLC  
11811 N TATUM BLVD STE 1051  
PHOENIX AZ 85028

HORNADAY JAMES Q  
5128 N 41ST ST  
PHOENIX AZ 85018

HOSMAR MICHAEL D/MICHELLE M  
3805 E SOLANO DR  
PARADISE VALLEY AZ 85253

HULSTON FAMILY TRUST  
5301 N 40TH ST  
PHOENIX AZ 85018

HUNDELT REVOCABLE TRUST  
7110 N 46TH ST  
PARADISE VALLEY AZ 85253

HUNTER MICHAEL/DAWN  
5017 N 38TH PL  
PHOENIX AZ 85018

HUTCHISON REVOCABLE LIVING TRUST  
3814 E PASADENA AVE  
PHOENIX AZ 85018

IMMELMAN STEWART P/PRINDLE ANGELA M  
3550 E MEDLOCK DR  
PHOENIX AZ 85018

JACK DIAMOND REVOCABLE TRUST  
5249 N 37TH PL  
PARADISE VALLEY AZ 85253

JACQUES RAOUL T  
5315 N 41ST ST  
PHOENIX AZ 85018

JAMES ALEXIS MILAN  
5707 N 40TH ST  
PHOENIX AZ 85018

JAMES JOSEPH AND CHIRL ANN SIENICKI  
REV TRUST  
5213 N 36TH ST  
PHOENIX AZ 85018

JASON AND ERICA BLAIN FAMILY TRUST  
4042 E MONTEBELLO AVE  
PHOENIX AZ 85018

JAYASEKERA CHANNA R  
7117 E RANCHO VISTA DR UNIT 1012  
SCOTTSDALE AZ 85251

JEFFREY AND DENA CUTBERTH FAMILY  
TRUST  
3626 E CAMELBACK RD  
PHOENIX AZ 85018

JEROME ECHARD LIVING TRUST  
5429 N 41ST PL  
PHOENIX AZ 85018

JOHN DONNER & LORETTA JEAN JONES REV  
LIV TR  
3721 E PASADENA AVE  
PHOENIX AZ 85018

JOHN TYRRELL TABER REVOCABLE LIVING  
TRUST  
3702 E PASADENA AVE  
PHOENIX AZ 85018

JONES KYLE S/MARY E TR  
3835 E SAN MIGUEL  
PARADISE VALLEY AZ 85253

JONES THOMAS EDWARD/JOHN PAUL/YING  
3825 E CAMELBACK RD UNIT 183  
PHOENIX AZ 85018

JOSEPH PETERCHAK TRUST/JEANNE M  
PICERNE TRUST  
304 S LINCOLN ST  
HINDSDALE IL 60521

KANI TRUST  
3662 E DENTON LN  
PARADISE VALLEY AZ 85253

KAPLAN CHRIS J/CAMERON  
4102 E MONTEBELLO AVE  
PHOENIX AZ 85018

KAROL M DEHLINGER REVOCABLE TRUST  
5140 N 36TH ST  
PHOENIX AZ 85018

KATIE JO ROBERSON LIVING TRUST  
3819 E PASADENA AVE  
PHOENIX AZ 85018

KEARNEY RICHARD BRIAN/HUTCHINSON  
JEAN C  
4121 E MEDLOCK DR  
PHOENIX AZ 85018

KEENAN TIGHE TRUST  
4011 N 40TH PL  
PHOENIX AZ 85018

KEKELA RYAN  
3825 E CAMELBACK RD UNIT 106  
PHOENIX AZ 85018

KELLY ROBINSON KLOSE REVOCABLE TRUST  
5135 N 41ST PL  
PHOENIX AZ 85018

KELTZ FAMILY TRUST  
5132 N 42ND PL  
PHOENIX AZ 85018

KERKORIAN JOHN G/STEPHANIE B TR  
3817 E SAN MIGUEL AVE  
PARADISE VALLEY AZ 85253

KEVIN DAY AND REBECCA L DAY TRUST  
5601 N DELOS CIR  
PARADISE VALLEY AZ 85253

KIERAN JENNEFER ANNE  
5648 N 40TH ST  
PARADISE VALLEY AZ 85253

KIRBY LOUIS C II/COLOMBO CAROL A  
5633 N ROYAL CIR  
PARADISE VALLEY AZ 85253

KIRK JASON M  
4035 E CUDIA WAY  
PHOENIX AZ 85018

KNAPP AND PETERSON LIVING TRUST  
5010 N 38TH PL  
PHOENIX AZ 85018

KOPPELL JONATHAN/STEEN JENNIFER  
5223 N 41ST PL  
PHOENIX AZ 85018

KRG PHOENIX ARCADIA VILLAGE LLC  
30 S MERIDIAN ST STE 1100  
INDIANAPOLIS IN 46204

KROEGER LIVING TRUST  
5535 N CAMINO DEL CONTENTO  
PARADISE VALLEY AZ 852537505

KUEHN AMANDA L  
3825 E CAMELBACK RD UNIT 285  
PHOENIX AZ 85018

KUSMAN FAMILY TRUST  
3712 E PASADENA AVE  
PHOENIX AZ 85018

LAINÉ KEAHEY TRUST  
5430 N 41ST ST  
PHOENIX AZ 85018

LAVELLE MATTHEW K/KIMBERLY B  
5340 N PALO CRISTI RD  
PARADISE VALLEY AZ 85253

LEPINSKAS KENNETH MICHAEL/NEAL  
DANIELLE  
4031 E SAN MIGUEL AVE  
PHOENIX AZ 85018

LIENAU JESSICA ANNE  
4130 E MEDLOCK DR  
PHOENIX AZ 85018

LIPSON MICHAEL J/STEFANIE R TR  
PO BOX 32042  
PHOENIX AZ 850642042

LIVINGOOD ROGER D/GLORIA J TR  
4122 S SAN MIGUEL AVE  
PHOENIX AZ 85018

LOCHRIDGE BLANE B/KATHLEEN S  
3825 E CAMELBACK RD UNIT 104  
PHOENIX AZ 85018

LOFTIN JAMES A/HEIDI A TR  
5631 N DELOS CIR  
PARADISE VALLEY AZ 85253

LOPATIN IAN  
5330 N PALO CRISTI RD  
PARADISE VALLEY AZ 85253

LOUGHNEY CHRISTOPHER/MOLLY  
3602 E COLTER ST  
PHOENIX AZ 85018

LUTICH JOHN P/JAN M  
3616 E COLTER ST  
PHOENIX AZ 85018

M & T INVESTMENTS LLV  
386 SCHWAN LN  
WOODWAY TX 76712

M4 5050 LLC  
100 BAYVIEW CIR STE 4500  
NEWPORT BEACH CA 92660

MAINGI CHETAN P  
3831 E CAMELBACK RD UNIT 103  
PHOENIX AZ 85018

MALONE FAMILY TRUST  
3627 E ORANGE DR  
PHOENIX AZ 85018

MANSOUR FAMILY TRUST  
3639 E ORANGE DR  
PHOENIX AZ 85018

MARK S COLLINS TRUST  
5632 N ROYAL CIR  
PARADISE VALLEY AZ 85253

MARTHA A WARNOCK TRUST  
4151 E ST JOSEPH WAY  
PHOENIX AZ 85018

MARTYNIUK RYSZARD D/CATHERINE F  
4035 E STANFORD DR  
PHOENIX AZ 85018

MARY L SHAW TRUST  
4014 E ST JOSEPH WAY  
PHOENIX AZ 85018

MASF TRUST  
5632 N 40TH ST  
PARADISE VALLEY AZ 85253

MASRY HICHAM EL/MINA LIDA A  
4025 COLTER ST  
PHOENIX AZ 850181611

MASSINGALE BRIAN D/MICHELLE L TR  
5513 N CALLE DEL SANTO  
PHOENIX AZ 85018

MATTHEW AND ANNE HAZARD LIVING TRUST  
4101 E SAN MIGUEL AVE  
PHOENIX AZ 85018

MATTHEW B MCNEIL TRUST  
3730 E ORANGE DR  
PHOENIX AZ 85018

MATTHEW B MCNEIL TRUST/RABBIT CREEK  
ORANGE LLC/ACV TWO LLC/TTF LLC ETAL  
3715 E ORANGE DR  
PHOENIX AZ 85018

MAX OUT HOLDINGS LLC  
4030 E COLTER ST  
PHOENIX AZ 85018

MAXSON CARL  
5066 N 38TH PL  
PHOENIX AZ 85018

MCCLAIN CONNOR PAGANI/TONN JESSICA  
ONEILL  
3715 E MEDLOCK DR  
PHOENIX AZ 85018

MCCLENDON CHARLES C III/BRIDGET B  
3825 E CAMELBACK RD UNIT 182  
PHOENIX AZ 85018

MCCREARY PHILLIP/BARBARA  
5509 N 40TH ST  
PHOENIX AZ 85018

MCINROY-BRADLEY TRUST  
5328 N 42ND PL  
PHOENIX AZ 85018

MCINTOSH DANIEL W  
3825 E CAMELBACK RD NO191  
PHOENIX AZ 85018

MDB TRUST  
3711 E PASADENA AVE  
PHOENIX AZ 85018

MEDICAL MONITORING SERVICES INC  
6627 E EXETER BLVD  
SCOTTSDALE AZ 85251

MEIDINGER DAWN/LERFALD CRAIG T  
3701 E ORANGE DR  
PHOENIX AZ 85018

MEINE KITCHEL FAMILY TRUST  
4049 E STANFORD DR  
PHOENIX AZ 85018

MERCER DANIEL J/CATHERINE C TR  
4020 E ST JOSEPH WY  
PHOENIX AZ 85018

MICHAUD PAUL J/ G E  
5416 N 42ND PL  
PHOENIX AZ 85018

MIRABELLI FAMILY TRUST  
3615 E ORANGE DR  
PHOENIX AZ 85018

MITTAL BHAIRAVI S/VIKAS  
5317 N 40TH ST  
PHOENIX AZ 85018

MJB TRUST  
3820 E PASADENA AVE  
PHOENIX AZ 85018

MOHAVE INVESTMENTS LLC  
8115 N MOHAVE RD  
PARADISE VALLEY AZ 85253

MOODY CHARLES R/BARBARA L  
5315 N 40TH ST  
PHOENIX AZ 85018

MOORE FAMILY LIVING TRUST  
5132 N 36TH ST  
PHOENIX AZ 85018

MORENO JORGE  
3601 E COLTER ST  
PHOENIX AZ 85018

MR CAT TRUST  
3839 136TH NE  
BELLEVUE WA 98005

MULLEN JONATHAN/RINGNESS ALLISON  
3613 E MEDLOCK DR  
PHOENIX AZ 85018

MULLEN REVOCABLE TRUST  
3627 E MEDLOCK  
PHOENIX AZ 85018

MULVIHILL FAMILY TRUST  
27371 CALLE DE LA ROSA  
SAN JUAN CAPISTRANO CA 92675

MURNEY FAMILY TRUST  
3625 E STANFORD DR  
PARADISE VALLEY AZ 85253

MUSTANG STAMPEDE ONE LLC  
3471 E CHICKADEE RD  
GILBERT AZ 85297

NANCY J RICHARDS LIVING TRUST  
3601 E ORANGE DR  
PHOENIX AZ 85018

NANCY KINNEY TRUST  
5507 N PALO CRISTI RD  
PARADISE VALLEY AZ 85253

NANCY L CRASE SURVIVORS TRUST  
5250 N 37TH PL  
PARADISE VALLEY AZ 85253

NEESE JOHN W  
2330 UNDERWOOD ST  
HOUSTON TX 77030

NELSON TAYLOR JONES  
4032 E MONTEBELLO AVE  
PHOENIX AZ 85018

NEUPERT PETER M/GLEASON HEATHER  
5550 N CAMINO DEL CONTENTO  
PARADISE VALLEY AZ 85253

NIMTZ CHRISTOPHER/FARELLA  
MICHELLE/JERRY  
3825 E CAMELBACK RD UNIT 287  
PHOENIX AZ 85018

NORRIS FAMILY TRUST  
3740 E MEDLOCK DR  
PHOENIX AZ 85018

NORTH 5080 LLC  
5080 N 40TH ST 420  
PHOENIX AZ 85018

NORTH BANK REALTY LP  
2801 E CAMELBACK RD STE 450  
PHOENIX AZ 85016

NOSTRANT FAMILY TRUST  
3901 E SAN MIGUEL AVE  
PARADISE VALLEY AZ 85253

NUCCI LAURE E  
195 LOVE LN  
RYE NH 3870

OCONOR FAMILY TRUST  
3610 E COLTER ST  
PHOENIX AZ 85018

ORANGE ROSE LIVING TRUST  
3702 E ORANGE DR  
PHOENIX AZ 85018

OSTROVSKY-LASHNITS REVOCABLE TRUST  
5077 N 38TH PL  
PHOENIX AZ 85018

OTONDO CATHERINE M  
5125 N 41ST PL  
PHOENIX AZ 85018

PADDEN FAMILY TRUST  
3801 E SAN MIGUEL AVE  
PARADISE VALLEY AZ 85253

PAGE 2 TRUST  
21731 VENTURA BLVD 300  
WOODLAND HILLS CA 91364

PALUCH WILLIAM L/PARK SOO YOUN  
5532 N 40TH ST  
PHOENIX AZ 85253

PEGASUS PROPERTY TRUST  
4034 E SAN MIGUEL AVE  
PHOENIX AZ 85018

PEREZ-HESANO CRISTINA  
7508 N 59TH AVE  
GLENDALE AZ 85301

PETERSEN FAMILY TRUST  
1811 N TATUM BLVD STE 1062  
PHOENIX AZ 85028

PETTIT LAIRD B/CARYL J TR  
4119 SAN MIGUEL  
PHOENIX AZ 85018

PETTIT YEVGENIYA  
3825 E CAMELBACK NO 290 RD  
PHOENIX AZ 85018

PFANNENSTIEL REVOCABLE TRUST  
3728 E MEDLOCK DR  
PHOENIX AZ 85018

PFUNDHELLER GEORGE P/STARR SUZANNE  
M  
4176 E ST JOSEPH WAY  
PHOENIX AZ 85018

PHILIP KEVIN/FRANCESA  
5112 N 41ST ST  
PHOENIX AZ 85018

PHOENIX COUNTRY DAY SCHOOL  
3901 E STANFORD DR  
PARADISE VALLEY AZ 85253

PHOENIX VACATION STAYS LLC  
1429 CANDELERO DR  
WALNUT CREEK CA 94598

POHL HAFHEY TRUST  
3701 E CAMELBACK RD  
PHOENIX AZ 85018

PONCZAK CHRIS ALLAN  
5501 N 40TH ST  
PHOENIX AZ 85018

POSTA CHRISTIAN ELIZARDI/JACLYN MARY  
3739 E MEDLOCK DR  
PHOENIX AZ 850181507

PREMIER REAL ESTATE FUNDING LLC  
10645 N TATUM BLVD STE C200 PMB 305  
PHOENIX AZ 85028

PROZZILLO POULET FAMILY TRUST  
3557 E OREGON AVE  
PHOENIX AZ 85018

PV PROPERTY LLC  
8111 LYNDON B JOHNSON FWY 1065  
DALLAS TX 75251

QOSHLLI ILIA/SILVANA  
3631 E PASADENA AVE  
PHOENIX AZ 85018

QUINIF GEORGE R/KAREN K  
4005 E SAN JUAN AVE  
PHOENIX AZ 85018

RABBIT CREEK ORANGE LLC  
5000 E ARABIAN WAY  
PARADISE VALLEY AZ 85253

RAL HOME B LLC  
4713 E CHOLLA ST  
PHOENIX AZ 85028

RANKINE GRAEME W/AMPHLETT VALERIE A  
5401 N 41ST PL  
PHOENIX AZ 85018

RAPP KAREN  
3629 E COLTER ST  
PHOENIX AZ 85018

RASKIN DONALD/SHARON TR  
3804 E CAMELBACK RD  
PHOENIX AZ 85018

RAUCH LIVING TRUST  
3639 E STANFORD DR  
PARADISE VALLEY AZ 85253

REDDYMASU SAVIO C/BELLAMKONDA  
PALLAVI  
5311 N PALO CRISTI RD  
PARADISE VALLEY AZ 85253

REEVE NICHOLAS/JULIE M  
4110 E SAINT JOSEPH WY  
PHOENIX AZ 85018

REIGHARD-WALKER LIVING TRUST  
3727 E CAMELBACK RD  
PHOENIX AZ 85018

REVOCABLE LIVING TRUST AGREEMENT OF  
LIGE M KAPLAN  
5315 N 41ST PL  
PHOENIX AZ 85018

REX AND KAREN WILLIAMSON FAMILY TRUST  
3501 E NITA RD  
PARADISE VALLEY AZ 85253

REYNOLDS KENNETH S/SHAWNA R  
4145 E COLTER ST  
PHOENIX AZ 85018

RICH FAMILY TRUST  
3640 E OLD ADOBE LN  
PARADISE VALLEY AZ 85253

RICHARD AND SUSAN KARBER FAMILY TRUST  
5242 N 37TH PL  
PARADISE VALLEY AZ 85253

RITTGERS MARK A  
17720 E BROOK FARM RD  
GILBERT AZ 85298

ROBERT E SMITH QUALIFIED PERSONAL  
RESIDENCE TRUST  
3633 E OLD ADOBE LN  
PARADISE VALLEY AZ 85253

ROBERT L MEEKS JR LIVING TRUST  
5647 N ROYAL CIR  
PARADISE VALLEY AZ 85253

ROBINSON FAMILY TRUST  
4001 E MONTEBELLO  
PHOENIX AZ 85018

ROESSLER DAVID M/SUSAN E  
3716 E MEDLOCK DR  
PHOENIX AZ 850181507

ROGERS JAMES E/CAROL A TR  
5134 N 41ST PL  
PHOENIX AZ 85018

ROLWING REBECCA  
774 E 18TH AVE  
SALT LAKE CITY UT 84103

ROMERIL FAMILY TRUST  
238 MCKENZIE LAKE BAY SE  
CALGARY AB 0

RONALD AND ROBYN SWARTZBAUGH  
REVOCABLE TRUST  
3734 E CAMELBACK RD  
PHOENIX AZ 85018

ROSA STEPHEN A SR/KAREN L  
4409 N 66TH ST  
SCOTTSDALE AZ 85251

ROSTAN FRANK R/SUZANNE R  
3921 E SAN MIGUEL AVE  
SCOTTSDALE AZ 85253

ROWLEY JASON CHARLES/KRISTIN RENEE  
5404 N 41ST ST  
PHOENIX AZ 85018

ROYCE ONEALE TRUST  
5419 N 41ST PL  
PHOENIX AZ 85018

RYAN PATTY J TR  
5415 N 40TH ST  
PHOENIX AZ 85018

RYANNE MICHELLE TEZANOS REVOCABLE  
TRUST  
3600 E DENTON LN  
PARADISE VALLEY AZ 85253

SALTER FAMILY TRUST  
3104 E CAMELBACK RD STE 854  
PHOENIX AZ 85016

SANDERS MATTHEW T/BETH W  
4108 E STANFORD DR  
PHOENIX AZ 85018

SANDOVAL JOSE A AMEZCUA/REBOLLEDO  
MARIANA G FLORES  
4010 E SAN MIGUEL AVE  
PHOENIX AZ 85018

SAUTER JOSH/STACY  
5009 N 38TH PL  
PHOENIX AZ 85018

SCARPINATO DANIEL/GRESS MATT  
4101 E MEDLOCK DR  
PHOENIX AZ 85018

SCHULZ KIMBERLY J  
1126 E NORTHVIEW AVE  
PHOENIX AZ 85020

SCHWARTZ JEFFREY P/WHELAN DOROTHY P  
3648 E DENTON LN  
PARADISE VALLEY AZ 85253

SCHWARTZ MARK J/DEBORAH D TR  
5305 N 41ST PL  
PHOENIX AZ 85018

SCOTT LEMARR FAMILY TRUST  
5625 N PALO CRISTI RD  
PARADISE VALLEY AZ 85253

SECOLO TIMOTHY/LAUREL  
4139 E COLTER ST  
PHOENIX AZ 85016

SEIFERT MARK JOEL  
4037 E MONTEBELLO AVE  
PHOENIX AZ 85016

SHANAHAN FAMILY TRUST  
4011 E MONTEBELLO AVE  
PHOENIX AZ 85018

SIDMAN ERIC/LINDSEY  
5518 N MARION WAY  
PHOENIX AZ 85018

SIEGEL DAN/SUZANNE  
4117 E PASADENA AVE  
PHOENIX AZ 85018

SIMON MICHAEL/NATALIE  
5031 N 38TH PL  
PHOENIX AZ 85018

SIMONETTI MARIA  
3825 E CAMELBACK RD UNIT 188  
PHOENIX AZ 85018

SIPOLT MARCUS K TR  
3683 E STANFORD DR  
PARADISE VALLEY AZ 85253

SJ OCONNOR LIVING TRUST  
3636 E DENTON LN  
PARADISE VALLEY AZ 85253

SMITH CLAYTON A & CORINNE L TR  
3841 E SOLANO DR  
PARADISE VALLEY AZ 85253

SMITH JEFFREY D & ADELE  
4106 E ST JOSEPHS WAY  
PHOENIX AZ 85018

SOLANO 3801 LLC  
1436 E TOWN AND COUNTRY LN  
PHOENIX AZ 85014

SONI JATINDER K/SELENA KAY  
3638 E COLTER ST  
PHOENIX AZ 85018

SONKIN JOEL S  
4142 E STANFORD DR  
PHOENIX AZ 85018

SONORA SIGNATURE HOMES LLC  
2143 N CITRUS CIR  
MESA AZ 85213

SONORAN EQUITY PARTNER LLC  
5514 N MARION WAY  
PHOENIX AZ 85018

SORENSEN LIVING TRUST  
3827 E SOLANO DR  
PARADISE VALLEY AZ 85253

SPRINKSDALE LLC  
5801 E MARCONI AVE  
SCOTTSDALE AZ 85254

STABLEY GORDON  
5039 N 38TH PL  
PHOENIX AZ 85018

STANTON DREW/KRISTIN L  
5655 N CAMINO DEL CONTENTO  
PARADISE VALLEY AZ 85253

STAUFF SHELBY KIRK/JACQUELYN SUSAN  
5071 N 38TH PL  
PHOENIX AZ 85018

STECKELBERG ROSS M/GROSSHANS JENNA  
K  
3550 E OREGON AVE  
PHOENIX AZ 85018

STEVENS-OMALLEY REVOCABLE TRUST  
5060 N 25TH PL  
PARADISE VALLEY AZ 85016

STONE HAZEL A/ILIOI MIHAI  
3621 E PASADENA AVE  
PHOENIX AZ 85018

STORJOHANN LARRY/MONICA  
16006 S 11TH PL  
PHOENIX AZ 850488423

STRANGE FAMILY TRUST  
3737 E CAMELBACK RD  
PHOENIX AZ 85018

STULL CARL A/MEGAN E  
5112 N 36TH ST  
PHOENIX AZ 85018

SUCATO FAMILY TRUST/CHERYL A SUCATO  
SURVIVOR TRUST  
3901 E SOLANO DR  
PARADISE VALLEY AZ 85253

SURVIVORS TRUST  
3601 E STANFORD DR  
PARADISE VALLEY AZ 85253

SURVIVORS TRUST  
5065 N 38TH PL  
PHOENIX AZ 85018

SUSANNE NG TRUST AGREEMENT  
5510 N ST JOSEPH WAY  
PHOENIX AZ 85018

SWANCEY FAMILY TRUST  
5001 E MITCHELL DR  
PHOENIX AZ 85018

SWANIGAN NICOLE  
3825 E CAMELBACK RD UNIT 186  
PHOENIX AZ 85018

SWVP 5090 LLC  
12770 EL CAMINO REAL STE 200  
SAN DIEGO CA 92130

TAMMEN JOSHUA/DIEMER KELSEY  
3715 E ORANGE DR  
PHOENIX AZ 85018

TASS DARREN E  
4138 E MEDLOCK DR  
PHOENIX AZ 85018

TASS NATALIE P  
3825 E CAMELBACK RD UNIT 203  
PHOENIX AZ 850182641

TAY FAMILY TRUST  
4049 E SOLANO DR  
PHOENIX AZ 85018

TAYLOR MCCAIN TRUST  
4118 E PASADENA AVE  
PHOENIX AZ 85018

TELLIER FAMILY TRUST  
5645 N DELOS CIR  
PARADISE VALLEY AZ 85253

TERRA DESERT LLC  
PO BOX 181667  
CORONADO CA 92178

TERRANCE L AND PATRICIA A SMITH LIVING  
TRUST  
5320 N 41ST ST  
PHOENIX AZ 85018

THOMPSON CONNIE  
10831 N 9TH PL  
PHOENIX AZ 85020

TIGUE REVOCABLE TRUST  
4833 N 38TH ST  
PHOENIX AZ 85018

TITZCK FAMILY TRUST  
5525 N CAMINO DEL CONTENTO  
PARADISE VALLEY AZ 85253

TRUJILLO RICHARD J  
4046 E CUDIA WAY  
PHOENIX AZ 85018

TWO TWENTY TWO FAMILY TRUST  
4019 E SAN MIGUEL AVE  
PHOENIX AZ 85018

U HAUL CO OF ARIZONA  
PO BOX 29046  
PHOENIX AZ 0

U HAUL REAL ESTATE COMPANY  
PO BOX 29046  
PHOENIX AZ 850389046

USA BUREAU OF RECLAMATION  
PO BOX 52025  
PHOENIX AZ 85072

VACT HOUSES LLC  
4408 N 12TH ST STE 200  
PHOENIX AZ 85014

VAN DER LINDEN LEXI  
3825 E CAMELBACK RD UNIT 207  
PHOENIX AZ 85018

VAUGHN DAMIAN/DIALBERT NICOLE  
4128 E MEDLOCK DR  
PHOENIX AZ 85018

VIDALES JARED/CROWELL DANIELLE  
5324 N 37TH PL  
PARADISE VALLEY AZ 85253

VINAY MOHAN KWATRA AND JENNIFER  
REBECCA RUBIN REVOCABLE TRUST  
5120 N 41ST ST  
PHOENIX AZ 85018

VUCUREVICH ROBERT G/HEIDI TR  
3637 E COLTER ST  
PHOENIX AZ 85018

WALLACE SCHWARTZ TRUST  
3625 E DENTON LN  
PARADISE VALLEY AZ 85253

WALSH ROSE O TR  
5059 N 38TH PL  
PHOENIX AZ 85018

WALT AND BETTY CHAPKO LIVING TRUST  
4102 E STANFORD DR  
PHOENIX AZ 85018

WARD FAMILY REVOCABLE TRUST  
3615 E COLTER ST  
PHOENIX AZ 85018

WATKINS MICHAEL LAWRENCE  
5045 N 38TH PL  
PHOENIX AZ 85018

WC PARAGON PHOENIX SPE  
2301 ROSECRANS AVE STE 4130  
EL SEGUNDO CA 90245

WEINSHEL REVOCABLE TRUST  
5402 N 42ND PL  
PHOENIX AZ 85018

WESSE SARAH M/ETHAN C  
4164 E ST JOSEPH WAY  
PHOENIX AZ 85018

WESSEL SARAH M/ETHAN C  
4152 E ST JOSEPH WY  
PHOENIX AZ 85018

WESTERN AMERICAN INVESTMENTS LLC  
10619 N HAYDEN RD STE 100  
SCOTTSDALE AZ 85260

WILLIAM C PHILLIPS QUALIFIED  
PERSONAL/ETAL  
3622 E PASADENA AVE  
PHOENIX AZ 85018

WILLIAM H AND NANCY VOTTERO ANGER  
RELOC TRUST  
3622 E ORANGE DR  
PHOENIX AZ 85018

WILLIAMS KAREN J  
3807 E PASADENA AVE  
PHOENIX AZ 85018

WILLIAMS LESLIE C  
3637 E MEDLOCK DR  
PHOENIX AZ 85018

WILLIS MARY JO/CAMPBELL JUANITA  
3609 E COLTER  
PHOENIX AZ 85018

WINTERGALEN FAMILY TRUST  
2901 E ELM ST  
PHOENIX AZ 85016

WIST IAN M  
4030 E STANFORD DR  
PHOENIX AZ 85018

WONG-WU TRUST  
3726 E STANFORD DR  
PARADISE VALLEY AZ 85253

WRIGHT ALICE A TR  
4035 E SAN MIGUEL AVE  
PHOENIX AZ 85014

WUNCH MICHAEL T  
5230 N 42ND PL  
PHOENIX AZ 85018

YEE FAMILY TRUST  
PO BOX 10358  
PHOENIX AZ 85064

YOUNG DAVID/KAREN  
368 ASHFORD DR  
MOUNT WASHINGTON KY 40047

YUDELL ALAN TR  
3707 E STANFORD DR  
PARADISE VALLEY AZ 85253

ZRW REVOCABLE LIVING TRUST  
5111 N 41ST ST  
PHOENIX AZ 85018

George Burton  
Community Development Department  
6401 E. Lincoln Drive  
Paradise Valley, AZ 85253



Phoenix Country  
Day School

## ZONING HEARING

TOWN OF PARADISE VALLEY  
Planning Commission

6401 E. Lincoln Drive, Paradise Valley, AZ  
6:00 O'CLOCK 7th DAY OF APRIL, 2026

Notice is hereby given that the Town of Paradise Valley Planning Commission will hold a public hearing at 6:00 p.m. on Tuesday, APRIL 7, 2026, at Town Hall, 6401 East Lincoln Drive, Paradise Valley, AZ, 85253 for:

**PUBLIC MEETING:**  
Discussion and Possible Action on an application requesting an Intermediate Special Use Permit Amendment to the Phoenix Country Day School Special Use Permit to renovate and update the existing baseball field, construct a new Wellness Center building, and add two new digital information signs (one in north parking lot and one in the east parking lot). The property is located at 3901 E. Stanford Drive (Assessor's Parcel Numbers 170-09-001B and 170-09-001A).

If you have questions about this application, please call Senior Planner George Burton with the Planning Department at (480) 348-3525.  
PENALTY FOR DEFACTING POSTER PRIOR TO DATE OF HEARING  
CASE NO. SUP-25-06 POSTING DATE March 20, 2026





# Community Outreach Report

---



3901 East Stanford Drive | Paradise Valley, AZ 85253

Prepared By:

**ROSE LAW GROUP<sup>pc</sup>**  
**RICH • CARTER • FISHER**

Jennifer Hall, Sr Project Manager  
7144 E. Stetson Drive, #300  
Scottsdale, AZ 85251  
480-505-3938  
[jhall@roselawgroup.com](mailto:jhall@roselawgroup.com)

January 30, 2026

## **Project Proposal**

The Applicant, Phoenix Country Day School (PCDS), is proposing to amend the Special Use Permit to allow for a new wellness center, much needed upgrades to the existing baseball field, and installation of 2 campus informational signs located at both entrances to campus. The school campus is 40-acre property located at 3901 E. Stanford Drive in Paradise Valley (Maricopa County Assessor Parcel Numbers: 170-09-001B and 001A).

## **Community Outreach Plan**

The Applicant team hosted an open house meeting on **January 30, 2026**, to inform property owners within 1,000 ft of the site about the improvements and gather feedback. 220 Notification letters were mailed out to the immediate community inviting them to join us and learn more about the proposed improvements. Additionally, the Applicant will post the property with upcoming public hearing information as well as mailed out hearing notification letters to all property owners within 1500 ft of the school campus.

## **Notification Area Map**

Attached please find the notification area maps for both the 1000 ft and 1500 ft buffers. Both maps were obtained from the Maricopa County Assessor's office.

## **Contacted Parties**

The contact mailing lists consisting of the adjacent residential neighbors as well as property owners within 1000 and 1500 feet of the proposed site are both attached. Property ownership for both mailing lists was determined based on current records obtained from the Maricopa County Assessor's website.

## **Contact Dates and Methods**

220 Notification letters were mailed via First Class U.S. Mail postmarked January 17th to the property owners within 1000 ft mentioned above. This Notification letter invited property owners to join the Applicant's Team for an in-person Open House meeting on January 29, 2026 to learn about the improvements to the campus. A copy of the notification letter is attached.

Hearing Notification letters for the upcoming hearings will also be mailed via First Class U.S. Mail to the property owners within 1500 ft mentioned above.

### **Community Meetings**

A Neighborhood Meeting (open house format) was held on January 29, 2026 from 5:30PM – 6:30PM at the PCDS Welcome Center. The neighbors were invited to meet the Applicant team to learn about the proposed and much needed improvements planned for the campus. The addition of the new wellness center building will enhance the physical fitness of faculty and students as well as provide new locker rooms for athletic teams. A complete summary of the meeting is attached with this Report.

### **Site Posting**

The site will be posted with two small signs as required by the city with all the required information and upcoming public hearing meeting dates, times and locations. A copy of the affidavit of postings along with photos of the signs will be attached to the final report.

### **Ongoing Communication with Neighbors and Interested Parties**

The Applicant team has been in communication with the neighbors on 37<sup>th</sup> Place (just west of the campus). In fact, there were significant changes made to the overall SUP amendment in direct response to neighborhood input from 37<sup>th</sup> Place. Most all of the major issues have been resolved and the Applicant team will continue to engage with those neighbors as we move through the process.



# COMMUNITY DEVELOPMENT DEPARTMENT AFFIDAVIT OF MAILING NOTIFICATION

Town of Paradise Valley • 6401 East Lincoln Drive • Paradise Valley, Arizona 85253 • Phone: (480) 348-3693

STATE OF ARIZONA        )  
                                      ) ss:  
County of Maricopa        )

In accordance with the requirements of the Town of Paradise Valley, the undersigned hereby certifies that all the property owners within 1,000 feet of the property, as obtained from the Maricopa County Assessor's Office on 1/13/2026, for the proposed application at 3901 E Stanford Dr has been mailed on the following date January 17, 2026. (Case Number)

(This property list shall not be older than thirty (30) days at the time of filing of the application).

Kayla Amado  
Kayla Amado

The foregoing instrument was acknowledged by me this 17<sup>th</sup> day of January, 2026, by Kayla Amado.  
Name

Laury A Henderson  
NOTARY PUBLIC

My commission expires:  
02/26/2029



# ROSE LAW GROUP<sup>pc</sup>

---

## RICH ■ CARTER ■ FISHER

JENNIFER HALL  
7144 E. Stetson Drive, Suite 300  
Scottsdale, AZ 85251  
Phone 480.505.3938 Fax 480.505.3925  
JHall@RoseLawGroup.com  
www.RoseLawGroup.com

January 14, 2026

Dear Property Owner:

This letter is to inform you that an application has been submitted to the Town of Paradise Valley requesting an amendment to the Special Use Permit for the Phoenix Country Day School (PCDS) located at 3901 E. Stanford Drive, which would allow the addition of a new Wellness Center, improvements to the existing baseball field, and 2 informational campus signs.

Phoenix Country Day School, founded in 1961, enrolls students for pre-K through grade 12 on their roughly 40-acre campus. PCDS prepares promising students to become responsible leaders and lifelong learners through an education that emphasizes intellectual engagement, independence, collaboration, creativity, and integrity. The existing baseball field has served the school well for decades; however, in keeping with its mission and in order to continue providing an exceptional well rounded educational experience and athletic program this application is requesting a new Wellness Center adjacent to an updated baseball field. Additionally, this request is asking to replace existing poles used for informational banners with 2 new electronic signs. These signs are strategically located on campus to provide parents with important school information during drop off and pick up.

Please see attached Site Plan showing the locations of the proposed improvements. We do not anticipate any impacts to the surrounding community as a result of these updates to the PCDS campus. The Wellness Center will provide work out facility along with locker rooms for faculty and student athletes. Baseball field updates will consist of new spectator seating, backstop, new dug outs, and turf – there is no field lighting associated with this request. Finally, the new informational signs will display school activities to keep the PCDS community informed on upcoming events.

An Open House Meeting will be held to address any questions that anyone may have regarding this application. There will be no formal presentation so please stop by at your convenience to meet with our team. If you cannot make the time/date below please just reach out to me directly and I am happy to meet and discuss this request.

**Thursday, January 29, 2026**

**5:30PM -6:30PM**

**Phoenix Country Day School, Shepard Welcome Center  
3901 E. Stanford Drive, Paradise Valley, AZ**

Representative contact info:  
Jennifer Hall  
480.505.3938  
jhall@roselawgroup.com

City staff contact info:  
George Burton  
480.348.3525  
gburton@paradisevalleyaz.gov

Sincerely,

*Jennifer Hall*

# PROPOSED CAMPUS IMPROVEMENTS

## PCDS - SUP Amendment

(SUP-25-06)

- New Dugouts
- New Bullpens
- New Backstop
- Refreshed Scoreboard
- Infield Dirt replaced
- Artificial turf
- Foul poles added
- Bleachers replaced with Shaded seats (same capacity)
- Paving fire service road



# Wellness Center - Southwest View (existing baseball field on west)



# Campus Informational Signs



Aquatic Center Entrance



Main Entrance



Updated Spectator Seating; replacing shade canopies



Scoreboard Refresh to match existing Softball field board

SKSO LLC  
5060 N 25TH PL  
PHOENIX AZ 85016

BELOW SCOTTSDALE LIVING TRUST  
PO BOX 44240  
PHOENIX AZ 85064

TITZCK FAMILY TRUST  
5525 N CAMINO DEL CONTEN TO  
PARADISE VALLEY AZ 85253

WONG-WU TRUST  
3726 E STANFORD DR  
PARADISE VALLEY AZ 85253

PAGE 2 TRUST  
21731 VENTURA BLVD 300  
WOODLAND HILLS CA 91364

MR CAT TRUST  
3839 136TH NE  
BELLEVUE WA 98005

NEESE JOHN W  
2330 UNDERWOOD ST  
HOUSTON TX 77030

KROEGER LIVING TRUST  
5535 N CAMINO DEL CONTEN TO  
PARADISE VALLEY AZ 852537505

GEORGE R HARRIS REVOCABLE LIVING  
TRUST  
PO BOX 864  
WILSON WY 83014

NEUPERT PETER M/GLEASON HEATHER  
5550 N CAMINO DEL CONTEN TO  
PARADISE VALLEY AZ 85253

3900 E STANFORD LLC  
3900 E STANFORD DR  
PARADISE VALLEY AZ 85253

PAJARO OCTAVIO E/VANDESTADT  
CATHERINE DOMINIQ  
5632 N 40TH ST  
PARADISE VALLEY AZ 85253

COHEN FAMILY L L C  
8 BILTMORE EST UNIT 215  
PHOENIX AZ 85016

GIBBS WILLIAM H  
3902 E SOLANO DR  
PARADISE VALLEY AZ 85253

KIRBY LOUIS C II/COLOMBO CAROL A  
5633 N ROYAL CIR  
PARADISE VALLEY AZ 85253

MARK S COLLINS TRUST  
5632 N ROYAL CIR  
PARADISE VALLEY AZ 85253

BOYD JAMES P/ELIZABETH TR  
5602 N ROYAL CIR  
PARADISE VALLEY AZ 85253

KEVIN DAY AND REBECCA L DAY TRUST  
5601 N DELOS CIR  
PARADISE VALLEY AZ 85253

LOFTIN JAMES A/HEIDI A TR  
5631 N DELOS CIR  
PARADISE VALLEY AZ 85253

EIFLER FAMILY TRUST  
5630 N DELOS CIR  
PARADISE VALLEY AZ 85253

GEORGELOS PAMELA G/DEMETRA V  
3802 E SOLANO DR  
PARADISE VALLEY AZ 85253

SHERMAN JEFFREY NEIL  
1436 E TOWN AND COUNTRY LN  
PHOENIX AZ 85014

HOSMAR MICHAEL D/MICHELLE M  
3805 E SOLANO DR  
PARADISE VALLEY AZ 85253

AMY MENOUSEK REVOCABLE TRUST  
3811 E SOLANO DR  
PARADISE VALLEY AZ 85253

SORENSEN LIVING TRUST  
3827 E SOLANO DR  
PARADISE VALLEY AZ 85253

SMITH CLAYTON A & CORINNE L TR  
3841 E SOLANO DR  
PARADISE VALLEY AZ 85253

SUCATO FAMILY TRUST/CHERYL A  
SUCATO SURVIVOR TRUST  
3901 E SOLANO DR  
PARADISE VALLEY AZ 85253

DAVIES FAMILY TRUST  
3921 E SOLANO DR  
PARADISE VALLEY AZ 85253

PALUCH WILLIAM L/PARK SOO YOUN  
5532 N 40TH ST  
PHOENIX AZ 85253

DADAM JOHN JR/BARBARA TR  
5520 N 40TH ST  
PARADISE VALLEY AZ 85253

FLOOD CONTROL DISTRICT OF  
MARICOPA COUNTY  
2801 W DURANGO ST  
PHOENIX AZ 85009

PHOENIX COUNTRY DAY SCHOOL  
3901 E STANFORD DR  
PARADISE VALLEY AZ 85253

HACKETT ROBERT C/SHERRIE A TR  
3616 E DENTON LN  
PARADISE VALLEY AZ 85253

SJ OCONNOR LIVING TRUST  
3636 E DENTON LN  
PARADISE VALLEY AZ 85253

BAUMAN JILL  
3648 E DENTON LN  
PARADISE VALLEY AZ 85253

BRILL LIVING TRUST  
3639 E DENTON LN  
PARADISE VALLEY AZ 85253

WALLACE SCHWARTZ TRUST  
3625 E DENTON LN  
PARADISE VALLEY AZ 85253

YUDELL ALAN TR  
6711 E CAMELBACK RD 46  
SCOTTSDALE AZ 85251

RICHARD AND SUSAN KARBER FAMILY  
TRUST  
5242 N 37TH PL  
PARADISE VALLEY AZ 85253

JOSEPH PETERCHAK TRUST/JEANNE M  
PICERNE TRUST  
304 S LINCOLN ST  
HINDSDALE IL 60521

JAMES JOSEPH AND CHIRL ANN  
SIENICKI REV TRUST  
5213 N 36TH ST  
PHOENIX AZ 85018

MURNEY FAMILY TRUST  
3625 E STANFORD DR  
PARADISE VALLEY AZ 85253

KANI TRUST  
3662 E DENTON LN  
PARADISE VALLEY AZ 85253

ROMERIL FAMILY TRUST  
238 MCKENZIE LAKE BAY SE  
CALGARY AB T2Z2H2

LAU SUE-MENG  
3653 E STANFORD DR  
PARADISE VALLEY AZ 85253

SIPOLT MARCUS K TR  
3683 E STANFORD DR  
PARADISE VALLEY AZ 85253

RAUCH JONATHAN C/CAROLYN S  
3639 E STANFORD DR  
SCOTTSDALE AZ 85253

EAGLE POINTE TRUST  
935 GRAVIER ST 1702  
NEW ORLEANS LA 70112

DEMPSEY PATRICIA G TR  
3623 E COLTER ST  
PHOENIX AZ 85018

RAPP KAREN  
3629 E COLTER ST  
PHOENIX AZ 85018

VUCUREVICH ROBERT G/HEIDI TR  
3637 E COLTER ST  
PHOENIX AZ 85018

BRETT S DRUMMOND TRUST  
3643 E COLTER ST  
PHOENIX AZ 85018

EVN TRUST  
3653 E COLTER  
PHOENIX AZ 85018

SONI JATINDER K/SELENA KAY  
3638 E COLTER ST  
PHOENIX AZ 85018

BARBARA GOULD REVOCABLE LIVING  
TRUST  
3630 E COLTER ST  
PHOENIX AZ 85018

BURR RYAN/MADISON  
3624 E COLTER ST  
PHOENIX AZ 85018

ROLWING REBECCA  
5350 N 37TH PL  
PARADISE VALLEY AZ 85253

HILLER FAMILY TRUST  
5342 N 37TH PL  
PARADISE VALLEY AZ 85253

DECKER LE JEUNE  
5325 N 37TH PL  
PARADISE VALLEY AZ 85253

CAIN BRIAN M/ERIN P  
5311 N 37TH PL  
PARADISE VALLEY AZ 85253

FABRICANT LAURA M TR  
5301 N 37TH PL  
PARADISE VALLEY AZ 85253

CHAMI DIMITRI  
1919 E CLAREMONT ST  
PHOENIX AZ 85016

NANCY L CRASE SURVIVORS TRUST  
5250 N 37TH PL  
PARADISE VALLEY AZ 85253

CHAMI DIMITRI  
5310 N 37TH PL  
PARADISE VALLEY AZ 85253

VIDALES JARED/CROWELL DANIELLE  
5324 N 37TH PL  
PARADISE VALLEY AZ 85253

SYC REVOCABLE TRUST  
3711 E PASADENA AVE  
PHOENIX AZ 85018

JOHN DONNER & LORETTA JEAN JONES  
REV LIV TR  
3721 E PASADENA AVE  
PHOENIX AZ 85018

FARROKH FAMILY TRUST  
3727 E PASADENA AVE  
PHOENIX AZ 85018

FJCJ LIVING TRUST  
3741 E PASADENA AVE  
PHOENIX AZ 85018

CLARK FAMILY LIVING TRUST  
3740 E PASADENA AVE  
PHOENIX AZ 85018

HARRINGTON JAMES P/TAMYRA MAY  
3732 E PASADENA  
PHOENIX AZ 85018

PHOENIX 517 LLC  
5635 N SCOTTSDALE RD  
SCOTTSDALE AZ 85250

KUSMAN JADIN/MCCLAIN KATHLEEN  
3712 E PASADENA AVE  
PHOENIX AZ 85018

JOHN TYRRELL TABER REVOCABLE  
LIVING TRUST  
3702 E PASADENA AVE  
PHOENIX AZ 85018

WILLIAMS LESLIE C  
3637 E MEDLOCK DR  
PHOENIX AZ 85018

BRAMLET FAMILY LIVING TRUST  
3701 E MEDLOCK DR  
PHOENIX AZ 85018

MCCLAIN CONNOR PAGANI/TONN  
JESSICA ONEILL  
3715 E MEDLOCK DR  
PHOENIX AZ 85018

DHILLON SIMI/ANTTAL MANDEEP  
3737 E MEDLOCK DR  
PHOENIX AZ 85018

POSTA CHRISTIAN ELIZARDI/JACLYN  
MARY  
3739 E MEDLOCK DR  
PHOENIX AZ 850181507

NORRIS FAMILY TRUST  
3740 E MEDLOCK DR  
PHOENIX AZ 85018

PFANNENSTIEL REVOCABLE TRUST  
3728 E MEDLOCK DR  
PHOENIX AZ 85018

ROESSLER DAVID M/SUSAN E  
3716 E MEDLOCK DR  
PHOENIX AZ 850181507

CAMUNEZ DINO R/BLEEKER-CAMUNEZ  
HEIDI C  
3702 E MEDLOCK DR  
PHOENIX AZ 85018

BOAS RICHARD N MD & GERTRUDE M  
TR  
3640 E MEDLOCK DR  
PHOENIX AZ 85018

FREVOLA FAMILY TRUST  
3628 E MEDLOCK DR  
PHOENIX AZ 85018

MALONE MICHAEL J/ANN M  
3627 E ORANGE DR  
PHOENIX AZ 85018

MANSOUR NICK J III/ANNEMARIE J  
3639 E ORANGE DR  
PHOENIX AZ 85018

MEIDINGER DAWN/LERFALD CRAIG T  
3701 E ORANGE DR  
PHOENIX AZ 85018

ORANGE ROSE LIVING TRUST  
3702 E ORANGE DR  
PHOENIX AZ 85018

COLLINS WALTER V  
3650 E ORANGE DR  
PHOENIX AZ 85018

CANTOR STIRLEY N  
3638 E ORANGE DR  
PHOENIX AZ 85018

WILLIAM H AND NANCY VOTTERO  
ANGER REVOC TRUST  
3622 E ORANGE DR  
PHOENIX AZ 85018

BALDERRAMA ADRIAN  
4020 N 40TH PL  
PHOENIX AZ 85018

RABBIT CREEK ORANGE LLC  
5000 E ARABIAN WAY  
PARADISE VALLEY AZ 85253

MATTHEW B MCNEIL TRUST  
3730 E ORANGE DR  
PHOENIX AZ 85018

TAMMEN JOSHUA/DIEMER KELSEY  
3715 E ORANGE DR  
PHOENIX AZ 85018

MATTHEW B MCNEIL TRUST/RABBIT  
CREEK ORANGE LLC/ACV TWO LLC/TTF  
LLC ETAL  
3715 E ORANGE DR  
PHOENIX AZ 85018

U S A -BUREAU OF RECLAMATION-  
PO BOX 52025  
PHOENIX AZ 85072

CIO 5090 LIMITED PARTNERSHIP  
5090 N 40TH ST 165  
PHOENIX AZ 85018

NORTH BANK REALTY LP  
2801 E CAMELBACK RD STE 450  
PHOENIX AZ 85016

51ZERO8 LLC  
5202 S 40TH ST  
PHOENIX AZ 85040

DEVELOPMENT SERVICES OF AMERICA  
INC  
16100 N 71ST ST STE 520  
SCOTTSDALE AZ 85254

HARRISON DEVELOPMENT LLC  
5112 N 40TH ST STE 105  
PHOENIX AZ 85018

NORTH 5080 LLC  
5080 N 40TH ST 420  
PHOENIX AZ 85018

NORTH AMERICAN RESORT  
PROPERTIES INC  
4450 MACARTHUR BLVD  
NEWPORT BEACH CA 92660

M4 5050 LLC  
100 BAYVIEW CIR STE 4500  
NEWPORT BEACH CA 92660

5060 BUILDING LLC  
2400 E ARIZONA BILTMORE CIR STE  
1200  
PHOENIX AZ 85016

FUDENNA BROS INC  
PO BOX 1636  
FREMONT CA 94538

WC PARAGON PHOENIX SPE  
2301 ROSECRANS AVE STE 4130  
EL SEGUNDO CA 90245

WATKINS MICHAEL LAWRENCE  
5045 N 38TH PL  
PHOENIX AZ 85018

GRONINGER CHRISTINE L  
5053 N 38TH PL  
PHOENIX AZ 85018

WALSH ROSE O TR  
5059 N 38TH PL  
PHOENIX AZ 85018

SURVIVORS TRUST  
5065 N 38TH PL  
PHOENIX AZ 85018

ARCAN TRAIL LLC  
1414 SAN REMO DR  
PACIFIC PALISADES CA 90272

OSTROVSKY-LASHNITS REVOCABLE  
TRUST  
5077 N 38TH PL  
PHOENIX AZ 85018

HAYDON DAVID/JANENE D  
5072 N 38TH PL  
PHOENIX AZ 85018

MAXSON CARL  
5066 N 38TH PL  
PHOENIX AZ 85018

AZHAR NILI/URDANETA JOSE J  
5050 N 38TH PL  
f PHOENIX AZ 85018

BAILON MARIA JESUS  
3820 E PASADENA AVE  
PHOENIX AZ 85018

HUTCHISON REVOCABLE LIVING TRUST  
3814 E PASADENA AVE  
PHOENIX AZ 85018

ERIC AND JANA WOOD REVOCABLE  
TRUST  
3808 E PASADENA AVE  
PHOENIX AZ 85018

WILLIAMS KAREN J  
3807 E PASADENA AVE  
PHOENIX AZ 85018

MERICLE DAVID  
5018 N 38TH PL  
PHOENIX AZ 85018

DEVINE CARIBE  
3813 E PASADENA AVE  
PHOENIX AZ 85018

ROBERSON MICHAEL J/KATIE JO  
3819 E PASADENA AVE  
PHOENIX AZ 85018

HUNTER MICHAEL/DAWN  
5017 N 38TH PL  
PHOENIX AZ 85018

MOHAVE INVESTMENTS LLC  
8115 N MOHAVE RD  
PARADISE VALLEY AZ 85253

SIMON MICHAEL/NATALIE  
5031 N 38TH PL  
PHOENIX AZ 85018

CHARLES O SMITH AND MARGARET M  
SMITH TRUST  
5039 N 38TH PL  
PHOENIX AZ 85018

JOHNSON RYAN LON/ALLISON  
1249 E BRIARWOOD TER  
PHOENIX AZ 85048

ROGERS JAMES E/CAROL A TR  
5134 N 41ST PL  
PHOENIX AZ 85018

REYNOLDS KENNETH S/SHAWNA R  
4145 E COLTER ST  
PHOENIX AZ 85018

SECOLO TIMOTHY/LAUREL  
4139 E COLTER ST  
PHOENIX AZ 85016

MCNULTY CONOR/LILY  
4137 E COLTER ST  
PHOENIX AZ 85018

GAMMAGE AND YOUSSE LIVING TRUST  
4115 E COLTER ST  
PHOENIX AZ 85018

HAKAK AMIR  
3130 N 62ND ST AT  
SCOTTSDALE AZ 85251

MASRY HICHAM EL/MINA LIDA A  
4025 COLTER ST  
PHOENIX AZ 850181611

5141 BUILDING LLC  
5141 N 40TH ST 500  
PHOENIX AZ 85018

HART BRIAN WILLIAM/YU SOOJIE  
4020 E COLTER ST  
PHOENIX AZ 85018

MRW INVESTMENTS LLC  
4408 N 12TH ST STE 200  
PHOENIX AZ 85014

SAWALHA LEITH/FIDA  
5302 N 41ST ST  
PHOENIX AZ 85018

TERRANCE L AND PATRICIA A SMITH  
LIVING TRUST  
5320 N 41ST ST  
PHOENIX AZ 85018

EISENSTADT MATTHEW E/RACHAEL B  
9070 E GARY RD UNIT 120  
SCOTTSDALE AZ 85260

KIRK JASON M  
4035 E CUDIA WAY  
PHOENIX AZ 85018

HOBICA DANIEL/LORA  
4040 E CUDIA WAY  
PHOENIX AZ 85018

TRUJILLO RICHARD J  
4046 E CUDIA WAY  
PHOENIX AZ 85018

SHEA DAVID R/CHERYL M  
5404 N 41ST ST  
PHOENIX AZ 85018

LAINE KEAHEY TRUST  
5430 N 41ST ST  
PHOENIX AZ 85018

ANNE TAYLOR KUNKEL TRUST  
5425 N 41ST ST  
PHOENIX AZ 85018

CARTER JOHN PATRICK/ALISON  
PULASKI  
5401 N 41ST ST  
PHOENIX AZ 85018

CASA COCO TRUST  
5325 N 41ST ST  
PHOENIX AZ 85018

JACQUES RAOUL T  
5315 N 41ST ST  
PHOENIX AZ 85018

HENRY LINDA M/MARKOVITS MICHAEL  
JAY  
25 FOREST ST 17C  
STAMFORD CT 69011854

BELDEN FAMILY TRUST  
5240 N 41ST PL  
PHOENIX AZ 85018

MARSTON CHAD E  
5314 N 41ST PL  
PHOENIX AZ 85018

CHRISTEL BRAUM SURVIVOR'S TRUST  
4119 E STANFORD DR  
PHOENIX AZ 85018

CLARK JAMES P TR  
4105 E STANFORD DR  
PHOENIX AZ 85012

MEINE KITCHEL FAMILY TRUST  
4049 E STANFORD DR  
PHOENIX AZ 85018

MARTYNIUK RYSZARD D/CATHERINE F  
4035 E STANFORD DR  
PHOENIX AZ 85018

STORJOHANN LARRY/MONICA  
16006 S 11TH PL  
PHOENIX AZ 850488423

CONANT JERRY & GAIL A TR  
4001 E STANFORD DR  
PHOENIX AZ 85018

RYAN PATTY J TR  
5415 N 40TH ST  
PHOENIX AZ 85018

BENNETT JOSEPH J/SANDRA K TR  
5319 N 40TH ST  
PHOENIX AZ 85018

MITTAL BHAIRAVI S/VIKAS  
5317 N 40TH ST  
PHOENIX AZ 85018

MOODY CHARLES R/BARBARA L  
5315 N 40TH ST  
PHOENIX AZ 85018

HULSTON FAMILY TRUST  
5301 N 40TH ST  
PHOENIX AZ 85018

DITTER STEVEN J  
5225 N 40TH ST  
PHOENIX AZ 85018

GAMMAGE AND YOUSSE LIVING TRUST  
4415 E COLTER ST  
PHOENIX AZ 85018

HORNADAY JAMES Q  
5128 N 41ST ST  
PHOENIX AZ 85018

FORTRESS OF SOLITUDE REVOCABLE  
TRUST  
3219 E CAMELBACK RD STE 419  
PHOENIX AZ 85018

ARCADIA SURVIVORS TRUST/ACRCADIA  
DECEDENTS TRUST  
5119 N 41ST ST  
PHOENIX AZ 85018

VINAY MOHAN KWATRA AND JENNIFER  
REBECCA RUBIN REVOCABLE TRUST  
5120 N 41ST ST  
PHOENIX AZ 85018

BROWN RANDALL K/TWIGGY Y  
5112 N 41ST ST  
PHOENIX AZ 850181604

HILL FAMILY LIVING TRUST  
5111 N 41ST ST  
PHOENIX AZ 85018

BAKER MARIAN  
5102 N 41ST ST  
PHOENIX AZ 85018

ASSET MANAGEMENT SPECIALISTS LLC  
2633 E INDIAN SCHOOL RD STE 320  
PHOENIX AZ 85016

HUNDELT REVOCABLE TRUST  
7110 N 46TH ST  
PARADISE VALLEY AZ 85253

4040 EAST CAMELBACK ROAD LLC  
1505 S REDWOOD RD  
SALT LAKE CITY UT 84104

CAPRI CAMELBACK GARDENS  
LP/DG201 CAPRI CAMELBACK LLC/ETAL  
999 WATERSIDE DR STE 2300  
NORFOLK VA 23510

COHEN BABAK/SHARONA  
5504 N CALLE DEL SANTO  
PHOENIX AZ 85018

BICKERSTAFF JOSHUA/CARLY  
4108 E STANFORD DR  
PHOENIX AZ 85018

WALT AND BETTY CHAPKO LIVING  
TRUST  
4102 E STANFORD DR  
PHOENIX AZ 85018

JAYASEKERA CHANNA R  
7117 E RANCHO VISTA DR UNIT 1012  
SCOTTSDALE AZ 85251

WIST IAN M  
4030 E STANFORD DR  
PHOENIX AZ 85018

LORENZ BRIAN/MEGHAN  
4022 E STANFORD DR  
PHOENIX AZ 85018

CACTUS REUNION LLC  
14602 N TATUM BLVD  
PHOENIX AZ 85032

CASE VENTURES LLC  
10143 E CLINTON ST  
SCOTTSDALE AZ 85260

DELUCA LAWRENCE/ELIZABETH LEE  
4103 E SAINT JOSEPH WAY  
PHOENIX AZ 85018

EIFLER GEORGE TR  
4109 E ST JOSEPH WY  
PHOENIX AZ 85018

SMITH JEFFREY D & ADELE  
4106 E ST JOSEPHS WAY  
PHOENIX AZ 85018

CROWLEY TED J & KATHLEEN M  
4102 E ST JOSEPH WAY  
PHOENIX AZ 85018

NUCCI LAURE E  
195 LOVE LN  
RYE NH 3870

DRNJEVIC REVOCABLE TRUST  
4032 E ST JOSEPH WY  
PHOENIX AZ 85018

CAROLE FERRIS KROEGER 2021  
IRREVOCABLE TRUST  
4026 E SAINT JOSEPH WAY  
PHOENIX AZ 85018

MERCER DANIEL J/CATHERINE C TR  
4020 E ST JOSEPH WY  
PHOENIX AZ 85018

MARY L SHAW TRUST  
4014 E ST JOSEPH WAY  
PHOENIX AZ 85018

SUSANNE NG TRUST AGREEMENT  
5510 N SAINT JOSEPH WAY  
PHOENIX AZ 85018

FATTALEH ALICE  
PO BOX 15934  
PHOENIX AZ 850605934

PONCZAK CHRIS ALLAN  
5501 N 40TH ST  
PHOENIX AZ 85018

BANOVAC CHARLES ROBERT  
3104 E CAMELBACK RD UNIT 1001  
PHOENIX AZ 85016

HAZARD ANNE BARRETT/MATTHEW  
STEVENS  
4101 E SAN MIGUEL AVE  
PHOENIX AZ 85018

BALL ROBERT B & MELANIE L  
4039 E SAN MIGUEL  
PHOENIX AZ 85018

WRIGHT ALICE A TR  
4035 E SAN MIGUEL AVE  
PHOENIX AZ 85014

LEPINSKAS KENNETH MICHAEL/NEAL  
DANIELLE  
4031 E SAN MIGUEL AVE  
PHOENIX AZ 85018

ANDERSON HELEN ANNE  
4027 E SAN MIGUEL AVE  
PHOENIX AZ 85018

TWO TWENTY TWO FAMILY TRUST  
4019 E SAN MIGUEL AVE  
PHOENIX AZ 85018

WINTERGALEN FAMILY TRUST  
2901 E ELM ST  
PHOENIX AZ 85016

FISCHER ARON/STACY  
4002 E SAN JUAN AVE  
PHOENIX AZ 85018

BARRETT REBEKAH S/BLOMGREN  
PETER A  
1118 NE LAUREL CT  
ISSAQUAH WA 98029

CONELLY CHAD H  
4011 E SAN JUAN AVE  
PHOENIX AZ 85018

PEREZ-HESANO CRISTINA  
7508 N 59TH AVE  
GLENDALE AZ 85301

REALPARTNERS LLC  
4010 E SAN MIGUEL AVE  
PHOENIX AZ 85018

ERIC AND KERRI NELSON TRUST  
4016 E SAN MIGUEL AVE  
PHOENIX AZ 85018

ADC LIVING TRUST  
4024 E SAN MIGUEL AVE  
PHOENIX AZ 85018

GIFFORD BRAD ANDREW/CAMILLE  
4034 E SAN MIGUEL AVE  
PHOENIX AZ 85018

HABERMAN DONALD C/LIDIA W TR  
4042 E SAN MIGUEL AVE  
PHOENIX AZ 85018

ROBINSON FAMILY TRUST THE  
4001 E MONTEBELLO  
PHOENIX AZ 85018

QUINIF GEORGE R/KAREN K  
4005 E SAN JUAN AVE  
PHOENIX AZ 85018

George Burton  
Senior Planner  
Community Development Department  
6401 E. Lincoln Drive  
Paradise Valley, AZ 85253

Christine Mackay  
Phoenix Community and Economic  
Development Director  
200 W. Washington St., 20th Floor,  
Phoenix, AZ 85004

Community and Economic  
Development Department  
3939 N. Drinkwater Blvd.  
Scottsdale, AZ 85251

**PHOENIX COUNTRY DAY SCHOOL**  
**SUP Amendment (Wellness Center, Field Updates, Campus Info Signs)**  
**Open House Meeting Summary**

**Date:** January 29, 2026  
**Time:** 5:30- 6:30 p.m.  
**Location:** PCDS – Welcome Center  
3901 Stanford Drive

**Applicant Team:**

Tom Galvin - Zoning Attorney, Rose Law Group  
Alex Hosmar - Zoning Attorney, Rose Law Group  
Jennifer Hall - Sr. Project Manager, Rose Law Group  
Tim Mitten – Director of Operations, PCDS  
Michael Wechsler – Construction Contractor, Foursite

Applicant Team arrived at the meeting location at 5:00PM to set up the room with exhibit boards, sign in sheets and comment cards. Out of 220 nearby property owners invited to the Open House meeting, only 2 neighbors attended at different times. Please see attached sign in sheet.

The Applicant team had been in communication with both neighbors and in fact, met with one of the neighbors prior at her home earlier in the day. Please see summary of the discussion with each neighbor below.

Dimitri Chami – owns 2 homes on 37<sup>th</sup> Place; the home that backs to PCDS was rebuilt and is currently for sale. Main concern expressed was height of the new wellness center and why it needed to be 20ft tall. The team discussed the height is lower than all of the surrounding buildings and will not impact any views of Praying Monk. Towards the end of the meeting Dimitri commented that he is fine with it but some of his neighbors may not be.

Kristina Decker Efimenko – Lives with her 105 year old mother and actually attended PCDS as a young child. She expressed to the Team that she has no issues with the current SUP amendments; however, she has some issues with the previously approved Music Building being too bright at nighttime. Also, she would like for the refuse enclosure walls to be painted a dark color and not beige. The Applicant team said they will reach out to Town to get approval on the dark color paint for the screen wall and they would look into the lighting issue on the Music Building.

Both attendees left by 6:00PM and the Applicant Team stayed until 6:30PM which was the scheduled end time. There were no other attendees.

After the meeting the Applicant Team walked over to the back of the Music Building which is still under construction and realized that There were 3 bright security lights pointed at the building. Tim Mitten said he would reposition the lights to eliminate the illumination of the building in hopes to solve Kristina’s lighting issue. Jennifer Hall from RLG stopped by Kristina’s home to inform her that the lighting problem may be solved and would follow up in the next few days to confirm.

Phoenix Country Day School - 3901 E Stanford Dr. | Open House Meeting Sign-in Sheet  
 PCDS - Shepard Welcome Center | Thursday, January 29, 2026 from 5:30PM - 6:30PM | SUP Amendment

Name	Address	Email	Phone	Y/N to receive project updates
Dimitriou	5310 N. 37th Pl		810.779.7574	
Kristina Efimenko	5325 N. 37th Pl,	JasminHme2015@gmail.com	602-721-9172	Y