

address | elevation | scale: 1/2" = 1'-0"

TOTAL SQ FT = 24.7

-16" Tall , Halo Illuminated RPC numerals painted to match MAP Brushed Aluminum. Numerals are mounted on a 2 1/2"x 5" rectangular tubing paint color TBD.

- Methodist cross is a 3" thick Halo Illuminated RPC, mounted 1 1/2" off the wall.



address | elevation | scale: 3/16" = 1'-0"

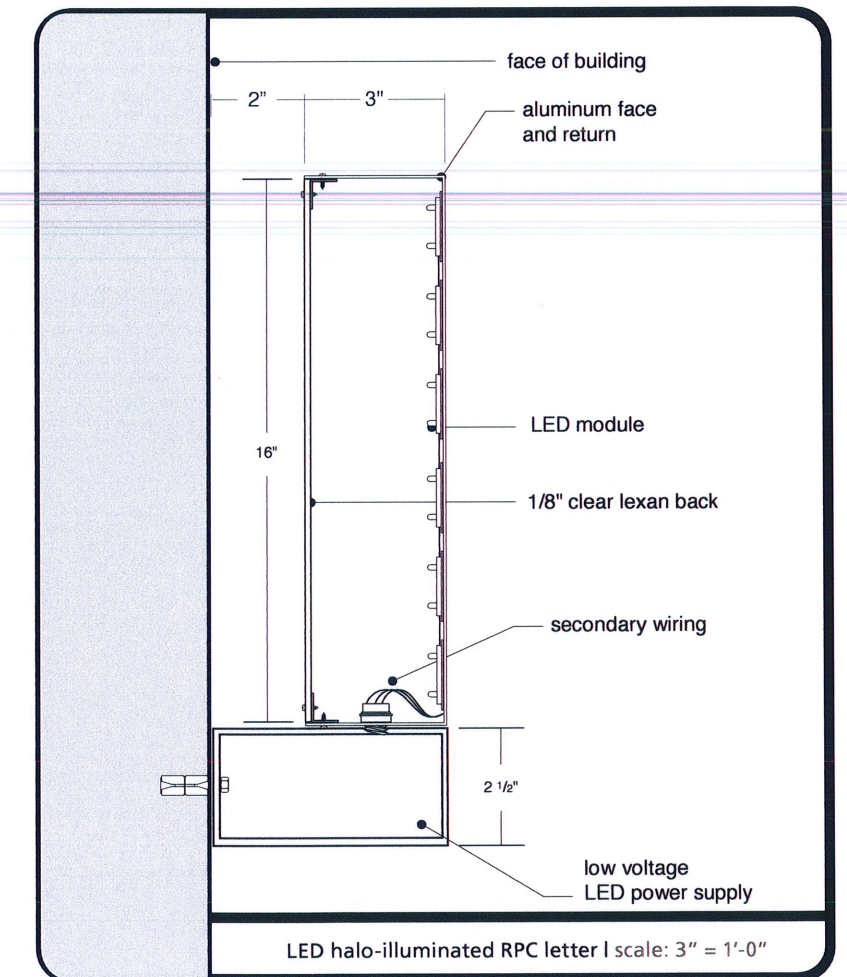

LED halo-illuminated RPC letter | scale: 3" = 1'-0"

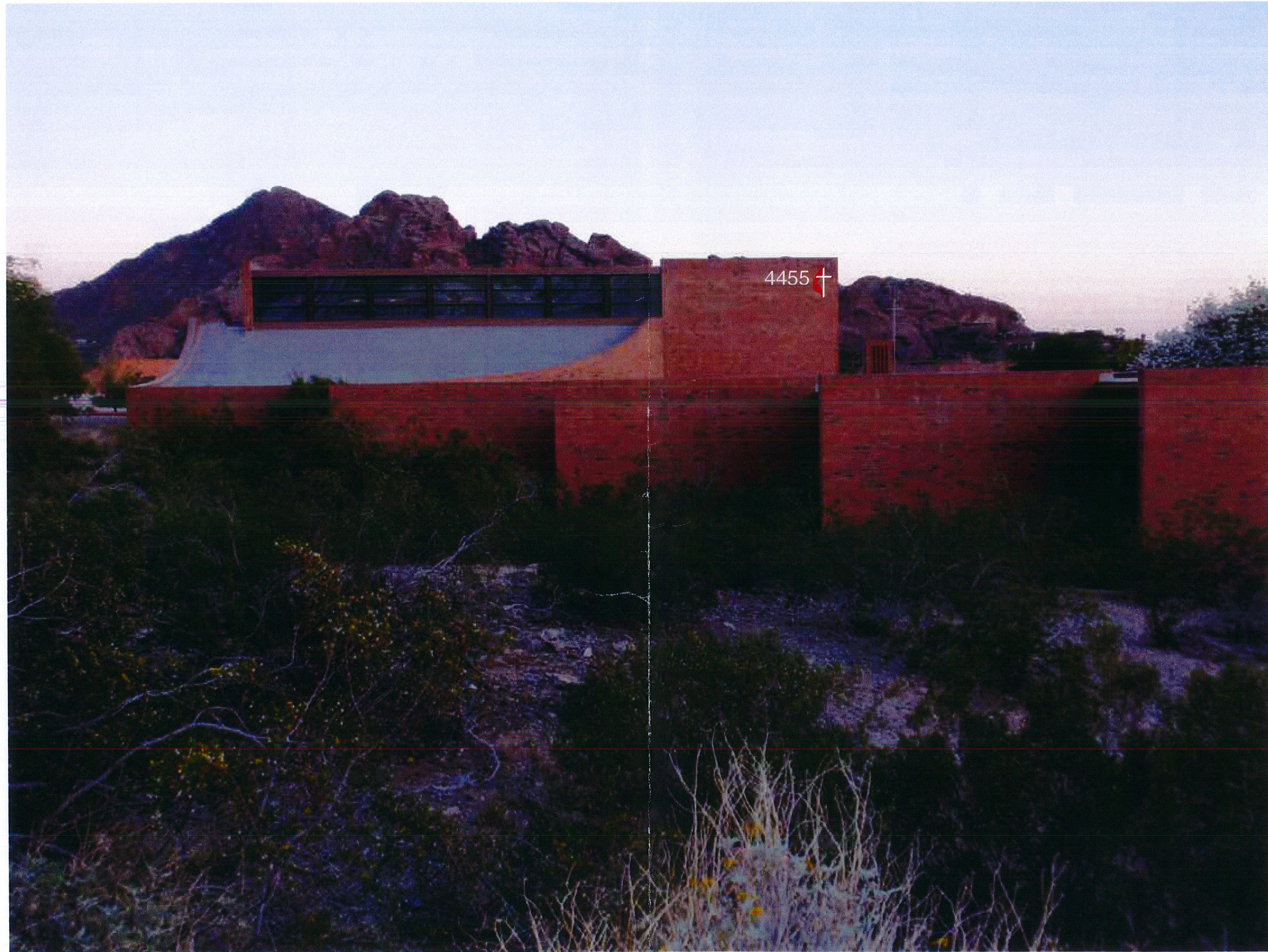

address | elevation | scale: 1/16" = 1'-0"

**SmithCraft**  
CUSTOM SIGNS & GRAPHICS

3643 South 7th Street  
Phoenix, AZ 85040.1130  
602.268.1349 Office  
602.268.1369 Facsimile

Fabrication information shown here is the exclusive property of F & N Enterprises dba SmithCraft and may not be used for fabrication by any other company without authorization from an officer of F & N.

REP: S. Spradlin  
BY: S. Hensley  
DATE: 01/07/15  
REV: 00/00/00

SPEC NO.  
**SS-12052**  
JOB NO.  
**16-020201**

**PV- UNITED METHODIST CHURCH**  
Address Number

Install Address: 4455 E. Lincoln Dr. Paradise Valley AZ, 85253

SIGN TYPE  
HALO ILLUMINATED  
PAN CHANNEL

SHEET  
**2.0**