

AFFIDAVIT OF MAILING NOTIFICATION

STATE OF ARIZONA)

) ss:

County of Maricopa)

In accordance with the requirements of the Town of Paradise Valley, the undersigned hereby certifies that the mailing list for the proposed project is a complete list of property owners within 500 feet of the subject property, as obtained from the Maricopa County Assessor's Office on the following date FEB 6, 2017, and such notification has been mailed on the following date FEB 21, 2017.

[Handwritten Signature]
Signature

The foregoing instrument was acknowledged by me this 21st day of February, 2017, by JoAnne E. Cohen.
Name

[Handwritten Signature]
NOTARY PUBLIC

My commission expires:
April 19, 2020

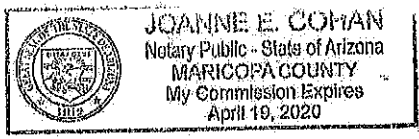



Paul Michaud, AICP
Senior Planner
Town of Paradise Valley
6401 E. Lincoln Drive
Paradise Valley, AZ 85253
(480) 348-3574

Dear Resident:

Notice is hereby given that the Town of Paradise Valley Planning Commission will hold a **public meeting at 6:00 p.m., on Tuesday, March 7, 2017**, at Town Hall, 6401 East Lincoln Drive, Paradise Valley, Arizona, 85253 for the following application:

PUBLIC MEETING: Consideration of a lot split. The property owners, Dr. Balbir C. Sharma and Sharda Sharma, Trustees of the Sharma Family Trust, are requesting approval of a lot split to divide a 2.4-acre parcel into two lots. After right-of-way dedication, each lot will be approximately 1.15 acres. The subject property is zoned R-43 for single-family homes on minimum one-acre lots and is located at 6912 E Horseshoe Road.

If you have questions, please call me at the Planning Department at (480) 348-3574.

Sincerely,

Paul Michaud, AICP
Senior Planner

The Town of Paradise Valley endeavors to make all public meetings accessible to persons with disabilities. With 72 hours advance notice, special assistance can be provided for disabled persons at public meetings. Please call 480-948-7411 (voice) or 483-1811 (TDD) to request accommodation.

For further information about any of these matters, please contact the Community Development Department, 6401 E. Lincoln Drive, Paradise Valley, Arizona, 480-348-3692.

All agendas are subject to change. Several items may be on an agenda. You may want to contact the Town or view the agenda online to check the order of the item you are interested in to estimate when it may be heard. You can generally view the agenda approximately 4-6 days prior to the meeting date at www.ci.paradise-valley.az.us/330/Agendas-and-Meetings. When you click on the individual underlined items on the agenda, a list of pdf files will appear on the right side of the screen. The staff action report and attachments will be listed separately for each agenda item.

Parcel Number	Owner Name	Mailing Address 1	Mailing Address City	Mailing Address	Property Street Number	Property Street Name	Property SI	Property City	Property Zip Code
174-30-001	SPIRO DANIEL S	6940 E SUNNYVALE RD	PARADISE VALLEY	85253	6940 E	SUNNYVALE	RD	PARADISE VALLEY	85253
174-30-002	WILLIAM B DANKWORTH AND JOY DANKWORTH	7002 E SUNNYVALE	PARADISE VALLEY	85253	7002 E	SUNNYVALE	RD	PARADISE VALLEY	85253
174-30-018	CHAUDHARY ARVIND K S	5833 VALLEY TRAIL	RACINE	58402	6939 E	SUNNYVALE	RD	PARADISE VALLEY	85253
174-30-027A	CARDANZ RV LLC	7000 E HORSESHOE RD	PARADISE VALLEY	85253	7000 E	HORSESHOE	RD	PARADISE VALLEY	85253
174-30-027B	LAVOIE E PATRICK/TABATHA A	7014 E HORSESHOE RD	PARADISE VALLEY	85253	7014 E	HORSESHOE	RD	PARADISE VALLEY	85253
174-30-029	GALE NESSA	7011 E DOUBLETREE RANCH RD	PARADISE VALLEY	85253	7011 E	DOUBLETREE RANCH	RD	PARADISE VALLEY	85253
174-30-030	CABRERA ORLANDO/SUSANA E TR	7007 E DOUBLETREE RANCH RD	PARADISE VALLEY	85253	7007 E	DOUBLETREE RANCH	RD	PARADISE VALLEY	85253
174-31-001	NEWBURG JEFFREY D/KENDA K	6802 E SUNNYVALE RD	PARADISE VALLEY	85253	6802 E	SUNNYVALE	RD	PARADISE VALLEY	85253
174-31-002	CLAY SCOTT C/FERIAL A	6816 E SUNNYVALE RD	PARADISE VALLEY	85253	6816 E	SUNNYVALE	RD	PARADISE VALLEY	85253
174-31-004	SMETANA JOHN L/PORTER CAROL M	6828 E SUNNYVALE RD	PARADISE VALLEY	85253000	6828 E	SUNNYVALE	RD	PARADISE VALLEY	85253
174-31-004	FINCH REAL ESTATE TRUST	101000 HURON DR	GRAND BEND	NOM 170	6840 E	SUNNYVALE	RD	PARADISE VALLEY	85253
174-31-005	RSD ARIZONA PACIFIC TRUST	PO BOX 368	VICTORIA	VBW 2N2	6852 E	SUNNYVALE	RD	PARADISE VALLEY	85253
174-31-006	NICOLAS AND MONICA ABELLES TRUST	12944 WOODBRIDGE ST	STUDIO CITY	91604	6902 E	SUNNYVALE	RD	PARADISE VALLEY	85253
174-31-007	GREGORY R AND VALERIE L EGGES FAMILY TRUST	6916 E SUNNYVALE RD	PARADISE VALLEY	85253	6916 E	SUNNYVALE	RD	PARADISE VALLEY	85253
174-31-008	TODD AND MICHELLE PARKER TRUST	6928 E SUNNYVALE RD	PARADISE VALLEY	85253	6928 E	SUNNYVALE	RD	PARADISE VALLEY	85253
174-31-009	CLARK CURTIS E/MARK L	5450 E VOLTAIRE	SCOTTSDALE	85254	6927 E	SUNNYVALE	RD	PARADISE VALLEY	85253
174-31-010	KALLNER MICHAEL T/KATHLEEN C TR	6915 E SUNNYVALE RD	PARADISE VALLEY	85253	6915 E	SUNNYVALE	RD	PARADISE VALLEY	85253
174-31-011	SHIPP FAMILY TRUST	6901 E SUNNYVALE RD	PARADISE VALLEY	85253	6901 E	SUNNYVALE	RD	PARADISE VALLEY	85253
174-31-012	YONOVER BRADLEY/SARAH	6651 E SUNNYVALE RD	PARADISE VALLEY	85253	6851 E	SUNNYVALE	RD	PARADISE VALLEY	85253
174-31-013	LINTON IAN M/JANE W TR	19204 N CATHEDRAL POINT CT	SURPRISE	85387	6839 E	SUNNYVALE	RD	PARADISE VALLEY	85253
174-31-014	NANCEE E VANDER PLUYM TRUST	6827 E SUNNYVALE RD	PARADISE VALLEY	85253	6827 E	SUNNYVALE	RD	PARADISE VALLEY	85253
174-31-014	MARCO VINCENZO DE/BENEDICT KELLY A	6815 E SUNNYVALE RD	PARADISE VALLEY	85253	6815 E	SUNNYVALE	RD	PARADISE VALLEY	85253
174-31-015	RATLIFF JOHN D JR/VICTORIA M TR	6810 E HORSESHOE RD	PARADISE VALLEY	85260	6821 E	HORSESHOE	RD	PARADISE VALLEY	85253
174-31-022A	MAKAWAO HOLDINGS LLC	13825 N NORTHSIGHT BLVD STE-120	SCOTTSDALE	85260	6821 E	DOUBLETREE RANCH	RD	PARADISE VALLEY	85253
174-31-022B	HAN FAMILY TRUST	1334 W SANDPIPER DR	GILBERT	85233	6833 E	DOUBLETREE RANCH	RD	PARADISE VALLEY	85253
174-31-023	SHARMA BALBIR C/SHARDA TR	17322 N 77TH ST	SCOTTSDALE	85255	6912 E	HORSESHOE	RD	PARADISE VALLEY	85253
174-31-026A	GLICKSTEIN STEVEN	6911 E DOUBLETREE RANCH RD	PARADISE VALLEY	85253	6911 E	DOUBLETREE RANCH	RD	PARADISE VALLEY	85253
174-31-026B	TEHRANCHI BABAK/BANIRIAH KATAYOUN TR	6927 E DOUBLETREE RANCH RD	PARADISE VALLEY	85253	6927 E	DOUBLETREE RANCH	RD	PARADISE VALLEY	85253
174-31-027	ROBINSON WILLIAM A	6933 E DOUBLETREE RANCH RD	PARADISE VALLEY	85253	6933 E	DOUBLETREE RANCH	RD	PARADISE VALLEY	85253
174-31-028	DUGAN MARTIN J JR/MCCREARY TIFFANY LYNN	6933 E DOUBLETREE RANCH RD	PARADISE VALLEY	85253	6933 E	DOUBLETREE RANCH	RD	PARADISE VALLEY	85253
174-31-029	NELSON WILLIAM J/PAOLA	6809 E DOUBLETREE RANCH RD	PARADISE VALLEY	85253	6809 E	DOUBLETREE RANCH	RD	PARADISE VALLEY	85253
174-31-030	BATES JAMES S/SEIKO M TR	6813 E DOUBLETREE RANCH RD	PARADISE VALLEY	85253	6813 E	DOUBLETREE RANCH	RD	PARADISE VALLEY	85253
174-31-031	BALDWIN DANIEL R/DAPHNE D	6710 N SCOTTSDALE RD NO 200	SCOTTSDALE	85253	6830 E	HORSESHOE	RD	PARADISE VALLEY	85253
174-31-032	CHEN XINYANG KEVIN/ZHAO HAIHONG HELEN	6840 E HORSESHOE BLVD	PARADISE VALLEY	85249	6840 E	HORSESHOE	RD	PARADISE VALLEY	85253
174-31-033	MCGNEICE HOLDINGS LLC	2007 E TEAKWOOD PL	CHANDLER	85249	6940 E	HORSESHOE	RD	PARADISE VALLEY	85253
174-31-034	DILLON REVOCABLE TRUST	6972 E HORSESHOE RD	PARADISE VALLEY	85253	6972 E	HORSESHOE	RD	PARADISE VALLEY	85253
175-61-011D	JONMAR INVESTMENTS	6814 E DOUBLETREE RD	SCOTTSDALE	85253	6814 E	DOUBLETREE RANCH	RD	PARADISE VALLEY	85253
175-61-017B	TSKALIDIS IAKOVOS/VERONICA	6940 E DOUBLETREE RANCH RD	PARADISE VALLEY	85253	6940 E	DOUBLETREE RANCH	RD	PARADISE VALLEY	85253
175-61-017D	SWETZER REVOCABLE TRUST	6970 E DOUBLETREE RANCH RD	PARADISE VALLEY	85253	6970 E	DOUBLETREE RANCH	RD	PARADISE VALLEY	85253
175-61-029F	DAY JOHN F/LINDA C TR	7000 E DOUBLETREE RANCH RD	SCOTTSDALE	80202	7010 E	DOUBLETREE RANCH	RD	PARADISE VALLEY	85253
175-61-068	MOUNTAIN STATES TELEPHONE & TELEGRAPH CO	1801 CALIFORNIA ST	DENVER	80202	6916 E	DOUBLETREE RANCH	RD	PARADISE VALLEY	85253
175-61-070	DOUBLETREE TRUST	6834 E DOUBLETREE RANCH RD	PARADISE VALLEY	85253	6834 E	DOUBLETREE RANCH	RD	PARADISE VALLEY	85253
175-61-071	ZAMANI PAYAM	1701 E COLTER ST NO 403	PHOENIX	85015	6824 E	DOUBLETREE RANCH	RD	PARADISE VALLEY	85253

maps.mtassessor.maricopa.gov/#

Assessor Paul D. Pfeiffer
Maricopa County Assessors Office

6942 F Horseshoe

Feature information

[1 of 1] Clear

174-31-023
Owner Information
 Owner Name: SHARMA BALBIR C/SHARDA TR
 Property Address: 8912 E HORSESHOE RD PARADISE VALLEY AZ 85255
 Mailing Address: 17522 N 77TH ST SCOTTSDALE AZ 85255
 Email Number: 040150071
 Sales Price: \$

Property Information
 Subdivision: 33 L66544 -111 531995
 Lot #/Long: 34 3N 4E
 Zoning: PARADISE VALLEY
 R-43
 Lot Size (sq Ft): 106,008
 MCR #:
 Subdivisor:
 Lot #: 1
 Floor: 1st
 Construction Year: 1959
 Living Space (sq Ft): 2,281

Valuation Information
 Tax Year: 2017
 Tax Value: 2016
 FOM: \$795,000
 LPM: \$720,198
 LPM: \$695,865



Search By

Features sale
 174-30
 174-30
 Owner
 Property
 Mailing

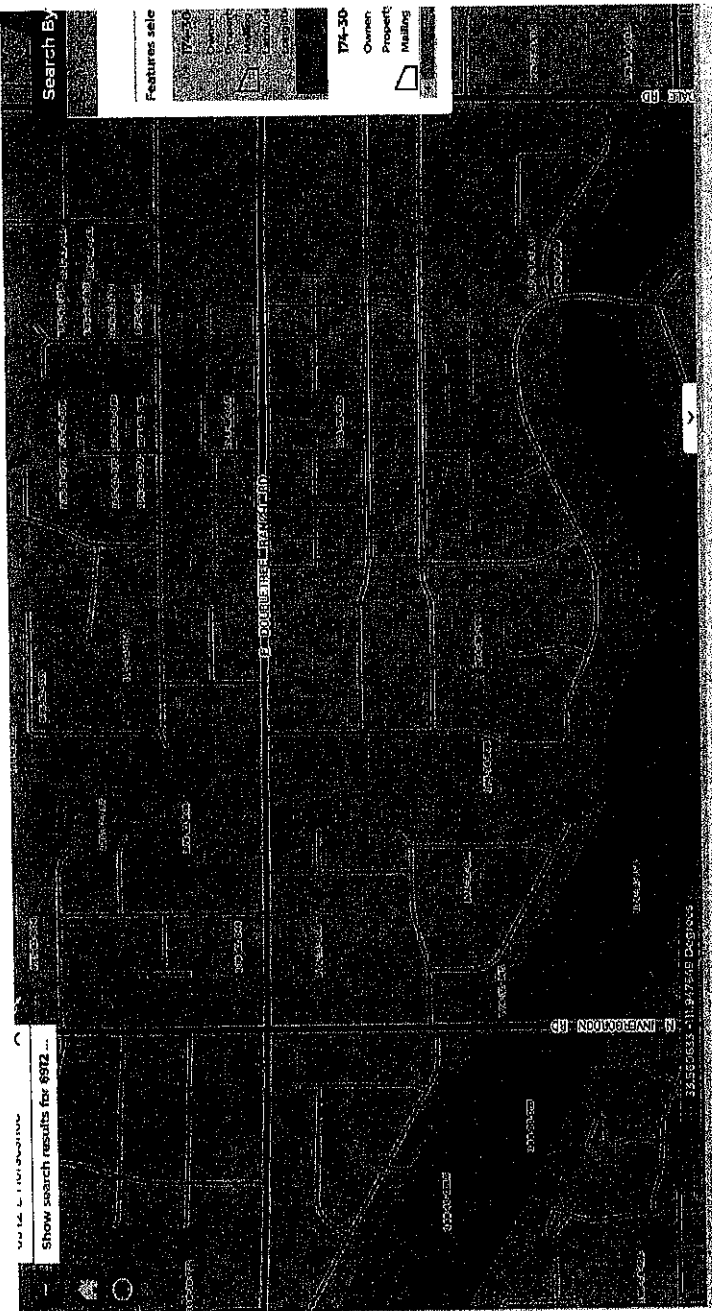

Search Results: Parcels X

APN	Floor	Parcel Name	Owner Name	Mailing Address	Mailing Address City	Mailing Address State	Mailing Address Zip	Property State Number	Property Section	Property Direction	Property Name	Sub
17430001	1	174-30-001	SPIRO DANIEL	6940 E GRANDDALE CITY	PARADISE	AZ	85253	6940	E		SUNNYVALE	RD

43 Features 0 selected